

ULTIMEA



Ultimea Poseidon M30

用户手册

1. 重要安全说明

- 请阅读并妥善保存本说明。请遵循所有警告提示，并按照说明进行操作。
- 请勿在靠近水源、潮湿环境或雨中使用本设备。避免将液体洒在设备上，或在设备上放置盛有液体的物品（如花瓶）。
- 仅可使用干布清洁。请勿使用液体清洁剂。
- 请勿堵塞通风口，也不要将设备安装在密闭空间内。请确保良好通风，并按照制造商的说明进行安装。
- 请勿将设备安装在散热器、炉具、功放或其他产生热量的设备附近。请勿用报纸、窗帘等物品覆盖通风口。
- 仅使用制造商指定的附件、支架或配件。使用带滚轮的设备时，移动过程中请小心，防止倾倒。
- 请保护电源线，避免被踩踏、夹压或弯折，尤其是在插头、插座以及电源线从设备引出处。
- 请勿改动插头的极性 or 接地结构。如插头无法插入插座，请联系专业电工更换插座。
- 雷雨天气或长时间不使用时，请拔下电源插头。
- 请勿在设备上放置任何明火源，如点燃的蜡烛。
- 请勿尝试拆开设备。内部存在高压电，可能导致触电或死亡。所有维修必须由专业人员进行。
- 设备的安装高度不得超过2米。

2. 配件清单

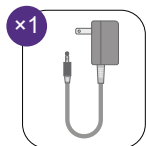

Soundbar 电源适配器
(1.5m / 59")

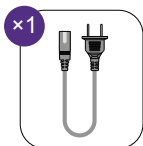

低音炮电源线
(1.5m / 59")

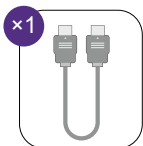

HDMI 线
(1.5m / 59")

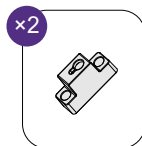

安装支架

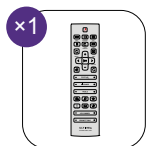

遥控器

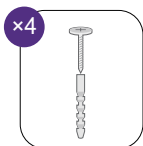

壁挂螺丝和膨胀管

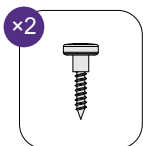

螺丝

3. Soundbar 控制说明

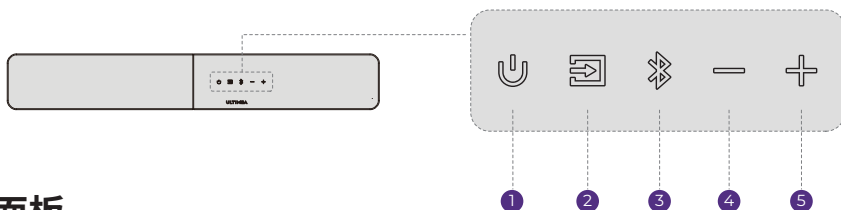

控制面板

- 1 “”: 电源键
按下开机或进入待机模式。
- 2 “”: 信号源
按下切换输入源：ARC - OPT (OPTICAL) - Bluetooth® - USB
- 3 “”: Bluetooth®
按下切换至Bluetooth®模式，Soundbar 将自动进入配对状态。长按 3 秒断开当前设备，并通过手机、电脑或电视手动配对新设备。
- 4 “”: 音量减
- 5 “”: 音量加

4. 遥控器

- 1 “”: 电源按钮
按下进入待机模式。
- 2 “”: ARC
按下切换至 HDMI ARC 通道。
- 3 “”: SOURCE
按下此按钮, 切换至 ARC-OPT-BT-USB 输入。
- 4 “”: OPT
按下切换至 OPTICAL 通道。
- 5 “”: Bluetooth®
按下切换至 Bluetooth® 通道。
- 6 “”: USB REPEAT
USB 模式: 按下可在单曲循环播放和列表循环播放之间切换。
- 7 “”: USB
按下切换至 USB 通道。
- 8 “”: EQ RESET
按下将所有 EQ 设置恢复为默认值。
- 9 “”: SUB PAIR
长按按钮 3 秒, 使 Soundbar 进入准备与低音炮配对的状态。
- 10 “+”: 音量加
- 11 “-”: 音量减
- 12 “<”: 上一曲
仅适用于 Bluetooth® 和 USB 模式: 跳至上一曲。
- 13 “>”: 下一曲
仅适用于 Bluetooth® 和 USB 模式: 跳至下一曲。
- 14 “”: 播放/暂停
仅适用于 Bluetooth® 和 USB 模式。
- 15 “”: MUTE
- 16 “”: DEVICE RESET
长按 5 秒重置设备。
- 17 “”: BASSMX
按下调节低音音量, 显示屏将显示: “B5-6”, “B5-5”, “B5-4”, “B5-3”, “B5-2”, “B5-1”, “B5 0”, “B5 1”, “B5 2”, “B5 3”, “B5 4”, “B5 5”, “B5 6”。
- 18 “MIDRANGE”: MIDRANGE
按下调节中音音量, 显示屏将显示: “MR-6”, “MR-5”, “MR-4”, “MR-3”, “MR-2”, “MR-1”, “MR 0”, “MR 1”, “MR 2”, “MR 3”, “MR 4”, “MR 5”, “MR 6”。
- 19 “TREBLE”: TREBLE
按下调节高音音量, 显示屏将显示: “T3-6”, “T3-5”, “T3-4”, “T3-3”, “T3-2”, “T3-1”, “T3 0”, “T3 1”, “T3 2”, “T3 3”, “T3 4”, “T3 5”, “T3 6”。
- 20 “”: MOVIE
按下切换至 MOVIE 模式, 显示屏将显示: “MOVI”。
- 21 “”: MUSIC
按下切换至 MUSIC 模式, 显示屏将显示: “MUSC”。
- 22 “”: VOICE
按下切换至 VOICE 模式, 显示屏将显示: “VOIC”。
- 23 “”: SPORT
按下切换至 SPORT 模式, 显示屏将显示: “SPRT”。
- 24 “”: GAME
按下切换至 GAME 模式, 显示屏将显示: “GAME”。
- 25 “”: NIGHT
按下切换至 NIGHT 模式, 显示屏将显示: “NIGT”。

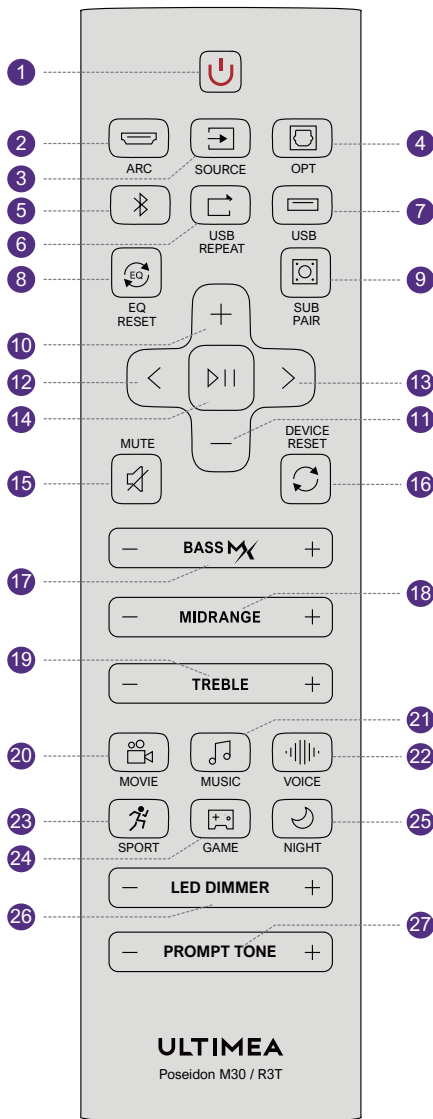

- 26 “LED DIMMER”: LED DIMMER
按下可在 5 个等级中调节显示屏亮度。
长按 3 秒关闭 LED 显示屏。
- 27 “PROMPT TONE”: PROMPT TONE
按下调节提示音量, 显示屏将显示: “PT 0”, “PT 1”, “PT 2”, “PT 3”。

5. Soundbar 安装

对齐两个部件的接缝，然后将其旋转连接，直至牢固固定。

注意：组装过程中，请确保 Soundbar 已关闭电源。

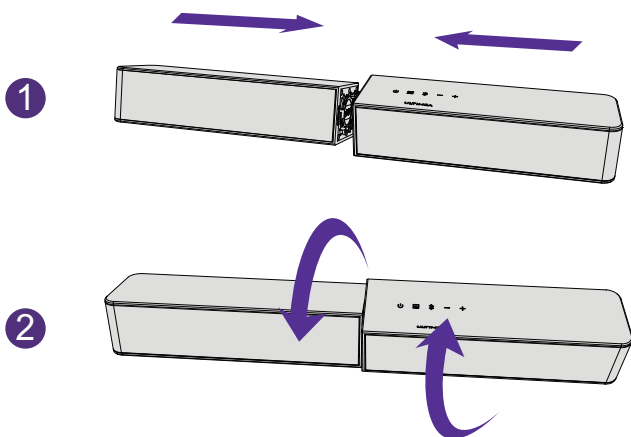

6. 后面板

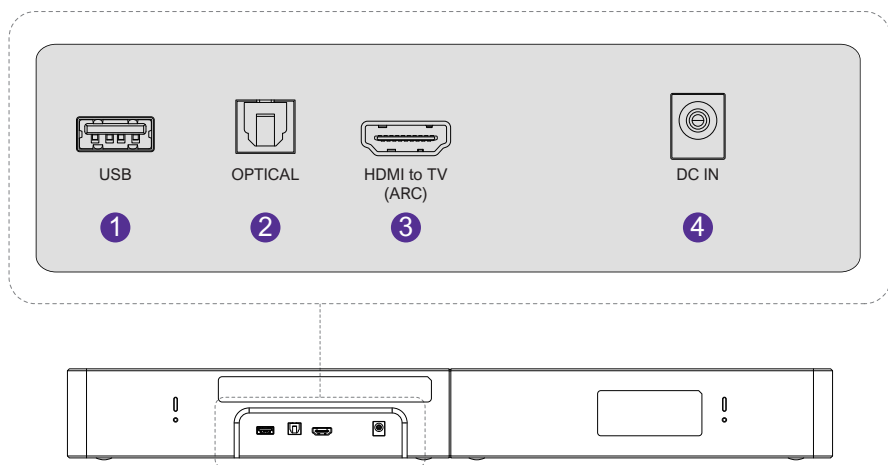

注意：USB 支持 MP3 或 FLAC 文件。

7. 系统摆放

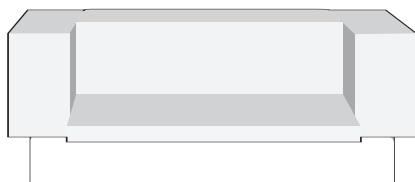
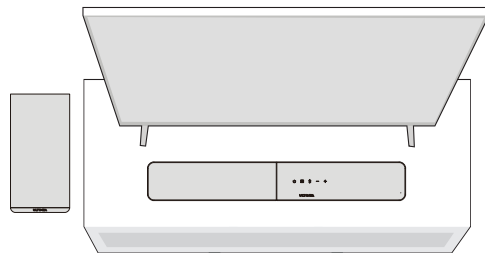

8. 壁挂安装

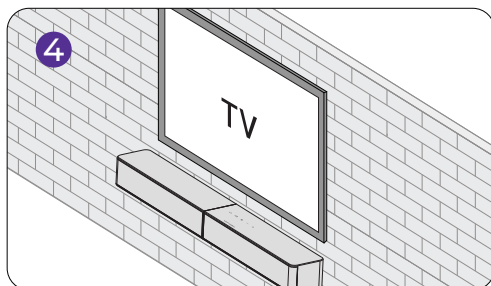
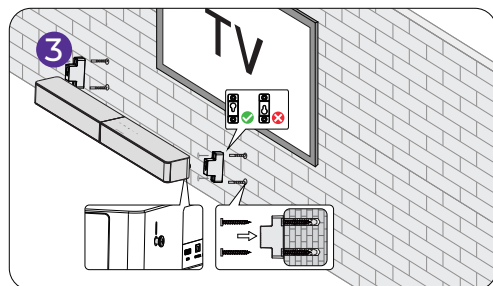
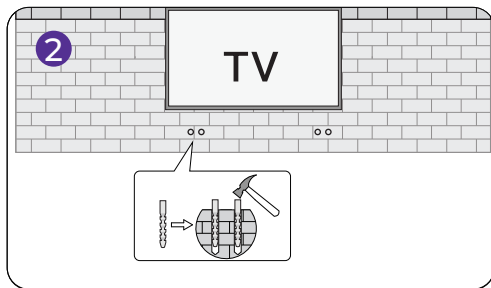
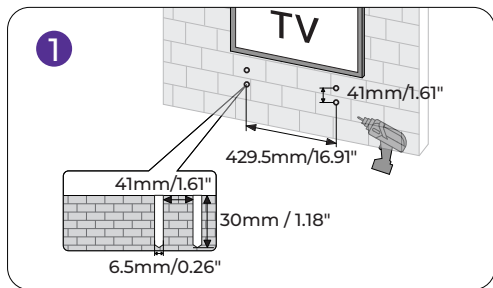

9. 连接并开机

- 1 将 Soundbar 电源适配器插入墙壁插座。

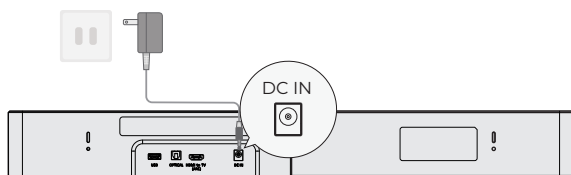

- 2 将低音炮电源线插入电源插座。

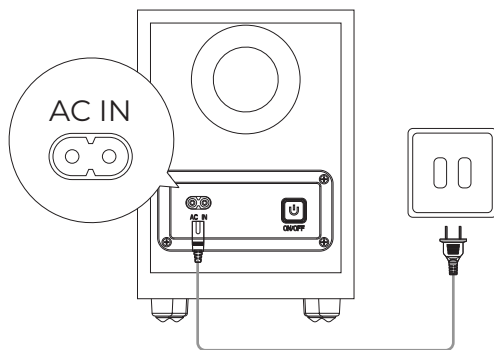

- 3 注意：建议使用一次性碱性电池。不建议使用充电电池。

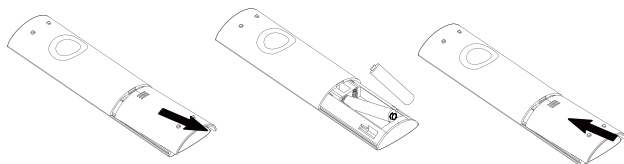

电池不包含在内。

10. 通过 HDMI ARC 连接电视

- 1 将 HDMI 线的一端连接到电视背面的 ARC 端口。
- 2 将另一端连接到回音壁的 ARC 端口。

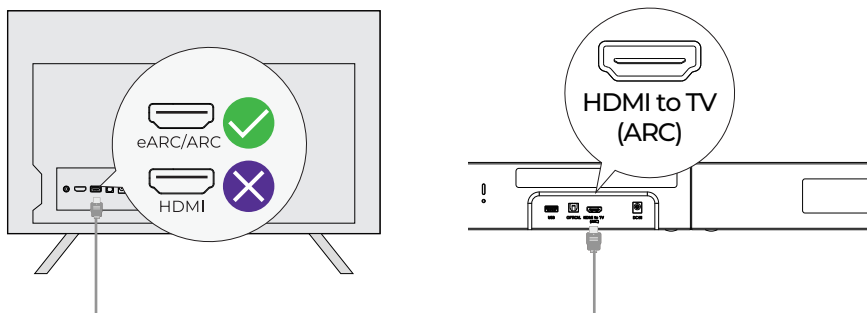

- 3 按下遥控器上的“Source”按键，选择“ARC”输入源。

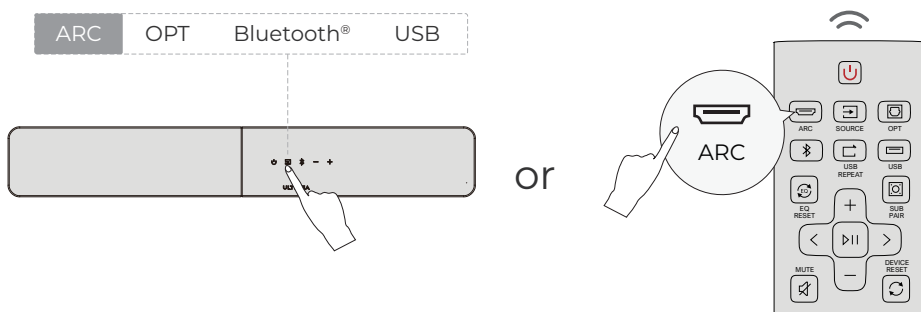

如果没有声音，请尝试将电视音频输出设置为 PCM：电视设置 > 主页 > 设置 > 声音 > 数字音频输出 > PCM

HDMI ARC 支持通过一根 HDMI 线在电视和音频系统之间进行双向音频传输。

注意：请启用电视上的“CEC”功能。

连接 ARC 后，电视遥控器可以同时控制 Soundbar 和电视：1 开机/关机 2 调节音量

11. 通过光纤线连接电视

- 1 请确认电视接口为 OPTICAL OUT，并将光纤线两端分别连接至电视和音箱的 OPTICAL 接口。

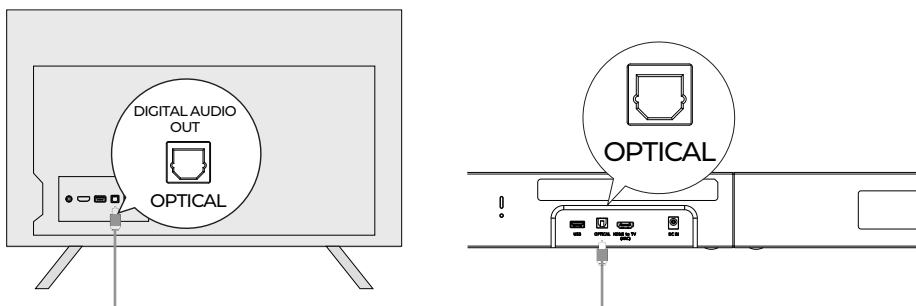

- 2 请确认光纤插头按照图示正确插入。请勿倒置插入，以免损坏光纤接口。

- 3 电视设置 > 主页 > 设置 > 声音 > 数字音频输出 > PCM

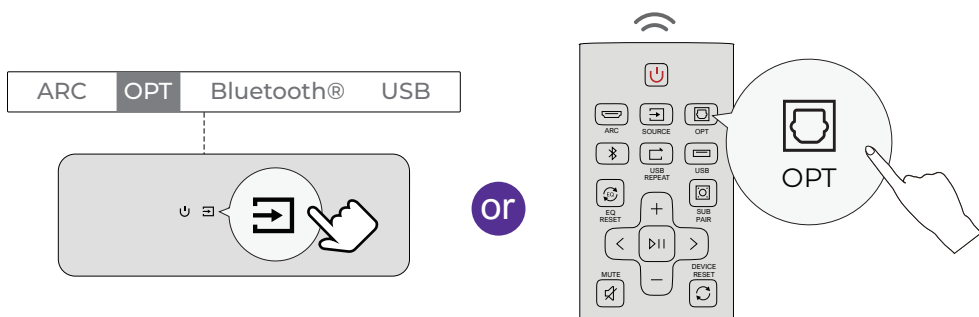

注意：如果声音仍从电视内置扬声器播放，请将电视静音或将音量调至最低。

12. 连接Bluetooth®

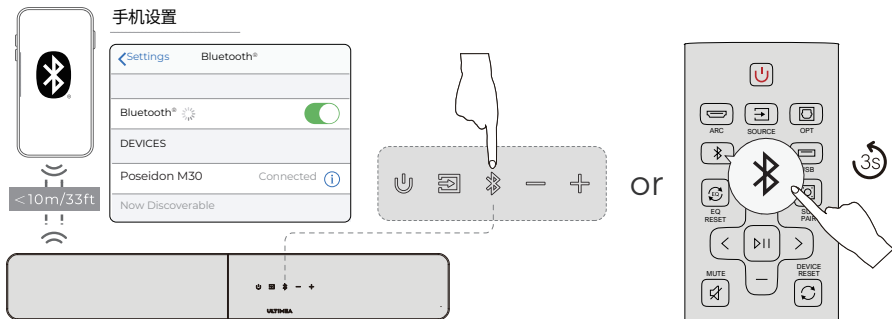

- 1 按下音箱上的 "Bluetooth" 按钮，或按下遥控器上的 "Bluetooth" 按钮进入Bluetooth®配对模式
- 2 打开手机Bluetooth®设置，找到并选择 "Poseidon M30" 以连接音箱
- 3 注意：如果已处于Bluetooth®模式并已连接，请长按 "Bluetooth" 按钮3秒断开当前设备，然后在手机/PC/电视上手动选择新的设备进行连接

13. 重新配对低音炮

通常情况下，音箱与低音炮已在出厂时完成配对。如连接断开，请按照以下步骤重新配对：

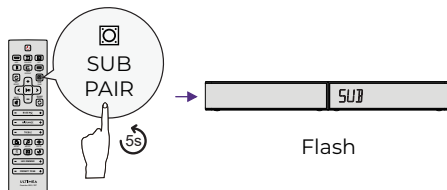

- 1 长按遥控器上的“SUB PAIR”按钮5秒。主机显示屏将闪烁“SUB”，表示已进入配对模式。

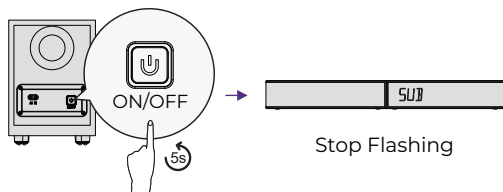

- 2 长按低音炮背面的 ON/OFF 按钮5秒，进入配对模式
- 3 配对成功后，主机显示屏将停止闪烁，低音炮指示灯将保持常亮

14. 恢复出厂设置

长按 DEVICE RESET 按钮
5 秒以恢复出厂设置。

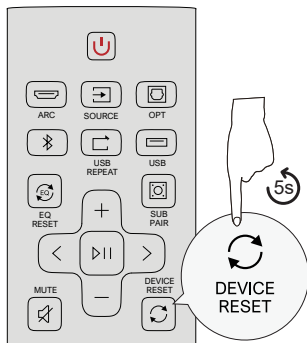

15. 调整提示音音量

如果您觉得Soundbar的提示音过大，可以通过ULTIMEA App调整音量。

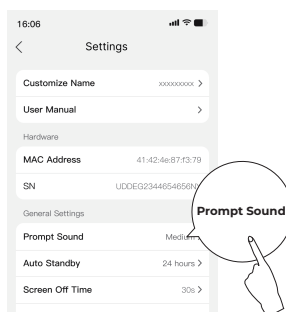
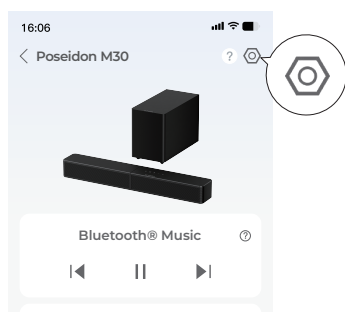

- 1 扫描二维码下载ULTIMEA App，然后在App中添加您的Soundbar。
- 2 打开Soundbar的设备详情页面，点击右上角的设置图标，选择“Prompt Sound Volume”，根据需要调整音量。

Model Number	UC000
Power Supply	18V 2A DC(Soundbar); 100-240V~50/60Hz AC (Subwoofer)
Soundbar Drivers	Soundbar: 2.25" × 2, Subwoofer: 5.25"
Auto Standby	The soundbar will turn to standby mode if there is no audio signal for 15 minutes. You can set the standby time in the App
Standby Power	<0.5W
Operating Temperature	-10°C – 45°C / 14°F – 113°F
Bluetooth® Version	6.0

Soundbar	600 × 70 × 90 mm / 23.6" × 2.8" × 3.5"
Subwoofer	300 × 200 × 150 mm / 11.8" × 7.9" × 5.9"
Packaging	335 × 437 × 197 mm / 13.2" × 17.2" × 7.8"
Packaging Weight	5.8 kg / 12.8 lbs

USB Output	5V 500mA DC
Operating Altitude	2000 meters above sea level
Wall Mount Screw	4 × 35 mm / 0.2" × 1.4"
Bracket Screws Diameter	3 mm / 0.12"
Remote Control Battery Type	2 × AAA (NOT INCLUDED)
Notice: Risk of fire or explosion if the battery is replaced by an incorrect type.	

PROPER DISPOSAL INSTRUCTIONS



This mark shown on the product or its packaging, indicates that this product should not be disposed of with other household waste at the end of its working life. To prevent possible harm to the environment or human health from uncontrolled waste disposal, please separate this from other types of wastes and recycle it responsibly to promote the sustainable reuse of material resources.

WASTE ELECTRICAL & ELECTRONIC EQUIPMENT

Household user should contact either the retailer where they purchased this product, or their local government office, for details of where and how they can take this item for environmentally safe recycling. Business users should contact their suppliers and check the terms and conditions of the purchase contract. This product should not be mixed with other commercial wastes for disposal.

WIRELESS FREQUENCY RANGE AND WIRELESS OUTPUT POWER:

Frequency: 2.402GHz-2.48GHz

The Max. transmit power (Applies only to the EU): 10 dBm

FCC REGULATORY COMPLIANCE

Any changes or modifications not expressly approved by the party responsible for compliance could void the user's authority to operate the equipment.

This device complies with Part 15 of the FCC Rules.

Operation is subject to the following two conditions:

(1) This device may not cause harmful interference.

(2) This device must accept any interference received, including interference that may cause undesired operation.

NOTE: This equipment has been tested and found to comply with the limits for a Class B digital device, pursuant to part 15 of the FCC Rules. These limits are designed to provide reasonable protection against harmful interference in a residential installation. This equipment generates, uses, and can radiate radio frequency energy, and if not installed and used in accordance with the instructions, may cause harmful interference to radio communications.

However, there is no guarantee that interference will not occur in a particular installation. If this equipment does cause harmful interference to radio or television reception, which can be determined by turning the equipment off and on, the user is encouraged to try to correct the interference by one or more of the following measures:

- Reorient or relocate the receiving antenna.

- Increase the separation between the equipment and the receiver.

- Connect the equipment to an outlet on a circuit different from that to which the receiver is connected.

- Consult the dealer or an experienced radio / TV technician for help.

This equipment complies with FCC radiation exposure limits set forth for an uncontrolled environment. This equipment should be installed and operated with a minimum distance of 20cm between the radiator & your body. This transmitter must not be co-located or operating in conjunction with any other antenna or transmitter.

CE WARNINGS

(1) Do not install this equipment in a confined or building-in space such as a book case or similar unit, and remain a well ventilation conditions. The ventilation should not be impeded by covering the ventilation openings with items such as newspaper, table-cloths, curtains etc.

(2) WARNING: To reduce the risk of fire or electric shock, do not expose this apparatus to rain or moisture. The apparatus shall not be exposed to dripping or splashing and that objects filled with liquids, such as vases, shall not be placed on apparatus.

(3) WARNING: The adapter plug is used as disconnect device, the disconnect device shall remain readily operable.

(4) Frequency: 2.402GHz-2.48GHz

(5) The Max. transmit power: 10 dBm

 WARNING: This product can expose you to chemicals including lead, which is known to the State of California to cause cancer and birth defects or other reproductive harm. For more information, go to www.P65Warnings.ca.gov.

ISED WARNINGS

This device contains licence-exempt transmitter(s)/receiver(s) that comply with Innovation, Science and Economic Development Canada's licence-exempt RSS(s). Operation is subject to the following two conditions:

(1) This device may not cause interference.

(2) This device must accept any interference, including interference that may cause undesired operation of the device.

L'émetteur/récepteur exempt de licence contenu dans le présent appareil est conforme aux

CNR d'Innovation, Sciences et Développement économique Canada applicables aux appareils radio exempts de licence. L'exploitation est autorisée aux deux conditions suivantes :

1) L'appareil ne doit pas produire de brouillage;

2) L'appareil doit accepter tout brouillage radioélectrique subi, même si le brouillage est susceptible d'en compromettre le fonctionnement.

3) The device meets the exemption from the routine evaluation limits in issue6 of RSS 102 and compliance with RSS-102 RF exposure, users can obtain Canadian information on RF exposure and compliance.

Le dispositif rencontre l'exemption des limites courantes d'évaluation dans la numéro 6 de RSS 102 et la conformité à l'exposition de RSS-102 rf, utilisateurs peut obtenir l'information canadienne sur l'exposition et la conformité de rf.

This transmitter must not be co-located or operating in conjunction with any other antenna or transmitter. This equipment should be installed and operated with a minimum distance of 20 centimeters between the radiator and your body.

Cet émetteur ne doit pas être Co-placé ou ne fonctionnant en même temps qu'aucune autre antenne ou émetteur. Cet équipement devrait être installé et actionné avec une distance minimum de 20 centimètres entre le radiateur et votre corps.

Wireless Capability Description:

The subwoofer in the system is designed for wired connection and does not have the ability to transmit or receive wireless signals.

The remote control uses infrared (IR) technology for device control and does not support any other wireless signal transmission or reception capabilities.

 **CA WARNING:** Can expose you to BPA, a carcinogen, and BPA, a reproductive. toxicant. See www.P65Warnings.ca.gov.

ULTIMEA

Product Name: Soundbar
Model No.: UC000
Soundbar HVIN: UC000
Subwoofer HVIN: UC000B

 Ultimea GmbH
Buchenring 57, 22359 Hamburg, Germany

 EVATOST CONSULTING LTD
Office 101 32 Threadneedle Street, London, United Kingdom, EC2R 8AY

@Ultimea Inc. All rights reserved, registered in the United States and other countries. 801 S. Dupont Ave., Ste G, Ontario, CA, 91761, USA

Made in China
Manufacturer: Ultimea Technology (Shenzhen) Limited
Address: 20th Floor, Building 4, Tianan Cloud Park, Bantian St., Longgang District, Shenzhen, China 518000

Manufacturer Contact Information:

 +1 888-598-8875 (US)
Mon-Fri 9am-5pm (PST)  +49 89-628-25828 (EU)
Mon-Fri 9am-5pm (CET)  support@ultimea.com  support.ultimea.com

If you need our support, kindly reach out to our service team. We are always glad to help.



Soundbar MIC ID: Subwoofer MIC ID:

 # 219-258296  # 219-258295  Shen Zhen Shi Xin Fei Yi
Ke Ji You Xian Gong Si



Warranty Extension Plan

EU DECLARATION OF CONFORMITY

We (Manufacturer is responsible for this declaration) Ultimea Technology (Shenzhen) Limited
20th Floor, Building 4, Tianan Cloud Park, Bantian St., Longgang District Shenzhen, China 518000
Declare under our sole responsibility that the product
Trade Mark: ULTIMEA
Product Name: Soundbar
Model No.: UC000

The product to which this declaration relates is in conformity with the essential requirements set out in the Council Directive on the Approximation of the laws of the Member States relating to the Radio Equipment Directive (2014/53/EU), the Restriction of Hazardous Substances Directive (2011/65/EU), the Electromagnetic Compatibility Directive (2014/30/EU), and the Low Voltage Directive (2014/35/EU). The product is responsible for affixing the CE marking, and the following standards were applied:

EN 55032:2015/A1:2020	ETSI EN 301 489-1 V2.2.3 (2019-11)	Full Name: Yoyo.Yu
EN 55035:2017/A1:2020	ETSI EN 301 489-17 V3.2.4 (2020-09)	Position: Approval Manager
EN IEC 61000-3-2:2019/A2:2024	ETSI EN 300 328 V2.2.2 (2019-07)	Signature: 
EN 61000-3-3:2013/A2:2021	EN IEC 62311:2020	Place/Date: Shenzhen, China / Feb. 01-2026
	EN IEC 62368-1:2020+A1:2020	

Trade Marks:



The Bluetooth® word mark and logos are registered trademarks owned by Bluetooth SIG, Inc. and any use of such marks by Ultimea Technology (Shenzhen) Limited, is under license. Other trademarks and trade names are those of their respective owners.



The terms HDMI, HDMI High-Definition Multimedia Interface, HDMI trade dress and the HDMI Logos are trademarks or registered trademarks of HDMI Licensing Administrator, Inc.