

ULTIMEA



Utimea Poseidon M30

# 使用手冊

## 1. 重要安全說明

- 請閱讀並妥善保存本說明。請遵循所有警告提示，並依照說明操作。
- 請勿在靠近水源、潮濕環境或雨中使用本設備。避免將液體灑在設備上，或放置盛有液體的物品（如花瓶）。
- 僅可使用乾布清潔。請勿使用液體清潔劑。
- 請勿堵塞通風孔，亦不可將設備安裝於密閉空間。請確保良好通風，並依照製造商說明安裝。
- 請勿將設備安裝於散熱器、爐具、擴大機或其他產生熱量的設備附近。請勿以報紙、窗簾等物品覆蓋通風孔。
- 僅使用製造商指定之附件或配件。使用帶輪設備移動時，請小心避免傾倒。
- 請保護電源線，避免踩踏、夾壓或彎折，特別是在插頭與設備連接處。
- 請勿改動插頭之極性或接地功能。如插頭無法插入插座，請諮詢電工更換插座。
- 雷雨期間或長時間不使用時，請拔除電源插頭。  
請勿在設備上放置任何明火，如點燃的蠟燭。
- 請勿嘗試拆解設備。內部高電壓可能導致觸電或死亡。  
維修必須由專業人員進行。
- 安裝高度不得超過2公尺。

## 2. 配件清單

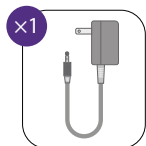

Soundbar 電源適配器  
(1.5m / 59")

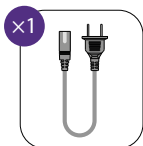

重低音喇叭電源線  
(1.5m / 59")

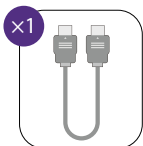

HDMI 線  
(1.5m / 59")

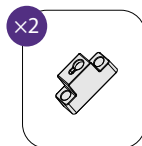

安裝支架

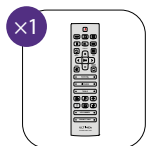

遙控器

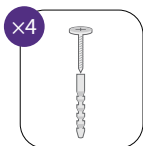

壁掛螺絲

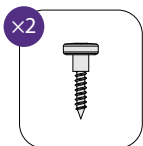

螺絲

## 3. Soundbar 控制說明

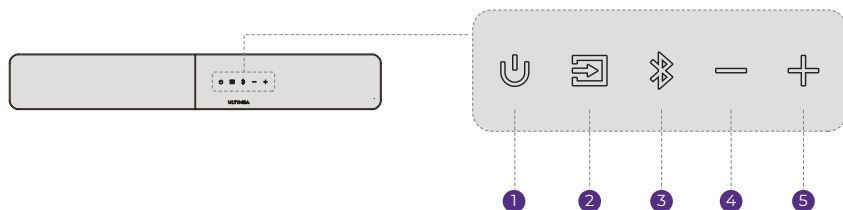

### 控制面板

- 1 “”: 電源鍵  
按下開機或進入待機模式。
- 2 “”: 訊號源  
按下切換輸入來源: ARC - OPT (OPTICAL) - Bluetooth® - USB。
- 3 “”: Bluetooth®  
按下切換至 Bluetooth® 模式, Soundbar 將自動進入配對模式。長按 3 秒可中斷目前裝置連線, 並透過手機、電腦或電視手動配對新裝置。
- 4 “”: 音量降低
- 5 “”: 音量增加

## 4. 遙控器

- 1 “

- 26 “LED DIMMER”：LED DIMMER  
按下可在 5 個等級中調節顯示螢幕亮度。  
長按 3 秒關閉 LED 顯示螢幕。
- 27 “PROMPT TONE”：PROMPT TONE  
按下調節提示音音量，顯示螢幕將顯示：“PT 0”，“PT 1”，“PT 2”，“PT 3”。

## 5. Soundbar 安裝

對齊兩個部件的接縫，然後將其旋轉連接，直到牢固固定。

注意：組裝過程中，請確保 Soundbar 已關閉電源。

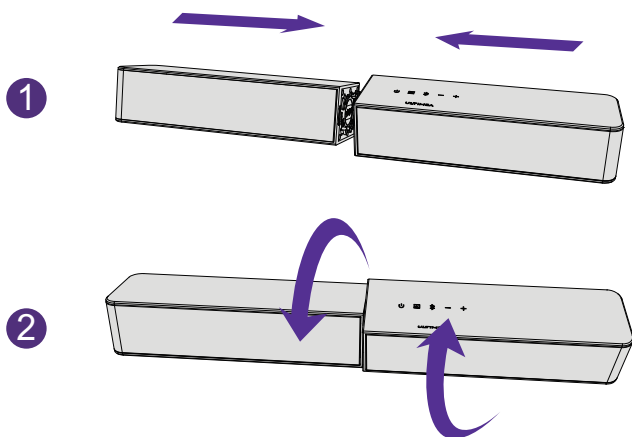

## 6. 后面板

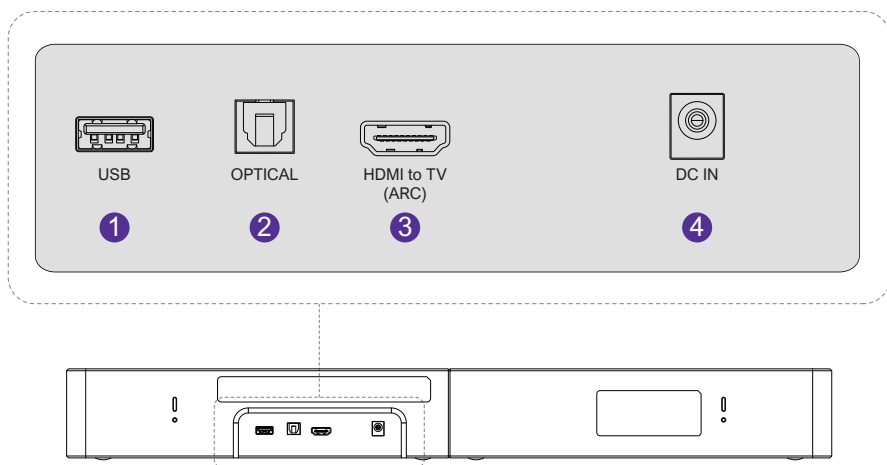

注意：USB 支援 MP3 或 FLAC 檔案。

## 7. 系統擺放

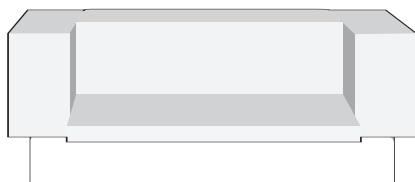
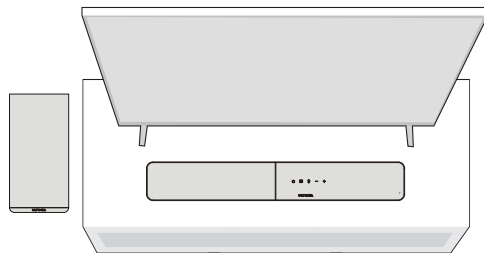

## 8. 壁掛安裝

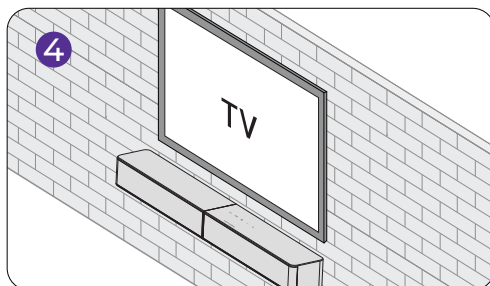
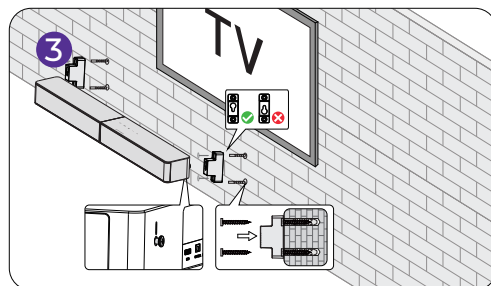
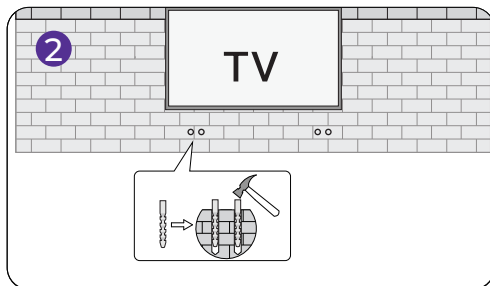
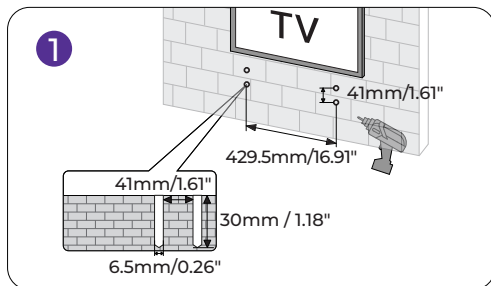

## 9. 連接並開機

- 1 將 Soundbar 電源適配器插入牆壁插座。

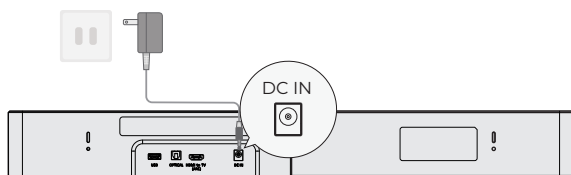

- 2 將重低音喇叭電源線插入牆壁插座。

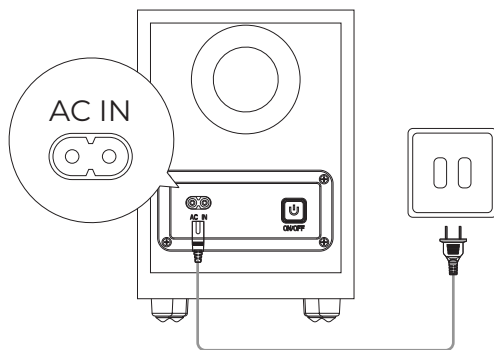

- 3 注意：建議使用一次性鹼性電池。不建議使用充電電池。

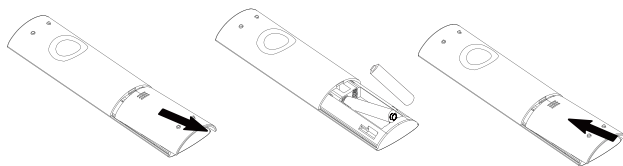

電池不包含在內。

## 10. 透過 HDMI ARC 連接電視

- 1 將 HDMI 線一端連接至電視背面的 ARC 連接埠。
- 2 將另一端連接至 Soundbar 的 ARC 連接埠。

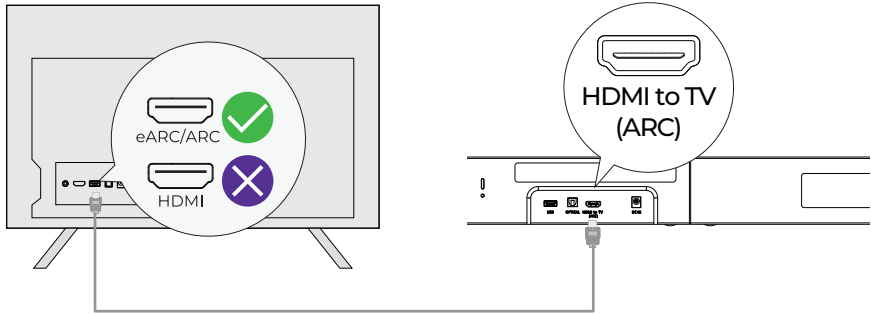

- 3 按下遙控器上的「Source」按鍵，選擇「ARC」輸入來源。

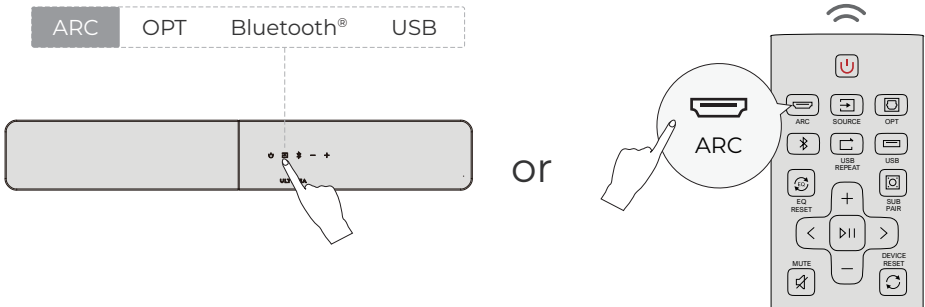

如果沒有聲音，請嘗試將電視音訊輸出設定為 PCM：電視設定 > 首頁 > 設定 > 聲音 > 數位音訊輸出 > PCM

**HDMI ARC** 支援透過一條 **HDMI** 線在電視和音訊系統之間進行雙向音訊傳輸。

注意：請啟用電視上的「CEC」功能。連接 ARC 後，電視遙控器可以同時控制 Soundbar 和電視：1 開機/關機 2 調節音量

## 11. 透過光纖線連接電視

- 1 請確保電視連接埠為 OPTICAL OUT。將光纖線的兩端分別連接到電視和 Soundbar 的 OPTICAL 連接埠。

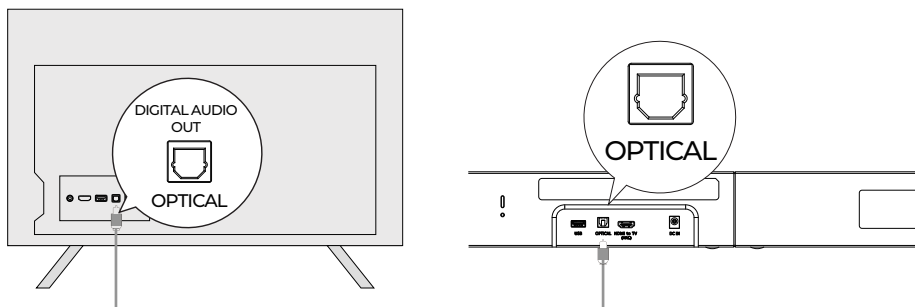

- 2 請確保光纖插頭依照圖示正確插入。請勿倒置插入，否則可能會損壞光纖連接埠。
- 3 電視設定 > 首頁 > 設定 > 聲音 > 數位音訊輸出 > PCM

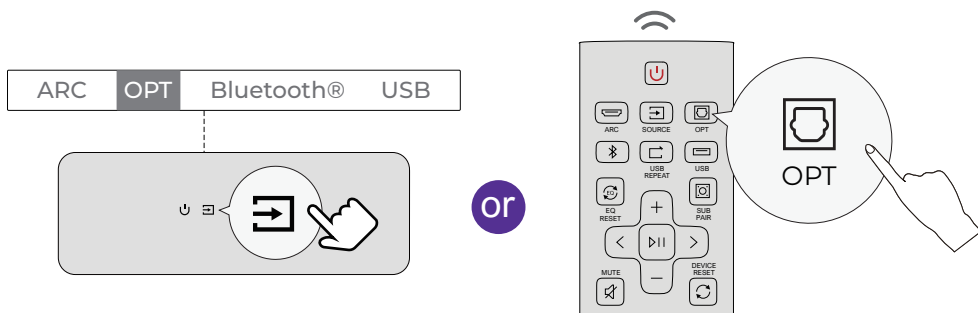

注意：如果電視內建喇叭正在播放音訊，請將電視靜音或將音量調至最低。

## 12. 連接Bluetooth®

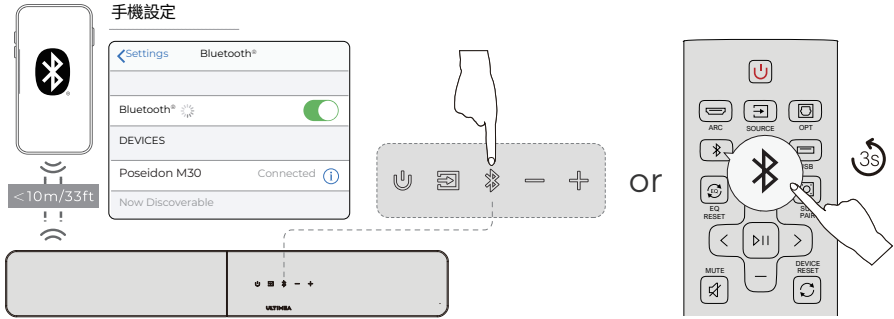

- 1 按下音響上的 "Bluetooth" 按鈕，或按下遙控器上的 "Bluetooth" 按鈕進入Bluetooth® 配對模式
- 2 開啟手機Bluetooth®設定，找到並選擇 "Poseidon M30" 以連接音響
- 3 注意：若已處於Bluetooth®模式且已連接，請長按 "Bluetooth" 按鈕3秒以中斷目前裝置，然後在手機 / PC / 電視上手動選擇新的裝置進行連接

## 13. 重新配對重低音

通常情況下，音響與重低音已在出廠時完成配對。如連線中斷，請依照以下步驟重新配對：

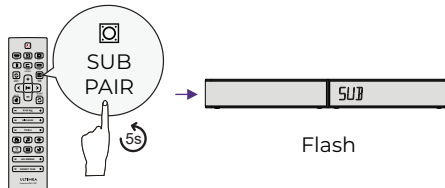

- 1 長按遙控器上的「SUB PAIR」按鈕5秒。主機顯示螢幕將閃爍「SUB」，表示已進入配對模式。

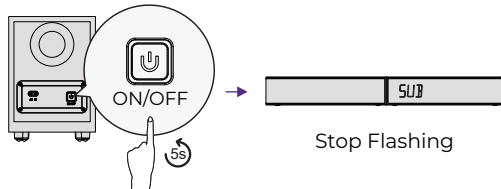

- 2 長按重低音喇叭背面的 ON/OFF 按鈕5秒，進入配對模式。
- 3 配對成功後，主機顯示幕將停止閃爍，重低音指示燈將保持常亮

## 14. 恢復出廠設定

長按 **DEVICE RESET** 按鈕 5 秒以恢復出廠設定。

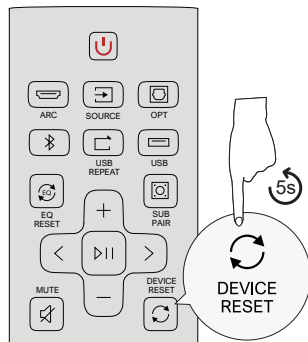

## 15. 調整提示音音量

如果您覺得Soundbar的提示音過大，可以透過**ULTIMEA App**調整音量。

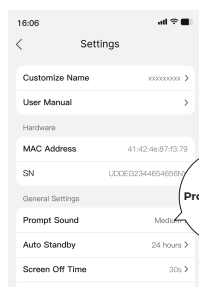
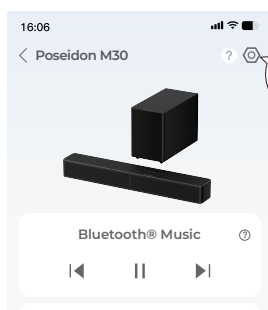

- 1 掃描QR碼下載**ULTIMEA App**，然後在App中新增您的Soundbar。
- 2 開啟Soundbar的裝置詳細頁面，點擊右上角的設定圖示，選擇「**Prompt Sound Volume**」，並依需求調整音量。

<b>Model Number</b>	UC000
<b>Power Supply</b>	18V 2A DC(Soundbar); 100-240V~50/60Hz AC (Subwoofer)
<b>Soundbar Drivers</b>	Soundbar: 2.25" × 2, Subwoofer: 5.25"
<b>Auto Standby</b>	The soundbar will turn to standby mode if there is no audio signal for 15 minutes. You can set the standby time in the App
<b>Standby Power</b>	<0.5W
<b>Operating Temperature</b>	-10°C – 45°C / 14°F – 113°F
<b>Bluetooth® Version</b>	6.0

<b>Soundbar</b>	600 × 70 × 90 mm / 23.6" × 2.8" × 3.5"
<b>Subwoofer</b>	300 × 200 × 150 mm / 11.8" × 7.9" × 5.9"
<b>Packaging</b>	335 × 437 × 197 mm / 13.2" × 17.2" × 7.8"
<b>Packaging Weight</b>	5.8 kg / 12.8 lbs

<b>USB Output</b>	5V 500mA DC
<b>Operating Altitude</b>	2000 meters above sea level
<b>Wall Mount Screw</b>	4 × 35 mm / 0.2" × 1.4"
<b>Bracket Screws Diameter</b>	3 mm / 0.12"
<b>Remote Control Battery Type</b>	2 × AAA (NOT INCLUDED)
Notice: Risk of fire or explosion if the battery is replaced by an incorrect type.	

## PROPER DISPOSAL INSTRUCTIONS



This mark shown on the product or its packaging, indicates that this product should not be disposed of with other household waste at the end of its working life. To prevent possible harm to the environment or human health from uncontrolled waste disposal, please separate this from other types of wastes and recycle it responsibly to promote the sustainable reuse of material resources.

## WASTE ELECTRICAL & ELECTRONIC EQUIPMENT

Household user should contact either the retailer where they purchased this product, or their local government office, for details of where and how they can take this item for environmentally safe recycling. Business users should contact their suppliers and check the terms and conditions of the purchase contract. This product should not be mixed with other commercial wastes for disposal.

## WIRELESS FREQUENCY RANGE AND WIRELESS OUTPUT POWER:

Frequency: 2.402GHz-2.48GHz

The Max. transmit power (Applies only to the EU): 10 dBm

## FCC REGULATORY COMPLIANCE

Any changes or modifications not expressly approved by the party responsible for compliance could void the user's authority to operate the equipment.

This device complies with Part 15 of the FCC Rules.

Operation is subject to the following two conditions:

(1) This device may not cause harmful interference.

(2) This device must accept any interference received, including interference that may cause undesired operation.

NOTE: This equipment has been tested and found to comply with the limits for a Class B digital device, pursuant to part 15 of the FCC Rules. These limits are designed to provide reasonable protection against harmful interference in a residential installation. This equipment generates, uses, and can radiate radio frequency energy, and if not installed and used in accordance with the instructions, may cause harmful interference to radio communications.

However, there is no guarantee that interference will not occur in a particular installation. If this equipment does cause harmful interference to radio or television reception, which can be determined by turning the equipment off and on, the user is encouraged to try to correct the interference by one or more of the following measures:

- Reorient or relocate the receiving antenna.

- Increase the separation between the equipment and the receiver.

- Connect the equipment to an outlet on a circuit different from that to which the receiver is connected.

- Consult the dealer or an experienced radio / TV technician for help.

This equipment complies with FCC radiation exposure limits set forth for an uncontrolled environment. This equipment should be installed and operated with a minimum distance of 20cm between the radiator & your body. This transmitter must not be co-located or operating in conjunction with any other antenna or transmitter.

## CE WARNINGS

(1) Do not install this equipment in a confined or building-in space such as a book case or similar unit, and remain a well ventilation conditions. The ventilation should not be impeded by covering the ventilation openings with items such as newspaper, table-cloths, curtains etc.

(2) WARNING: To reduce the risk of fire or electric shock, do not expose this apparatus to rain or moisture. The apparatus shall not be exposed to dripping or splashing and that objects filled with liquids, such as vases, shall not be placed on apparatus.

(3) WARNING: The adapter plug is used as disconnect device, the disconnect device shall remain readily operable.

(4) Frequency: 2.402GHz-2.48GHz

(5) The Max. transmit power: 10 dBm

 WARNING: This product can expose you to chemicals including lead, which is known to the State of California to cause cancer and birth defects or other reproductive harm. For more information, go to [www.P65Warnings.ca.gov](http://www.P65Warnings.ca.gov).

## ISED WARNINGS

This device contains licence-exempt transmitter(s)/receiver(s) that comply with Innovation, Science and Economic Development Canada's licence-exempt RSS(s). Operation is subject to the following two conditions:

(1) This device may not cause interference.

(2) This device must accept any interference, including interference that may cause undesired operation of the device.

L'émetteur/récepteur exempt de licence contenu dans le présent appareil est conforme aux

CNR d'Innovation, Sciences et Développement économique Canada applicables aux appareils radio exempts de licence. L'exploitation est autorisée aux deux conditions suivantes :

1) L'appareil ne doit pas produire de brouillage;

2) L'appareil doit accepter tout brouillage radioélectrique subi, même si le brouillage est susceptible d'en compromettre le fonctionnement.

3) The device meets the exemption from the routine evaluation limits in issue6 of RSS 102 and compliance with RSS-102 RF exposure, users can obtain Canadian information on RF exposure and compliance.

Le dispositif rencontre l'exemption des limites courantes d'évaluation dans la numéro 6 de RSS 102 et la conformité à l'exposition de RSS-102 rf, utilisateurs peut obtenir l'information canadienne sur l'exposition et la conformité de rf.

This transmitter must not be co-located or operating in conjunction with any other antenna or transmitter. This equipment should be installed and operated with a minimum distance of 20 centimeters between the radiator and your body.

Cet émetteur ne doit pas être Co-placé ou ne fonctionnant en même temps qu'aucune autre antenne ou émetteur. Cet équipement devrait être installé et actionné avec une distance minimum de 20 centimètres entre le radiateur et votre corps.

## Wireless Capability Description:

The subwoofer in the system is designed for wired connection and does not have the ability to transmit or receive wireless signals.

The remote control uses infrared (IR) technology for device control and does not support any other wireless signal transmission or reception capabilities.

 **CA WARNING:** Can expose you to BPA, a carcinogen, and BPA, a reproductive. toxicant. See [www.P65Warnings.ca.gov](http://www.P65Warnings.ca.gov).

# ULTIMEA

Product Name: Soundbar  
Model No.: UC000  
Soundbar HVIN: UC000  
Subwoofer HVIN: UC000B

**EC REP** Ultimea GmbH  
Buchenring 57, 22359 Hamburg, Germany

**UK REP** EVATOST CONSULTING LTD  
Office 101 32 Threadneedle Street, London, United Kingdom, EC2R 8AY

@Ultimea Inc. All rights reserved, registered in the United States and other countries. 801 S. Dupont Ave., Ste G, Ontario, CA, 91761, USA

Made in China  
Manufacturer: Ultimea Technology (Shenzhen) Limited  
Address: 20th Floor, Building 4, Tianan Cloud Park, Bantian St., Longgang District, Shenzhen, China 518000

Manufacturer Contact Information:

+1 888-598-8875 (US) Mon-Fri 9am-5pm (PST) +49 89-628-25828 (EU) Mon-Fri 9am-5pm (CET) support@ultimea.com support.ultimea.com

If you need our support, kindly reach out to our service team. We are always glad to help.



Soundbar MIC ID: Subwoofer MIC ID:

219-258296 219-258295 Shen Zhen Shi Xin Fei Yi Ke Ji You Xian Gong Si



Warranty Extension Plan

## EU DECLARATION OF CONFORMITY

We (Manufacturer is responsible for this declaration) 20th Floor, Building 4, Tianan Cloud Park, Bantian St., Declare under our sole responsibility that the product Trade Mark: ULTIMEA Product Name: Soundbar Model No.: UC000

Ultimea Technology (Shenzhen) Limited  
Longgang District Shenzhen, China 518000

The product to which this declaration relates is in conformity with the essential requirements set out in the Council Directive on the Approximation of the laws of the Member States relating to the Radio Equipment Directive (2014/53/EU), the Restriction of Hazardous Substances Directive (2011/65/EU), the Electromagnetic Compatibility Directive (2014/30/EU), and the Low Voltage Directive (2014/35/EU). The product is responsible for affixing the CE marking, and the following standards were applied:

EN 55032:2015/A1:2020 EN 55035:2017/A1:2020 EN IEC 61000-3-2:2019/A2:2024 EN 61000-3-3:2013/A2:2021 ETSI EN 301 489-1 V2.2.3 (2019-11) ETSI EN 301 489-17 V3.2.4 (2020-09) ETSI EN 300 328 V2.2.2 (2019-07) EN IEC 62311:2020 EN IEC 62368-1:2020+A11:2020 Full Name: Yoyo.Yu Position: Approval Manager Signature: Place/Date: Shenzhen, China / Feb. 01-2026

Trade Marks:



The Bluetooth® word mark and logos are registered trademarks owned by Bluetooth SIG, Inc. and any use of such marks by Ultimea Technology (Shenzhen) Limited. is under license. Other trademarks and trade names are those of their respective owners.



The terms HDMI, HDMI High-Definition Multimedia Interface, HDMI trade dress and the HDMI Logos are trademarks or registered trademarks of HDMI Licensing Administrator, Inc.