

ULTIMEA



Ultimea Poseidon M30

دليل المستخدم

- يرجى قراءة هذه التعليمات والاحتفاظ بها. اتبع جميع التحذيرات وشغل الجهاز وفقًا للتعليمات.
- لا تستخدم الجهاز بالقرب من الماء أو في البيئات الرطبة أو تحت المطر. تجنب سكب السوائل أو وضع أوعية تحتوي على سوائل فوق الجهاز.
- نظف بقطعة قماش جافة فقط. لا تستخدم منظفات سائلة.
- لا تسد فتحات التهوية ولا تقم بتركيب الجهاز في مكان مغلق. تأكد من وجود تهوية مناسبة.
- لا تركيب الجهاز بالقرب من مصادر الحرارة مثل المدافئ أو المضخات.
- استخدم الملحقات المعتمدة فقط. توخَّ الحذر عند تحريك الأجهزة ذات العجلات.
- احمِ سلك الطاقة من الدهس أو الانثناء.
- لا تعدّل القابس أو التأسيس. استشر كهربائيًا عند الحاجة.
- افصل الجهاز أثناء العواصف أو عند عدم الاستخدام لفترة طويلة.
- لا تضع مصادر لهب مفتوح مثل الشموع على الجهاز.
- لا تفتح الجهاز. الجهد العالي قد يسبب صدمة كهربائية أو الوفاة. الصيانة يجب أن تتم بواسطة فنيين مؤهلين.
- يجب ألا يتجاوز ارتفاع التشييت مترين.

2. قائمة الملحقات

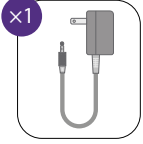
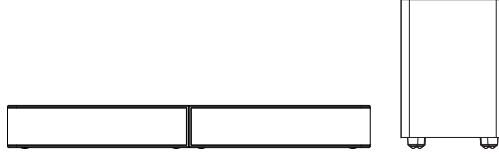

محول طاقة ساوند بار (1.5 م / 59 بوصة)

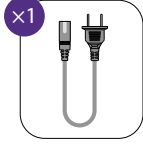

سلك طاقة مضخم الصوت (1.5 م / 59 بوصة)

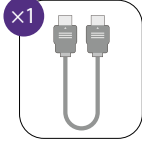

كابل HDMI (1.5 م / 59 بوصة)

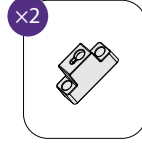

حوامل التثبيت



جهاز التحكم عن بُعد

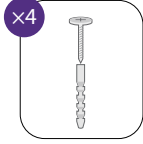

براغي ومثبتات التثبيت على الحائط

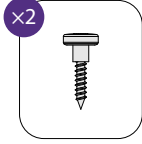

براغي

3. عناصر التحكم في الساوندبار

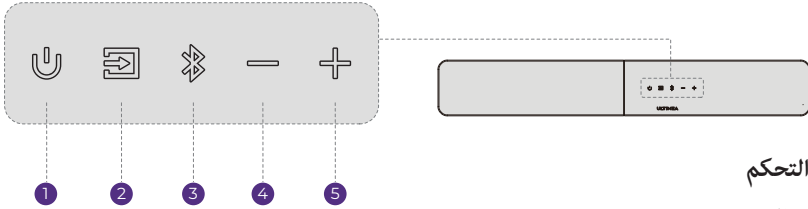

لوحة التحكم

- 1 "ن" زر التشغيل
اضغط للتشغيل أو للدخول في وضع الاستعداد.
- 2 "☐" المصدر
اضغط لتبديل مصدر الإدخال: - Bluetooth® - USB ARC - OPT (OPTICAL)
- 3 "📶" :
اضغط للتبديل إلى وضع Bluetooth® . سيدخل مكبر الصوت تلقائيًا في وضع الإقران. اضغط مع الاستمرار لمدة 3 ثوانٍ لفصل الجهاز الحالي وإقران جهاز جديد يدويًا من الهاتف الذكي أو الكمبيوتر أو التلفزيون.
- 4 "−" : خفض مستوى الصوت
- 5 "+": رفع مستوى الصوت

4. جهاز التحكم عن بعد

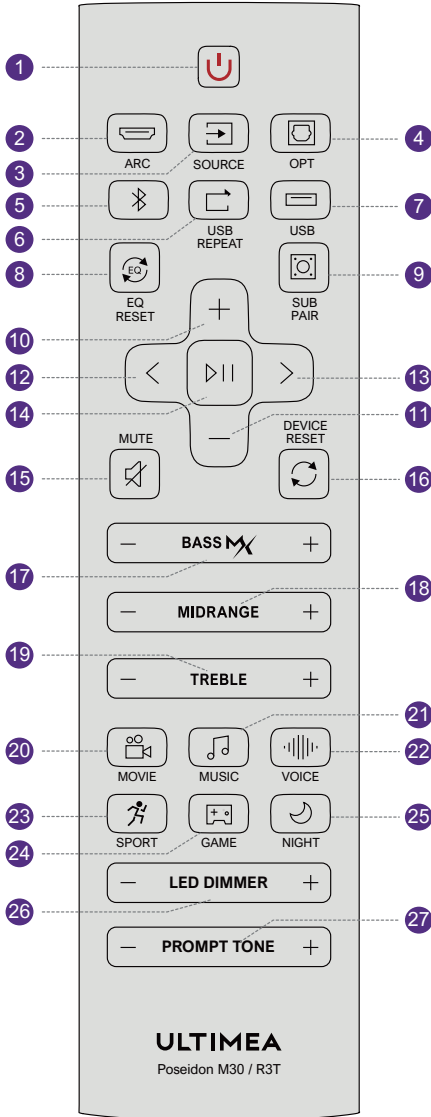

- 1 زر التشغيل : "⏻"
اضغط للدخول إلى وضع الاستعداد.
- 2 ARC : "⏻"
اضغط للتبديل إلى قناة HDMI ARC.
- 3 SOURCE : "⏻"
اضغط على هذا الزر للتبديل إلى إدخال ARC-OPT-BT-USB.
- 4 OPT : "⏻"
اضغط للتبديل إلى قناة OPTICAL. ARC-OPT-BT-USB.
- 5 Bluetooth® : "⏻"
اضغط للتبديل إلى قناة Bluetooth®. ARC-OPT-BT-USB.
- 6 USB REPEAT : "⏻"
وضع USB: اضغط للتبديل بين تشغيل تكرار مسار واحد وتشغيل تكرار القائمة.
- 7 USB : "⏻"
اضغط للتبديل إلى قناة USB.
- 8 EQ RESET : "⏻"
اضغط لإعادة ضبط جميع إعدادات EQ إلى الإعدادات الافتراضية.
- 9 SUB REPEAT : "⏻"
اضغط مع الاستمرار على الزر لمدة 3 ثوانٍ لوضع Soundbar في حالة جاهزة للاقتران مع مضخم الصوت.
- 10 "+" : رفع مستوى الصوت
- 11 "-" : خفض مستوى الصوت
- 12 "<" : السابق
لوضعي Bluetooth وUSB فقط: التخطي إلى المسار السابق.
- 13 ">" : التالي
لوضعي Bluetooth وUSB فقط: التخطي إلى المسار التالي.
- 14 "⏮" : تشغيل/إيقاف مؤقت
لوضعي Bluetooth وUSB فقط.
- 15 MUTE : "⏻"
اضغط مع الاستمرار لمدة 5 ثوانٍ لإعادة ضبط الجهاز.
- 16 DEVICE RESET : "⏻"
اضغط لضبط مستوى الجهر، وستعرض الشاشة:
"BASS 0", "BASS 1", "BASS 2", "BASS 3", "BASS 4", "BASS 5", "BASS 6",
"BASS 7", "BASS 8", "BASS 9", "BASS 10", "BASS 11", "BASS 12", "BASS 13", "BASS 14", "BASS 15", "BASS 16", "BASS 17", "BASS 18", "BASS 19", "BASS 20", "BASS 21", "BASS 22", "BASS 23", "BASS 24", "BASS 25", "BASS 26", "BASS 27", "BASS 28", "BASS 29", "BASS 30", "BASS 31", "BASS 32", "BASS 33", "BASS 34", "BASS 35", "BASS 36", "BASS 37", "BASS 38", "BASS 39", "BASS 40", "BASS 41", "BASS 42", "BASS 43", "BASS 44", "BASS 45", "BASS 46", "BASS 47", "BASS 48", "BASS 49", "BASS 50", "BASS 51", "BASS 52", "BASS 53", "BASS 54", "BASS 55", "BASS 56", "BASS 57", "BASS 58", "BASS 59", "BASS 60", "BASS 61", "BASS 62", "BASS 63", "BASS 64", "BASS 65", "BASS 66", "BASS 67", "BASS 68", "BASS 69", "BASS 70", "BASS 71", "BASS 72", "BASS 73", "BASS 74", "BASS 75", "BASS 76", "BASS 77", "BASS 78", "BASS 79", "BASS 80", "BASS 81", "BASS 82", "BASS 83", "BASS 84", "BASS 85", "BASS 86", "BASS 87", "BASS 88", "BASS 89", "BASS 90", "BASS 91", "BASS 92", "BASS 93", "BASS 94", "BASS 95", "BASS 96", "BASS 97", "BASS 98", "BASS 99", "BASS 100".
- 17 BASSMX : "BASS MX"
اضغط لضبط مستوى النطاق المتوسط، وستعرض الشاشة:
"MR 0", "MR 1", "MR 2", "MR 3", "MR 4", "MR 5", "MR 6", "MR 7", "MR 8", "MR 9", "MR 10", "MR 11", "MR 12", "MR 13", "MR 14", "MR 15", "MR 16", "MR 17", "MR 18", "MR 19", "MR 20", "MR 21", "MR 22", "MR 23", "MR 24", "MR 25", "MR 26", "MR 27", "MR 28", "MR 29", "MR 30", "MR 31", "MR 32", "MR 33", "MR 34", "MR 35", "MR 36", "MR 37", "MR 38", "MR 39", "MR 40", "MR 41", "MR 42", "MR 43", "MR 44", "MR 45", "MR 46", "MR 47", "MR 48", "MR 49", "MR 50", "MR 51", "MR 52", "MR 53", "MR 54", "MR 55", "MR 56", "MR 57", "MR 58", "MR 59", "MR 60", "MR 61", "MR 62", "MR 63", "MR 64", "MR 65", "MR 66", "MR 67", "MR 68", "MR 69", "MR 70", "MR 71", "MR 72", "MR 73", "MR 74", "MR 75", "MR 76", "MR 77", "MR 78", "MR 79", "MR 80", "MR 81", "MR 82", "MR 83", "MR 84", "MR 85", "MR 86", "MR 87", "MR 88", "MR 89", "MR 90", "MR 91", "MR 92", "MR 93", "MR 94", "MR 95", "MR 96", "MR 97", "MR 98", "MR 99", "MR 100".
- 18 MIDRANGE : "MIDRANGE"
اضغط لضبط مستوى الصوت العالي، وستعرض الشاشة:
"TR 0", "TR 1", "TR 2", "TR 3", "TR 4", "TR 5", "TR 6", "TR 7", "TR 8", "TR 9", "TR 10", "TR 11", "TR 12", "TR 13", "TR 14", "TR 15", "TR 16", "TR 17", "TR 18", "TR 19", "TR 20", "TR 21", "TR 22", "TR 23", "TR 24", "TR 25", "TR 26", "TR 27", "TR 28", "TR 29", "TR 30", "TR 31", "TR 32", "TR 33", "TR 34", "TR 35", "TR 36", "TR 37", "TR 38", "TR 39", "TR 40", "TR 41", "TR 42", "TR 43", "TR 44", "TR 45", "TR 46", "TR 47", "TR 48", "TR 49", "TR 50", "TR 51", "TR 52", "TR 53", "TR 54", "TR 55", "TR 56", "TR 57", "TR 58", "TR 59", "TR 60", "TR 61", "TR 62", "TR 63", "TR 64", "TR 65", "TR 66", "TR 67", "TR 68", "TR 69", "TR 70", "TR 71", "TR 72", "TR 73", "TR 74", "TR 75", "TR 76", "TR 77", "TR 78", "TR 79", "TR 80", "TR 81", "TR 82", "TR 83", "TR 84", "TR 85", "TR 86", "TR 87", "TR 88", "TR 89", "TR 90", "TR 91", "TR 92", "TR 93", "TR 94", "TR 95", "TR 96", "TR 97", "TR 98", "TR 99", "TR 100".
- 19 TREBLE : "TREBLE"
اضغط لضبط مستوى الصوت المنخفض، وستعرض الشاشة:
"PT 0", "PT 1", "PT 2", "PT 3", "PT 4", "PT 5", "PT 6", "PT 7", "PT 8", "PT 9", "PT 10", "PT 11", "PT 12", "PT 13", "PT 14", "PT 15", "PT 16", "PT 17", "PT 18", "PT 19", "PT 20", "PT 21", "PT 22", "PT 23", "PT 24", "PT 25", "PT 26", "PT 27", "PT 28", "PT 29", "PT 30", "PT 31", "PT 32", "PT 33", "PT 34", "PT 35", "PT 36", "PT 37", "PT 38", "PT 39", "PT 40", "PT 41", "PT 42", "PT 43", "PT 44", "PT 45", "PT 46", "PT 47", "PT 48", "PT 49", "PT 50", "PT 51", "PT 52", "PT 53", "PT 54", "PT 55", "PT 56", "PT 57", "PT 58", "PT 59", "PT 60", "PT 61", "PT 62", "PT 63", "PT 64", "PT 65", "PT 66", "PT 67", "PT 68", "PT 69", "PT 70", "PT 71", "PT 72", "PT 73", "PT 74", "PT 75", "PT 76", "PT 77", "PT 78", "PT 79", "PT 80", "PT 81", "PT 82", "PT 83", "PT 84", "PT 85", "PT 86", "PT 87", "PT 88", "PT 89", "PT 90", "PT 91", "PT 92", "PT 93", "PT 94", "PT 95", "PT 96", "PT 97", "PT 98", "PT 99", "PT 100".
- 20 MOVIE : "MOVIE"
اضغط للتبديل إلى وضع MOVIE، وستعرض الشاشة: "MOVIE"
- 21 MUSIC : "MUSIC"
اضغط للتبديل إلى وضع MUSIC، وستعرض الشاشة: "MUSIC"
- 22 VOICE : "VOICE"
اضغط للتبديل إلى وضع VOICE، وستعرض الشاشة: "VOICE"
- 23 SPORT : "SPORT"
اضغط للتبديل إلى وضع SPORT، وستعرض الشاشة: "SPORT"
- 24 GAME : "GAME"
اضغط للتبديل إلى وضع GAME، وستعرض الشاشة: "GAME"
- 25 NIGHT : "NIGHT"
اضغط للتبديل إلى وضع NIGHT، وستعرض الشاشة: "NIGHT"
- 26 LED DIMMER : "LED DIMMER"
اضغط لضبط سطوع الشاشة على 5 مستويات. اضغط مع الاستمرار لمدة 3 ثوانٍ لإيقاف تشغيل شاشة LED.
- 27 PROMPT TONE : "PROMPT TONE"
اضغط لضبط مستوى نغمة التنبيه، وستعرض الشاشة:
"PT 0", "PT 1", "PT 2", "PT 3"

5. تركيب الساوندبار

قم بمحاذاة مواضع التوصيل بين الجزأين ثم لفهما معًا حتى يتم تثبيتهما بإحكام.
تنبيه: تأكد من إيقاف تشغيل الساوند بار أثناء التجميع.

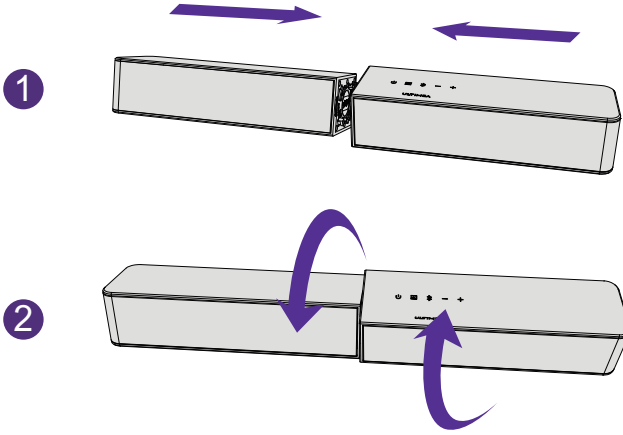

6. اللوحة الخلفية

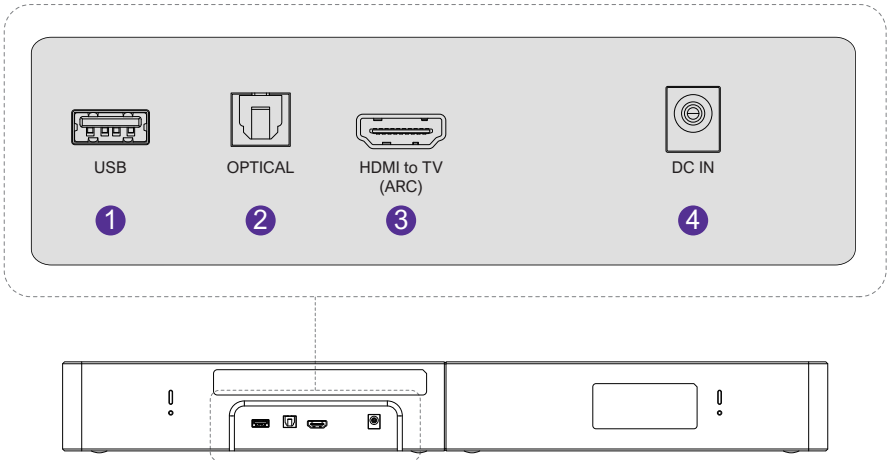

ملاحظة: يدعم USB ملفات MP3 أو FLAC.

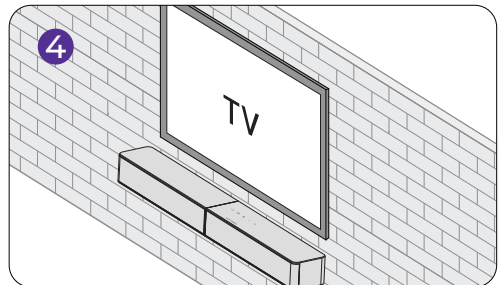
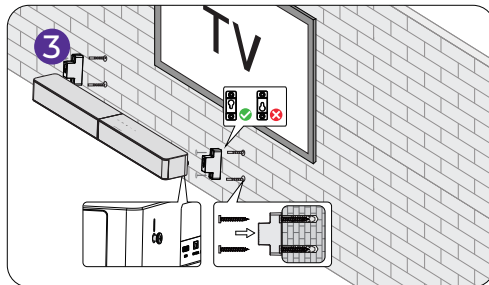
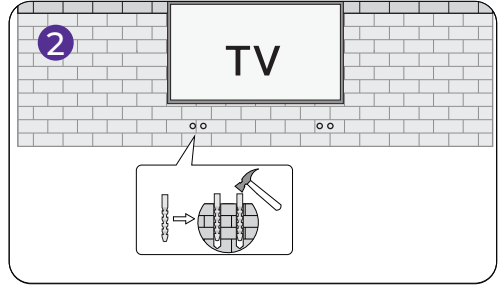
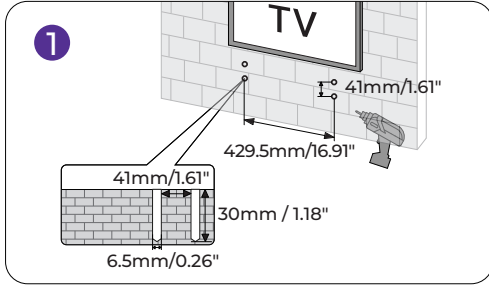
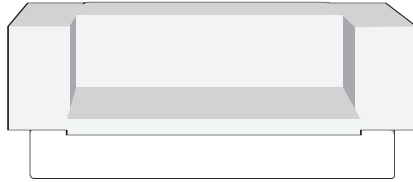
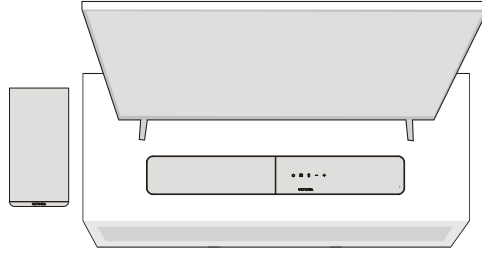

1 قم بتوصيل محول طاقة الساوند بار بمقبس حائط.

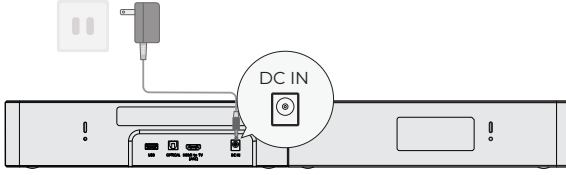

2 قم بتوصيل كابل طاقة مضخم الصوت بمقبس حائط.

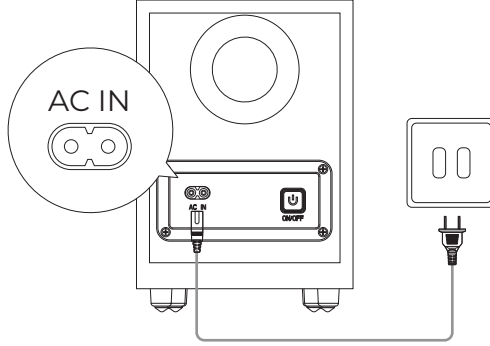

3 ملاحظة: يُوصى باستخدام بطاريات قلووية للاستعمال مرة واحدة. لا يُوصى باستخدام البطاريات القابلة لإعادة الشحن.

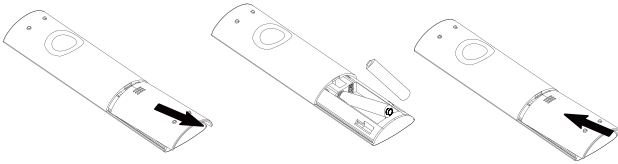

البطاريات غير مرفقة.

10. التوصيل بالتلفزيون عبر HDMI ARC

- 1 قم بتوصيل أحد طرفي كابل HDMI بمنفذ الصوت الشريطي.
- 2 قم بتوصيل الطرف الآخر بمنفذ ARC في مكبر الصوت الشريطي.

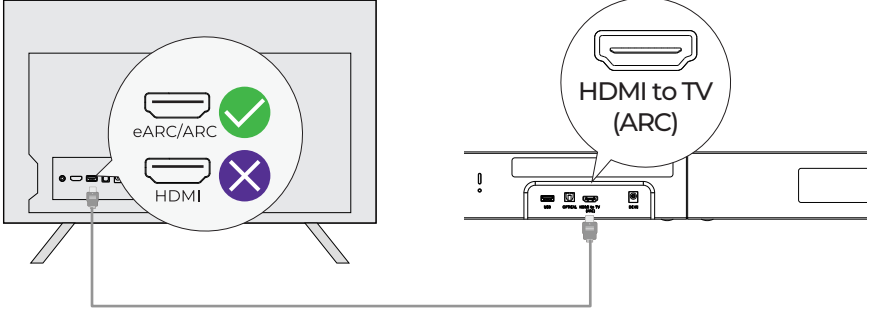

- 3 اضغط على زر "Source" في جهاز التحكم لاختيار إدخال "ARC".

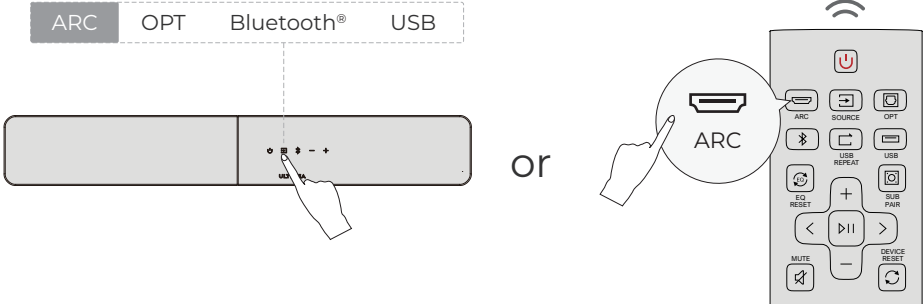

إذا لم يكن هناك صوت، فحاول ضبط خرج الصوت في التلفزيون على PCM: إعدادات التلفزيون > الصفحة الرئيسية > الإعدادات > الصوت > خرج الصوت الرقمي < PCM

يدعم HDMI ARC نقل الصوت ثنائي الاتجاه بين التلفزيون ونظام الصوت عبر كابل HDMI واحد.

ملاحظة: يرجى تفعيل وظيفة "CEC" على التلفزيون. عند توصيل ARC، يمكن لجهاز التحكم عن بُعد الخاص بالتلفزيون التحكم في الساوند بار والتلفزيون في الوقت نفسه: 1 تشغيل/إيقاف 2 ضبط مستوى الصوت

11. التوصل بال تلفزيون عبر الكابل البصري

1 أكد من أن منفذ التلفزيون هو OPTICAL OUT، ثم قم بتوصيل طرفي الكابل البصري بمنفذ OPTICAL في كل من التلفزيون ومكبر الصوت.

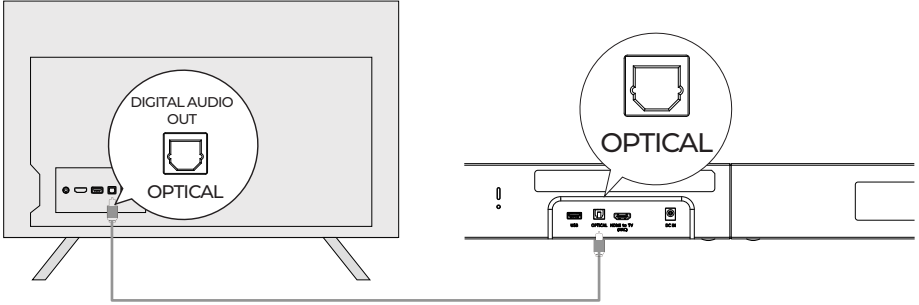

2 تأكد من إدخال القابس البصري بشكل صحيح كما هو موضح في الصورة. لا تقم بإدخاله بشكل مقلوب حتى لا يتسبب ذلك في تلف المنفذ البصري.

3 إعدادات التلفزيون < الصفحة الرئيسية < الإعدادات < الصوت < مخرج الصوت الرقمي < PCM

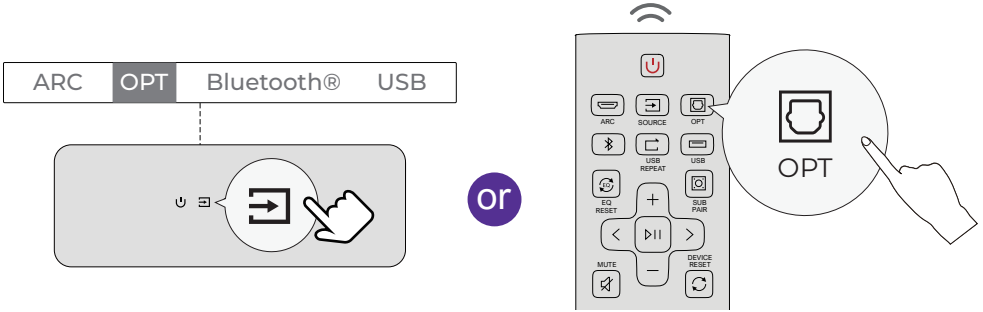

ملاحظة: إذا كان الصوت يصدر من مكبرات صوت التلفزيون الداخلية، فقم بكم صوت التلفزيون أو خفض مستوى الصوت إلى الحد الأدنى.

14. استعادة إعدادات المصنع

اضغط مع الاستمرار على زر
DEVICE RESET لمدة 5 ثوانٍ
لاستعادة إعدادات المصنع.

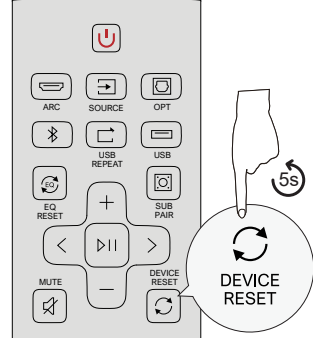

15. ضبط مستوى صوت التنبيه

إذا كان صوت التنبيه في مكبر الصوت مرتفعًا جدًا، يمكنك ضبط مستوى الصوت من خلال
.ULTIMEA App

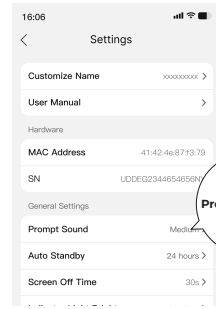
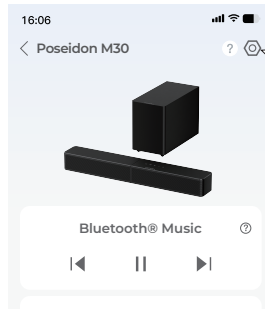

- 1 امسح رمز QR لتنزيل ULTIMEA App، ثم أضف مكبر الصوت الخاص بك إلى التطبيق
- 2 افتح صفحة تفاصيل الجهاز لمكبر الصوت، واضغط على أيقونة الإعدادات في الزاوية العلوية اليمنى، ثم اختر "Prompt Sound Volume" واضبط المستوى حسب الحاجة

Model Number	UC000
Power Supply	18V 2A DC(Soundbar); 100-240V~50/60Hz AC (Subwoofer)
Soundbar Drivers	Soundbar: 2.25" × 2, Subwoofer: 5.25"
Auto Standby	The soundbar will turn to standby mode if there is no audio signal for 15 minutes. You can set the standby time in the App
Standby Power	<0.5W
Operating Temperature	-10°C – 45°C / 14°F – 113°F
Bluetooth® Version	6.0

Soundbar	600 × 70 × 90 mm / 23.6" × 2.8" × 3.5"
Subwoofer	300 × 200 × 150 mm / 11.8" × 7.9" × 5.9"
Packaging	335 × 437 × 197 mm / 13.2" × 17.2" × 7.8"
Packaging Weight	5.8 kg / 12.8 lbs

USB Output	5V 500mA DC
Operating Altitude	2000 meters above sea level
Wall Mount Screw	4 × 35 mm / 0.2" × 1.4"
Bracket Screws Diameter	3 mm / 0.12"
Remote Control Battery Type	2 × AAA (NOT INCLUDED)
Notice: Risk of fire or explosion if the battery is replaced by an incorrect type.	

PROPER DISPOSAL INSTRUCTIONS



This mark shown on the product or its packaging, indicates that this product should not be disposed of with other household waste at the end of its working life. To prevent possible harm to the environment or human health from uncontrolled waste disposal, please separate this from other types of wastes and recycle it responsibly to promote the sustainable reuse of material resources.

WASTE ELECTRICAL & ELECTRONIC EQUIPMENT

Household user should contact either the retailer where they purchased this product, or their local government office, for details of where and how they can take this item for environmentally safe recycling. Business users should contact their suppliers and check the terms and conditions of the purchase contract. This product should not be mixed with other commercial wastes for disposal.

WIRELESS FREQUENCY RANGE AND WIRELESS OUTPUT POWER:

Frequency: 2.402GHz-2.48GHz

The Max. transmit power (Applies only to the EU): 10 dBm

FCC REGULATORY COMPLIANCE

Any changes or modifications not expressly approved by the party responsible for compliance could void the user's authority to operate the equipment.

This device complies with Part 15 of the FCC Rules.

Operation is subject to the following two conditions:

- (1) This device may not cause harmful interference.
 - (2) This device must accept any interference received, including interference that may cause undesired operation.
- NOTE: This equipment has been tested and found to comply with the limits for a Class B digital device, pursuant to part 15 of the FCC Rules. These limits are designed to provide reasonable protection against harmful interference in a residential installation. This equipment generates, uses, and can radiate radio frequency energy, and if not installed and used in accordance with the instructions, may cause harmful interference to radio communications. However, there is no guarantee that interference will not occur in a particular installation. If this equipment does cause harmful interference to radio or television reception, which can be determined by turning the equipment off and on, the user is encouraged to try to correct the interference by one or more of the following measures:
- Reorient or relocate the receiving antenna.
 - Increase the separation between the equipment and the receiver.
 - Connect the equipment to an outlet on a circuit different from that to which the receiver is connected.
 - Consult the dealer or an experienced radio / TV technician for help.

This equipment complies with FCC radiation exposure limits set forth for an uncontrolled environment. This equipment should be installed and operated with a minimum distance of 20cm between the radiator & your body. This transmitter must not be co-located or operating in conjunction with any other antenna or transmitter.

CE WARNINGS

- (1) Do not install this equipment in a confined or building-in space such as a book case or similar unit, and remain a well ventilation conditions. The ventilation should not be impeded by covering the ventilation openings with items such as newspaper, table-cloths, curtains etc.
- (2) WARNING: To reduce the risk of fire or electric shock, do not expose this apparatus to rain or moisture. The apparatus shall not be exposed to dripping or splashing and that objects filled with liquids, such as vases, shall not be placed on apparatus.
- (3) WARNING: The adapter plug is used as disconnect device, the disconnect device shall remain readily operable.
- (4) Frequency: 2.402GHz-2.48GHz
- (5) The Max. transmit power: 10 dBm

 **WARNING:** This product can expose you to chemicals including lead, which is known to the State of California to cause cancer and birth defects or other reproductive harm. For more information, go to www.P65Warnings.ca.gov.

ISED WARNINGS

This device contains licence-exempt transmitter(s)/receiver(s) that comply with Innovation, Science and Economic Development Canada's licence-exempt RSS(s). Operation is subject to the following two conditions:

- (1) This device may not cause interference.
- (2) This device must accept any interference, including interference that may cause undesired operation of the device.

L'émetteur/récepteur exempt de licence contenu dans le présent appareil est conforme aux CNR d'Innovation, Sciences et Développement économique Canada applicables aux appareils radio exempts de licence. L'exploitation est autorisée aux deux conditions suivantes :

- 1) L'appareil ne doit pas produire de brouillage;
- 2) L'appareil doit accepter tout brouillage radioélectrique subi, même si le brouillage est susceptible d'en compromettre le fonctionnement.
- 3) The device meets the exemption from the routine evaluation limits in issue6 of RSS 102 and compliance with RSS-102 RF exposure, users can obtain Canadian information on RF exposure and compliance.

Le dispositif rencontre l'exemption des limites courantes d'évaluation dans la numéro 6 de RSS 102 et la conformité à l'exposition de RSS-102 rf, utilisateurs peut obtenir l'information canadienne sur l'exposition et la conformité de rf.

This transmitter must not be co-located or operating in conjunction with any other antenna or transmitter. This equipment should be installed and operated with a minimum distance of 20 centimeters between the radiator and your body.

Cet émetteur ne doit pas être Co-placé ou ne fonctionnant en même temps qu'aucune autre antenne ou émetteur. Cet équipement devrait être installé et actionné avec une distance minimum de 20 centimètres entre le radiateur et votre corps.

Wireless Capability Description:

The subwoofer in the system is designed for wired connection and does not have the ability to transmit or receive wireless signals. The remote control uses infrared (IR) technology for device control and does not support any other wireless signal transmission or reception capabilities.

 **CA WARNING:** Can expose you to BPA, a carcinogen, and BPA, a reproductive. toxicant. See www.P65Warnings.ca.gov.

ULTIMEA

Product Name: Soundbar
Model No.: UC000
Soundbar HVIN: UC000
Subwoofer HVIN: UC000B

 Ultimea GmbH
Buchenring 57, 22359 Hamburg, Germany

 EVATOST CONSULTING LTD
Office 101 32 Threadneedle Street, London, United Kingdom, EC2R 8AY

@Ultimea Inc. All rights reserved, registered in the United States and other countries. 801 S. Dupont Ave., Ste G, Ontario, CA, 91761, USA

Made in China
Manufacturer: Ultimea Technology (Shenzhen) Limited
Address: 20th Floor, Building 4, Tianan Cloud Park, Bantian St., Longgang District, Shenzhen, China 518000

Manufacturer Contact Information:

 +1 888-598-8875 (US) Mon-Fri 9am-5pm (PST)  +49 89-628-25828 (EU) Mon-Fri 9am-5pm (CET)  support@ultimea.com  support.ultimea.com

If you need our support, kindly reach out to our service team. We are always glad to help.



Soundbar MIC ID: Subwoofer MIC ID:

 219-258296

 219-258295

 Shen Zhen Shi Xin Fei Yi
Ke Ji You Xian Gong Si



Warranty Extension Plan

EU DECLARATION OF CONFORMITY

We (Manufacturer is responsible for this declaration)
20th Floor, Building 4, Tianan Cloud Park, Bantian St.,
Declare under our sole responsibility that the product
Trade Mark: ULTIMEA
Product Name: Soundbar
Model No.: UC000

Ultimea Technology (Shenzhen) Limited
Longgang District Shenzhen, China 518000

The product to which this declaration relates is in conformity with the essential requirements set out in the Council Directive on the Approximation of the laws of the Member States relating to the Radio Equipment Directive (2014/53/EU), the Restriction of Hazardous Substances Directive (2011/65/EU), the Electromagnetic Compatibility Directive (2014/30/EU), and the Low Voltage Directive (2014/35/EU). The product is responsible for affixing the CE marking, and the following standards were applied:

EN 55032:2015/A1:2020
EN 55035:2017/A1:2020
EN IEC 61000-3-2:2019/A2:2024
EN 61000-3-3:2013/A2:2021

ETSI EN 301 489-1 V2.2.3 (2019-11)
ETSI EN 301 489-17 V3.2.4 (2020-09)
ETSI EN 300 328 V2.2.2 (2019-07)
EN IEC 62311:2020
EN IEC 62368-1:2020+A1:2020

Full Name: Yoyo.Yu
Position: Approval Manager
Signature: 
Place/Date: Shenzhen, China / Feb. 01-2026

Trade Marks:



The Bluetooth® word mark and logos are registered trademarks owned by Bluetooth SIG, Inc. and any use of such marks by Ultimea Technology (Shenzhen) Limited. is under license. Other trademarks and trade names are those of their respective owners.



The terms HDMI, HDMI High-Definition Multimedia Interface, HDMI trade dress and the HDMI Logos are trademarks or registered trademarks of HDMI Licensing Administrator, Inc.