

ULTIMEA



Utimea Poseidon M30

# Panduan pengguna

## 1. PETUNJUK KESELAMATAN PENTING

- Bacalah dan simpan petunjuk ini. Ikuti semua peringatan dan gunakan perangkat sesuai petunjuk.
- Jangan gunakan perangkat di dekat air, di lingkungan lembap, atau saat hujan. Hindari menumpahkan cairan atau meletakkan benda berisi cairan (seperti vas) di atas perangkat.
- Bersihkan hanya dengan kain kering. Jangan gunakan pembersih cair.
- Jangan menutup ventilasi atau memasang perangkat di ruang tertutup. Pastikan ventilasi yang memadai sesuai petunjuk pabrikan.
- Jangan memasang di dekat sumber panas seperti radiator atau amplifier. Jangan menutup ventilasi dengan koran atau tirai.
- Gunakan hanya aksesori yang ditentukan oleh pabrikan. Berhati-hatilah saat memindahkan perangkat beroda.
- Lindungi kabel daya dari terinjak atau terjepit.
- Jangan mengubah fitur polaritas atau grounding pada steker. Konsultasikan dengan teknisi listrik jika tidak cocok.
- Cabut kabel daya saat terjadi badai atau tidak digunakan dalam waktu lama.
- Jangan letakkan sumber api terbuka seperti lilin menyala di atas perangkat.
- Jangan membuka perangkat. Tegangan tinggi di dalam dapat menyebabkan sengatan listrik atau kematian. Servis harus dilakukan oleh teknisi profesional.
- Tinggi pemasangan tidak boleh melebihi 2 meter.

## 2. DAFTAR AKSESORI

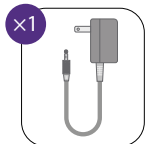

Adaptor Daya  
Soundbar (1.5m / 59")

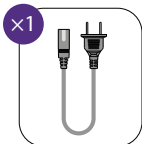

Kabel Daya  
Subwoofer (1.5m / 59")

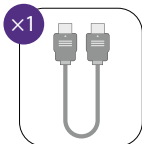

Kabel HDMI  
(1.5m / 59")

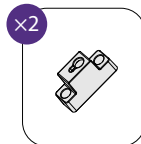

Braket  
Pemasangan

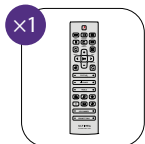

Remote  
Control

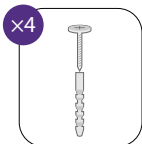

Sekrup dan  
Fischer Dinding

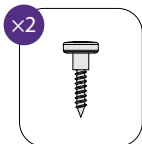

Sekrup

## 3. KONTROL SOUNDBAR

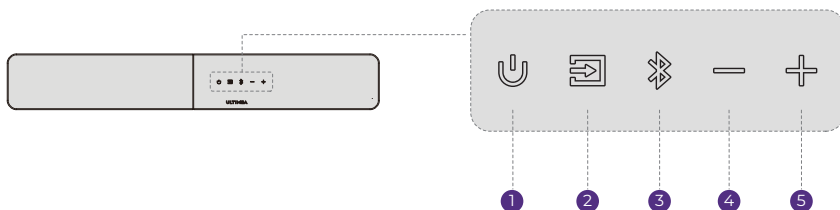

### Panel Kontrol

- 1 “⏻”: **Tombol Daya**  
Tekan untuk menyalakan atau masuk ke mode siaga.
- 2 “📺”: **Sumber**  
Tekan untuk mengganti sumber input: ARC - OPT (OPTICAL) - Bluetooth® - USB.
- 3 “📶”: **Bluetooth®**  
Tekan untuk beralih ke mode Bluetooth®. Soundbar akan otomatis masuk ke mode pairing. Tekan dan tahan selama 3 detik untuk memutuskan perangkat saat ini dan memasang perangkat baru secara manual dari smartphone, PC, atau TV.
- 4 “— ”: **Volume Turun**
- 5 “+ ”: **Volume Naik**

## 4. REMOTE KONTROL

- 1 "⏻": **Tombol Daya**  
Tekan untuk masuk ke mode siaga.
- 2 "↔": **ARC**  
Tekan untuk beralih ke saluran HDMI ARC.
- 3 "📺": **SOURCE**  
Tekan tombol ini untuk beralih ke input ARC-OPT-BT-USB.
- 4 "📺": **OPT**  
Tekan untuk beralih ke saluran OPTICAL.
- 5 "📶": **Bluetooth®**  
Tekan untuk beralih ke saluran Bluetooth®.
- 6 "🔄": **USB REPEAT**  
Mode USB: Tekan untuk beralih antara pemutaran ulang satu lagu dan pemutaran ulang daftar.
- 7 "📶": **USB**  
Tekan untuk beralih ke saluran USB.
- 8 "🔊": **EQ RESET**  
Tekan untuk mengatur ulang semua pengaturan EQ ke default.
- 9 "🔊": **SUB PAIR**  
Tekan dan tahan tombol selama 3 detik agar Soundbar siap dipasangkan dengan subwoofer.
- 10 "+": **Volume Naik**
- 11 "-": **Volume Turun**
- 12 "<": **Sebelumnya**  
Hanya untuk mode Bluetooth® dan USB: lewati ke trek sebelumnya.
- 13 ">": **Berikutnya**  
Hanya untuk mode Bluetooth® dan USB: lewati ke trek berikutnya.
- 14 "⏸": **Putar/Jeda**  
Hanya untuk mode Bluetooth® dan USB.
- 15 "🔇": **MUTE**
- 16 "🔄": **DEVICE RESET**  
Tekan dan tahan selama 5 detik untuk mengatur ulang perangkat.
- 17 "BASS MX": **BASSMX**  
Tekan untuk menyesuaikan level bass, layar akan menampilkan: "B5-6", "B5-5", "B5-4", "B5-3", "B5-2", "B5-1", "B5 0", "B5 1", "B5 2", "B5 3", "B5 4", "B5 5", "B5 6".
- 18 "MIDRANGE": **MIDRANGE**  
Tekan untuk menyesuaikan level midrange, layar akan menampilkan: "MR-6", "MR-5", "MR-4", "MR-3", "MR-2", "MR-1", "MR 0", "MR 1", "MR 2", "MR 3", "MR 4", "MR 5", "MR 6".
- 19 "TREBLE": **TREBLE**  
Tekan untuk menyesuaikan level treble, layar akan menampilkan: "T3-6", "T3-5", "T3-4", "T3-3", "T3-2", "T3-1", "T3 0", "T3 1", "T3 2", "T3 3", "T3 4", "T3 5", "T3 6".
- 20 "🎬": **MOVIE**  
Tekan untuk beralih ke mode MOVIE, layar akan menampilkan: "MOVIE".
- 21 "🎵": **MUSIC**  
Tekan untuk beralih ke mode MUSIC, layar akan menampilkan: "MUSIC".
- 22 "🔊": **VOICE**  
Tekan untuk beralih ke mode VOICE, layar akan menampilkan: "VOICE".
- 23 "🏃": **SPORT**  
Tekan untuk beralih ke mode SPORT, layar akan menampilkan: "SPORT".
- 24 "🎮": **GAME**  
Tekan untuk beralih ke mode GAME, layar akan menampilkan: "GAME".
- 25 "🌙": **NIGHT**  
Tekan untuk beralih ke mode NIGHT, layar akan menampilkan: "NIGHT".

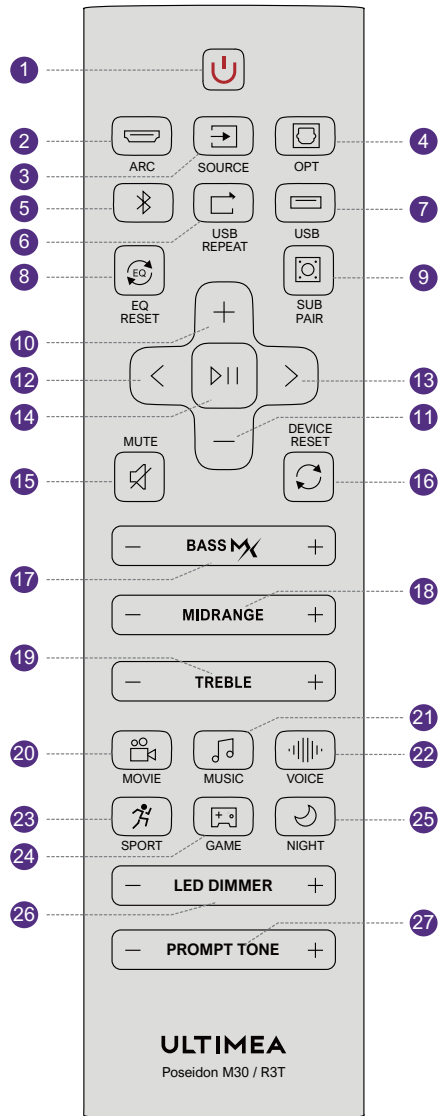

- 26 "LED DIMMER": **LED DIMMER**  
Tekan untuk menyesuaikan kecerahan layar dalam 5 tingkat. Tekan dan tahan selama 3 dtk untuk mematikan layar LED.
- 27 "PROMPT TONE": **PROMPT TONE**  
Tekan untuk menyesuaikan level nada perintah, layar akan menampilkan: "PT 0", "PT 1", "PT 2", "PT 3".

## 5. INSTALASI SOUNDBAR

Sejajarkan sambungan kedua bagian, lalu putar keduanya hingga terhubung dengan kuat.  
Perhatian: Pastikan soundbar dalam keadaan mati selama perakitan.

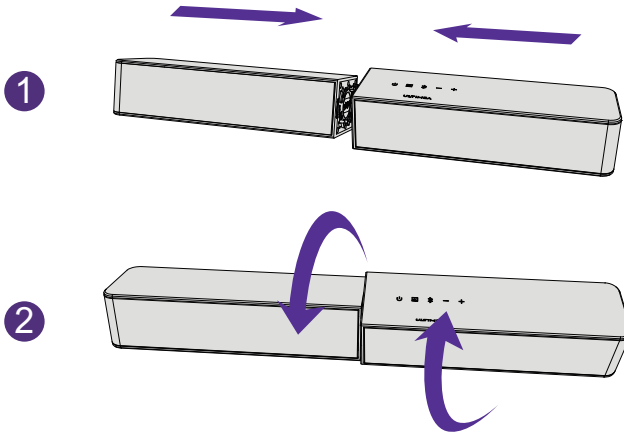

## 6. PANEL BELAKANG

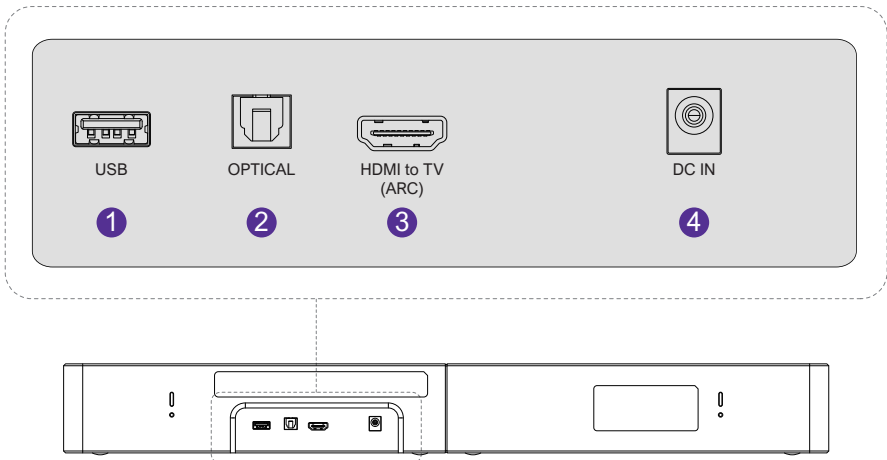

Catatan: USB mendukung file MP3 atau FLAC.

## 7. PENEMPATAN SISTEM

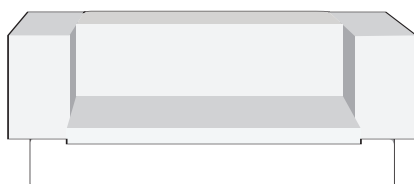
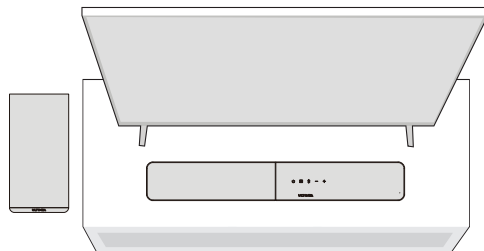

## 8. PEMASANGAN DI DINDING

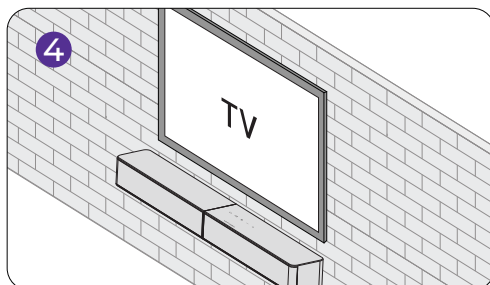
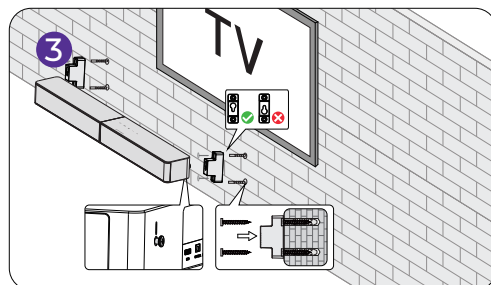
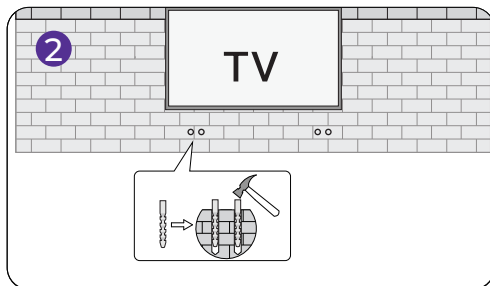
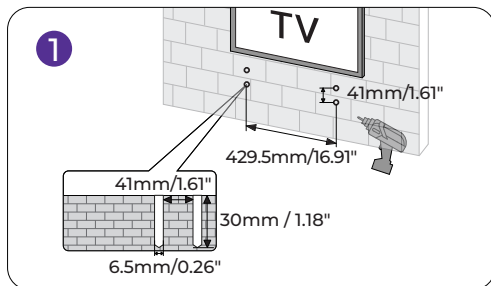

## 9. HUBUNGAN DAN NYALAKAN

- 1 Colokkan adaptor daya soundbar ke stopkontak dinding.

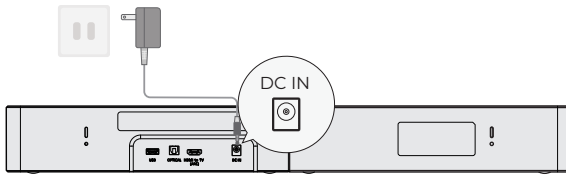

- 2 Colokkan kabel daya subwoofer ke stopkontak dinding.

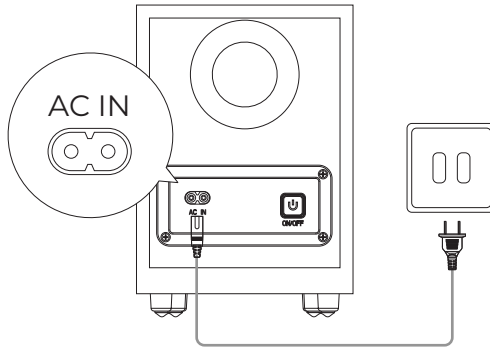

- 3 Catatan: Disarankan menggunakan baterai alkaline sekali pakai. Baterai isi ulang tidak disarankan.

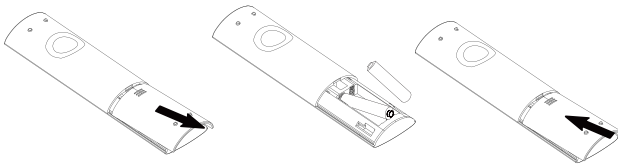

Baterai tidak termasuk.

## 10. HUBUNGKAN KE TV MELALUI HDMI ARC

- 1 Sambungkan satu ujung kabel HDMI ke port ARC di bagian belakang TV Anda.
- 2 Sambungkan ujung lainnya ke port ARC pada soundbar.

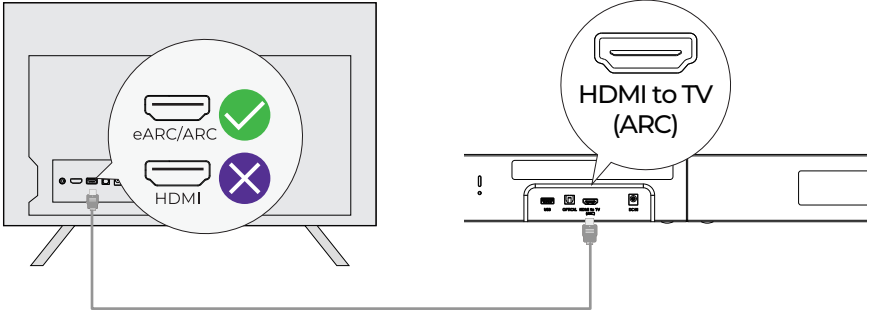

- 3 Tekan tombol "Source" pada remote control untuk memilih input "ARC".

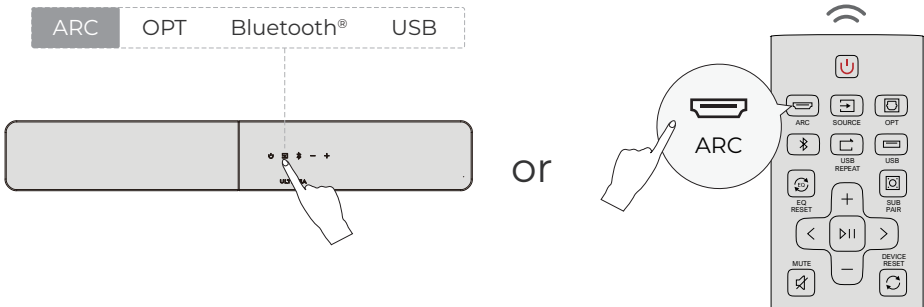

**Jika tidak ada suara, coba atur output audio TV ke PCM:** Pengaturan TV > Beranda > Pengaturan > Suara > Output Audio Digital > PCM

**HDMI ARC** mendukung transmisi audio dua arah antara TV dan sistem audio Anda melalui satu kabel HDMI.

**Catatan: Harap aktifkan fungsi "CEC" pada TV Anda.** Saat ARC terhubung, remote control TV Anda dapat mengontrol soundbar dan TV secara bersamaan: 1 Daya Hidup/Mati 2 Atur Volume

## 11. HUBUNGKAN KE TV MELALUI KABEL OPTIK

- 1 Pastikan port TV adalah OPTICAL OUT. Sambungkan kedua ujung kabel optik ke port OPTICAL pada TV dan soundbar.

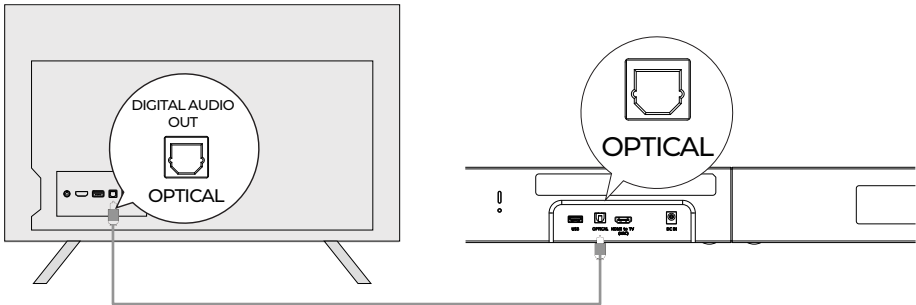

- 2 Pastikan konektor optik dimasukkan dengan benar seperti yang ditunjukkan pada gambar. Jangan memasukkannya secara terbalik, karena dapat merusak port optik.
- 3 Pengaturan TV > Beranda > Pengaturan > Suara > Output Audio Digital > PCM

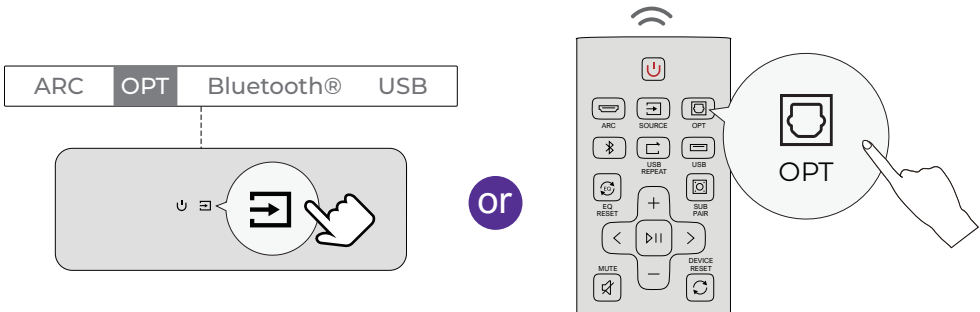

**Catatan: Jika audio diputar dari speaker internal TV, bisukan TV atau turunkan volume ke minimum.**

## 12. HUBUNGKAN KE Bluetooth®

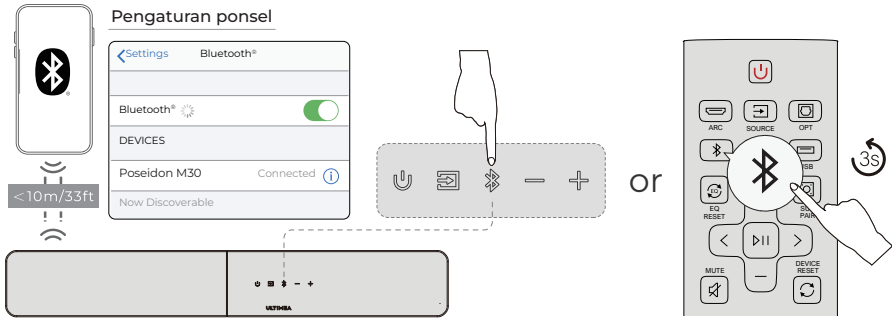

- 1 Tekan tombol "Bluetooth" pada soundbar atau tombol "Bluetooth" pada remote control untuk masuk ke mode pairing Bluetooth®
- 2 Buka pengaturan Bluetooth® di ponsel Anda, cari dan pilih "Poseidon M30" untuk menghubungkan soundbar
- 3 Catatan: Jika sudah dalam mode Bluetooth® dan terhubung, tekan dan tahan tombol "Bluetooth" selama 3 detik untuk memutuskan perangkat saat ini, lalu sambungkan perangkat baru secara manual melalui ponsel / PC / TV

## 13. PASANG ULANG SUBWOOFER

Biasanya soundbar dan subwoofer sudah dipasangkan dari pabrik. Jika koneksi terputus, ikuti langkah-langkah berikut untuk memasangkannya kembali:

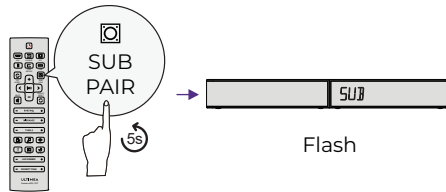

- 1 Tekan dan tahan tombol "SUB PAIR" pada remote control selama 5 detik. Tampilan unit utama akan berkedip "SUB" untuk menunjukkan mode pemasangan.

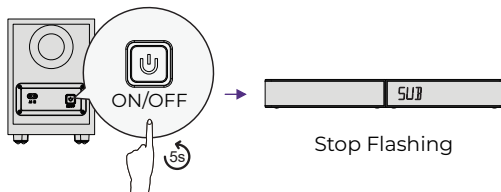

- 2 Tekan dan tahan tombol ON/OFF di bagian belakang subwoofer selama 5 detik untuk masuk ke mode pemasangan.
- 3 Setelah pairing berhasil, layar unit utama akan berhenti berkedip dan lampu indikator subwoofer akan menyala stabil

## 14. KEMBALIKAN KE PENGATURAN PABRIK

Tekan dan tahan tombol **DEVICE RESET** selama 5 detik untuk memulihkan pengaturan pabrik.

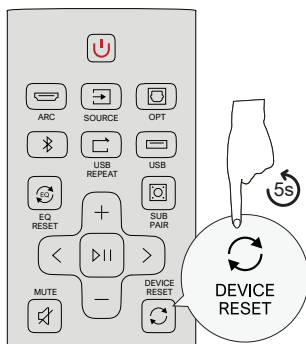

## 15. SESUAIKAN VOLUME SUARA NOTIFIKASI

Jika Anda merasa nada notifikasi soundbar terlalu keras, Anda dapat menyesuaikan volumenya melalui aplikasi **ULTIMEA**.

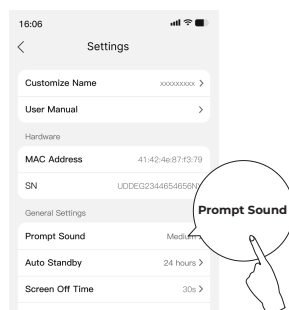
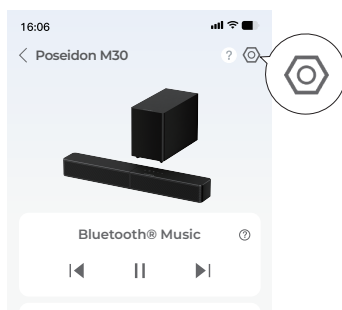

- 1 Pindai kode QR untuk mengunduh aplikasi ULTIMEA, lalu tambahkan soundbar Anda di aplikasi.
- 2 Buka halaman Detail Perangkat soundbar, ketuk ikon Pengaturan di pojok kanan atas, lalu pilih "Prompt Sound Volume". Sesuaikan level sesuai kebutuhan.

<b>Model Number</b>	UC000
<b>Power Supply</b>	18V 2A DC(Soundbar); 100-240V~50/60Hz AC (Subwoofer)
<b>Soundbar Drivers</b>	Soundbar: 2.25" × 2, Subwoofer: 5.25"
<b>Auto Standby</b>	The soundbar will turn to standby mode if there is no audio signal for 15 minutes. You can set the standby time in the App
<b>Standby Power</b>	<0.5W
<b>Operating Temperature</b>	-10°C – 45°C / 14°F – 113°F
<b>Bluetooth® Version</b>	6.0

<b>Soundbar</b>	600 × 70 × 90 mm / 23.6" × 2.8" × 3.5"
<b>Subwoofer</b>	300 × 200 × 150 mm / 11.8" × 7.9" × 5.9"
<b>Packaging</b>	335 × 437 × 197 mm / 13.2" × 17.2" × 7.8"
<b>Packaging Weight</b>	5.8 kg / 12.8 lbs

<b>USB Output</b>	5V 500mA DC
<b>Operating Altitude</b>	2000 meters above sea level
<b>Wall Mount Screw</b>	4 × 35 mm / 0.2" × 1.4"
<b>Bracket Screws Diameter</b>	3 mm / 0.12"
<b>Remote Control Battery Type</b>	2 × AAA (NOT INCLUDED)
Notice: Risk of fire or explosion if the battery is replaced by an incorrect type.	

## PROPER DISPOSAL INSTRUCTIONS



This mark shown on the product or its packaging, indicates that this product should not be disposed of with other household waste at the end of its working life. To prevent possible harm to the environment or human health from uncontrolled waste disposal, please separate this from other types of wastes and recycle it responsibly to promote the sustainable reuse of material resources.

## WASTE ELECTRICAL & ELECTRONIC EQUIPMENT

Household user should contact either the retailer where they purchased this product, or their local government office, for details of where and how they can take this item for environmentally safe recycling. Business users should contact their suppliers and check the terms and conditions of the purchase contract. This product should not be mixed with other commercial wastes for disposal.

## WIRELESS FREQUENCY RANGE AND WIRELESS OUTPUT POWER:

Frequency: 2.402GHz-2.48GHz

The Max. transmit power (Applies only to the EU): 10 dBm

## FCC REGULATORY COMPLIANCE

Any changes or modifications not expressly approved by the party responsible for compliance could void the user's authority to operate the equipment.

This device complies with Part 15 of the FCC Rules.

Operation is subject to the following two conditions:

(1) This device may not cause harmful interference.

(2) This device must accept any interference received, including interference that may cause undesired operation.

NOTE: This equipment has been tested and found to comply with the limits for a Class B digital device, pursuant to part 15 of the FCC Rules. These limits are designed to provide reasonable protection against harmful interference in a residential installation. This equipment generates, uses, and can radiate radio frequency energy, and if not installed and used in accordance with the instructions, may cause harmful interference to radio communications.

However, there is no guarantee that interference will not occur in a particular installation. If this equipment does cause harmful interference to radio or television reception, which can be determined by turning the equipment off and on, the user is encouraged to try to correct the interference by one or more of the following measures:

- Reorient or relocate the receiving antenna.

- Increase the separation between the equipment and the receiver.

- Connect the equipment to an outlet on a circuit different from that to which the receiver is connected.

- Consult the dealer or an experienced radio / TV technician for help.

This equipment complies with FCC radiation exposure limits set forth for an uncontrolled environment. This equipment should be installed and operated with a minimum distance of 20cm between the radiator & your body. This transmitter must not be co-located or operating in conjunction with any other antenna or transmitter.

## CE WARNINGS

(1) Do not install this equipment in a confined or building-in space such as a book case or similar unit, and remain a well ventilation conditions. The ventilation should not be impeded by covering the ventilation openings with items such as newspaper, table-cloths, curtains etc.

(2) WARNING: To reduce the risk of fire or electric shock, do not expose this apparatus to rain or moisture. The apparatus shall not be exposed to dripping or splashing and that objects filled with liquids, such as vases, shall not be placed on apparatus.

(3) WARNING: The adapter plug is used as disconnect device, the disconnect device shall remain readily operable.

(4) Frequency: 2.402GHz-2.48GHz

(5) The Max. transmit power: 10 dBm

 WARNING: This product can expose you to chemicals including lead, which is known to the State of California to cause cancer and birth defects or other reproductive harm. For more information, go to [www.P65Warnings.ca.gov](http://www.P65Warnings.ca.gov).

## ISED WARNINGS

This device contains licence-exempt transmitter(s)/receiver(s) that comply with Innovation, Science and Economic Development Canada's licence-exempt RSS(s). Operation is subject to the following two conditions:

(1) This device may not cause interference.

(2) This device must accept any interference, including interference that may cause undesired operation of the device.

L'émetteur/récepteur exempt de licence contenu dans le présent appareil est conforme aux

CNR d'Innovation, Sciences et Développement économique Canada applicables aux appareils radio exempts de licence. L'exploitation est autorisée aux deux conditions suivantes :

1) L'appareil ne doit pas produire de brouillage;

2) L'appareil doit accepter tout brouillage radioélectrique subi, même si le brouillage est susceptible d'en compromettre le fonctionnement.

3) The device meets the exemption from the routine evaluation limits in issue6 of RSS 102 and compliance with RSS-102 RF exposure, users can obtain Canadian information on RF exposure and compliance.

Le dispositif rencontre l'exemption des limites courantes d'évaluation dans la numéro 6 de RSS 102 et la conformité à l'exposition de RSS-102 rf, utilisateurs peut obtenir l'information canadienne sur l'exposition et la conformité de rf.

This transmitter must not be co-located or operating in conjunction with any other antenna or transmitter. This equipment should be installed and operated with a minimum distance of 20 centimeters between the radiator and your body.

Cet émetteur ne doit pas être Co-placé ou ne fonctionnant en même temps qu'aucune autre antenne ou émetteur. Cet équipement devrait être installé et actionné avec une distance minimum de 20 centimètres entre le radiateur et votre corps.

## Wireless Capability Description:

The subwoofer in the system is designed for wired connection and does not have the ability to transmit or receive wireless signals.

The remote control uses infrared (IR) technology for device control and does not support any other wireless signal transmission or reception capabilities.

 **CA WARNING:** Can expose you to BPA, a carcinogen, and BPA, a reproductive. toxicant. See [www.P65Warnings.ca.gov](http://www.P65Warnings.ca.gov).

# ULTIMEA

Product Name: Soundbar  
Model No.: UC000  
Soundbar HVIN: UC000  
Subwoofer HVIN: UC000B

 Ultimea GmbH  
Buchenring 57, 22359 Hamburg, Germany

 EVATOST CONSULTING LTD  
Office 101 32 Threadneedle Street, London, United Kingdom, EC2R 8AY

@Ultimea Inc. All rights reserved, registered in the United States and other countries. 801 S. Dupont Ave., Ste G, Ontario, CA, 91761, USA

Made in China  
Manufacturer: Ultimea Technology (Shenzhen) Limited  
Address: 20th Floor, Building 4, Tianan Cloud Park, Bantian St., Longgang District, Shenzhen, China 518000

Manufacturer Contact Information:

 +1 888-598-8875 (US) Mon-Fri 9am-5pm (PST)  +49 89-628-25828 (EU) Mon-Fri 9am-5pm (CET)  support@ultimea.com  support.ultimea.com

If you need our support, kindly reach out to our service team. We are always glad to help.



Soundbar MIC ID: Subwoofer MIC ID:

 219-258296

 219-258295

 Shen Zhen Shi Xin Fei Yi  
Ke Ji You Xian Gong Si



Warranty Extension Plan

## EU DECLARATION OF CONFORMITY

We (Manufacturer is responsible for this declaration)  
20th Floor, Building 4, Tianan Cloud Park, Bantian St.,  
Declare under our sole responsibility that the product  
Trade Mark: ULTIMEA  
Product Name: Soundbar  
Model No.: UC000

Ultimea Technology (Shenzhen) Limited  
Longgang District Shenzhen, China 518000

The product to which this declaration relates is in conformity with the essential requirements set out in the Council Directive on the Approximation of the laws of the Member States relating to the Radio Equipment Directive (2014/53/EU), the Restriction of Hazardous Substances Directive (2011/65/EU), the Electromagnetic Compatibility Directive (2014/30/EU), and the Low Voltage Directive (2014/35/EU). The product is responsible for affixing the CE marking, and the following standards were applied:

EN 55032:2015/A1:2020  
EN 55035:2017/A11:2020  
EN IEC 61000-3-2:2019/A2:2024  
EN 61000-3-3:2013/A2:2021

ETSI EN 301 489-1 V2.2.3 (2019-11)  
ETSI EN 301 489-17 V3.2.4 (2020-09)  
ETSI EN 300 328 V2.2.2 (2019-07)  
EN IEC 62311:2020  
EN IEC 62368-1:2020+A11:2020

Full Name: Yoyo.Yu  
Position: Approval Manager  
Signature:   
Place/Date: Shenzhen, China / Feb. 01-2026

Trade Marks:



The Bluetooth® word mark and logos are registered trademarks owned by Bluetooth SIG, Inc. and any use of such marks by Ultimea Technology (Shenzhen) Limited. is under license. Other trademarks and trade names are those of their respective owners.



The terms HDMI, HDMI High-Definition Multimedia Interface, HDMI trade dress and the HDMI Logos are trademarks or registered trademarks of HDMI Licensing Administrator, Inc.