

ULTIMEA



Utimea Poseidon M30

Manual do usuário

1. INSTRUÇÕES IMPORTANTES DE SEGURANÇA

- Leia e guarde estas instruções. Siga todos os avisos e utilize o dispositivo de acordo com as instruções.
- Não utilize o dispositivo perto de água, em ambientes húmidos ou à chuva. Evite derramar líquidos sobre o dispositivo ou colocar objetos com líquidos (como vasos) em cima dele.
- Limpe apenas com um pano seco. Não utilize produtos de limpeza líquidos.
- Não bloqueie as aberturas de ventilação nem instale o dispositivo em espaços confinados. Assegure ventilação adequada conforme as instruções do fabricante.
- Não instale perto de fontes de calor como radiadores, fogões, amplificadores ou outros dispositivos que produzam calor. Não cubra as aberturas de ventilação com jornais ou cortinas.
- Utilize apenas acessórios especificados pelo fabricante. Ao mover equipamentos com rodas, tenha cuidado para evitar quedas.
- Proteja o cabo de alimentação contra pisões, dobras ou esmagamentos.
- Não modifique a polarização ou ligação à terra da ficha. Se a ficha não encaixar na tomada, consulte um electricista.
- Desligue da tomada durante tempestades ou longos períodos sem uso.
- Não coloque fontes de chama aberta, como velas acesas, sobre o dispositivo.
- Não tente abrir o dispositivo. Alta tensão interna pode causar choque eléctrico ou morte. A manutenção deve ser realizada por pessoal qualificado.
- A altura de instalação não deve exceder 2 metros.

2. LISTA DE ACESSÓRIOS

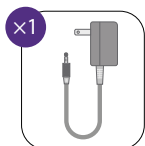

Adaptador de Alimentação da Soundbar (1.5m / 59")

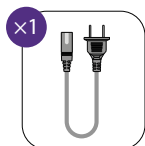

Cabo de Alimentação do Subwoofer (1.5m / 59")

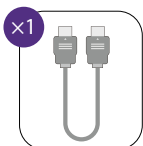

Cabo HDMI (1.5m / 59")

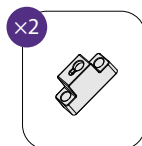

Suportes de Montagem

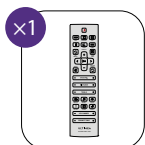

Controlo Remoto

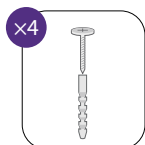

Parafusos e Buchas de Montagem na Parede

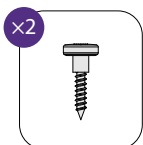

Parafusos

3. CONTROLES DA SOUNDBAR

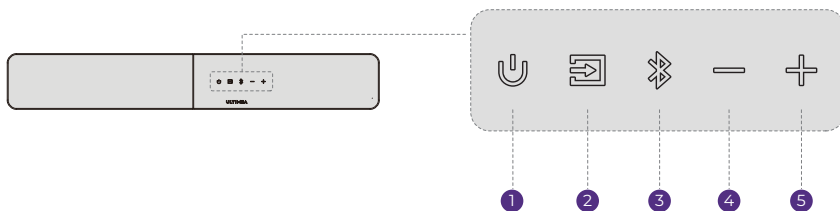

Painel de controlo

- 1 “⏻”: Botão de alimentação**
Prima para ligar ou entrar em modo de espera.
- 2 “📺”: Fonte**
Prima para alternar a fonte de entrada: ARC - OPT (OPTICAL) - Bluetooth® - USB
- 3 “📶”: Bluetooth®**
Prima para mudar para o modo Bluetooth®. A soundbar entrará automaticamente em modo de emparelhamento. Mantenha premido durante 3 segundos para desligar o dispositivo atual e emparelhar manualmente um novo dispositivo a partir do seu smartphone, PC ou TV.
- 4 “—”: Diminuir volume**
- 5 “+”: Aumentar volume**

4. CONTROLE REMOTO

- 1 "U": **Botão de alimentação**
Prima para entrar no modo de espera.
- 2 "ARC": **ARC**
Prima para mudar para o canal HDMI ARC.
- 3 "SOURCE": **SOURCE**
Prima este botão para mudar para a entrada ARC-OPT-BT-USB.
- 4 "OPT": **OPT**
Prima para mudar para o canal OPTICAL.
- 5 "Bluetooth®": **Bluetooth®**
Prima para mudar para o canal Bluetooth®.
- 6 "USB REPEAT": **USB REPEAT**
Modo USB: prima para alternar entre a reprodução em repetição de uma faixa e a reprodução em repetição da lista.
- 7 "USB": **USB**
Prima para mudar para o canal USB.
- 8 "EQ RESET": **EQ RESET**
Prima para repor todas as definições de EQ para os valores predefinidos.
- 9 "SUB PAIR": **SUB PAIR**
Prima sem soltar o botão durante 3 segundos para colocar a Soundbar num estado pronto para emparelhar com o subwoofer.
- 10 "+": **Aumentar volume**
- 11 "-": **Diminuir volume**
- 12 "<": **Anterior**
Apenas para o modo Bluetooth® e USB: salta para a faixa anterior.
- 13 ">": **Seguinte**
Apenas para o modo Bluetooth® e USB: salta para a faixa seguinte.
- 14 "II": **Reproduzir/Pausa**
Apenas para o modo Bluetooth® e USB.
- 15 "MUTE": **MUTE**
- 16 "DEVICE RESET": **DEVICE RESET**
Prima sem soltar durante 5 segundos para repor o dispositivo.
- 17 "BASS MX": **BASSMX**
Prima para ajustar o nível de graves, o ecrã irá mostrar: "B5-6", "B5-5", "B5-4", "B5-3", "B5-2", "B5-1", "B5 0", "B5 1", "B5 2", "B5 3", "B5 4", "B5 5", "B5 6".
- 18 "MIDRANGE": **MIDRANGE**
Prima para ajustar o nível de médios, o ecrã irá mostrar: "MR-6", "MR-5", "MR-4", "MR-3", "MR-2", "MR-1", "MR 0", "MR 1", "MR 2", "MR 3", "MR 4", "MR 5", "MR 6".
- 19 "TREBLE": **TREBLE**
Prima para ajustar o nível de agudos, o ecrã irá mostrar: "T3-6", "T3-5", "T3-4", "T3-3", "T3-2", "T3-1", "T3 0", "T3 1", "T3 2", "T3 3", "T3 4", "T3 5", "T3 6".
- 20 "MOVIE": **MOVIE**
Prima para mudar para o modo MOVIE, o ecrã irá mostrar: "MOVI".
- 21 "MUSIC": **MUSIC**
Prima para mudar para o modo MUSIC, o ecrã irá mostrar: "MUSC".
- 22 "VOICE": **VOICE**
Prima para mudar para o modo VOICE, o ecrã irá mostrar: "VOIC".
- 23 "SPORT": **SPORT**
Prima para mudar para o modo SPORT, o ecrã irá mostrar: "SPRT".
- 24 "GAME": **GAME**
Prima para mudar para o modo GAME, o ecrã irá mostrar: "GAME".
- 25 "NIGHT": **NIGHT**
Prima para mudar para o modo NIGHT, o ecrã irá mostrar: "NIGT".

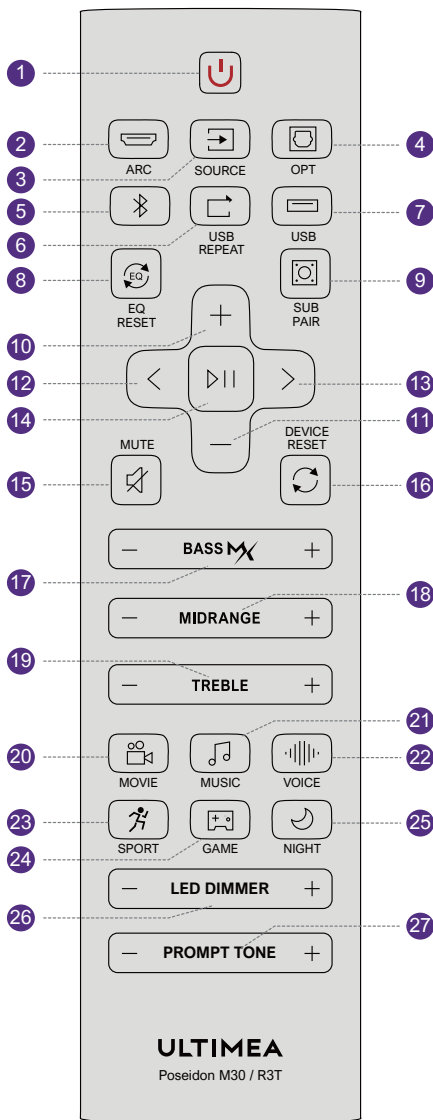

- 26 "LED DIMMER": **LED DIMMER**
Prima para ajustar o brilho do ecrã em 5 níveis. Prima sem soltar durante 3 s para desligar o ecrã LED.
- 27 "PROMPT TONE": **PROMPT TONE**
Prima para ajustar o nível do tom de aviso, o ecrã irá mostrar: "PT 0", "PT 1", "PT 2", "PT 3".

5. INSTALAÇÃO DA SOUNDBAR

Alinhe as junções das duas partes e gire-as juntas até que fiquem firmemente conectadas.

Cuidado: Certifique-se de que a soundbar esteja desligada durante a montagem.

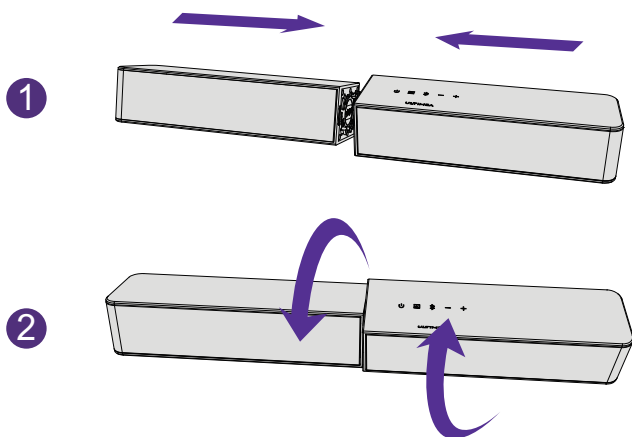

6. PAINEL TRASEIRO

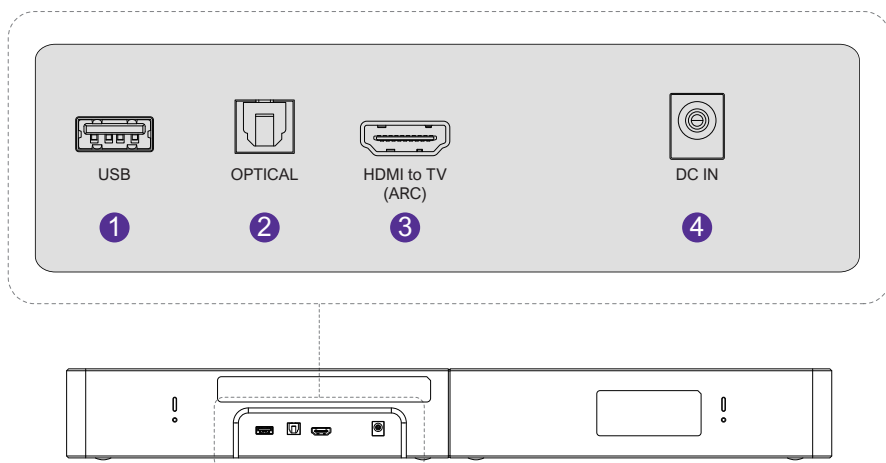

Nota: O USB suporta ficheiros MP3 ou FLAC.

7. POSICIONAMENTO DO SISTEMA

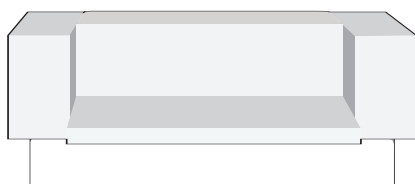
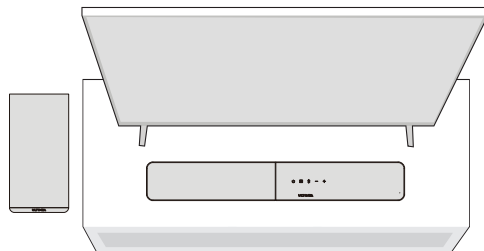

8. INSTALAÇÃO NA PAREDE

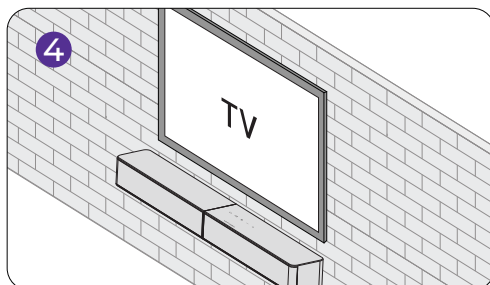
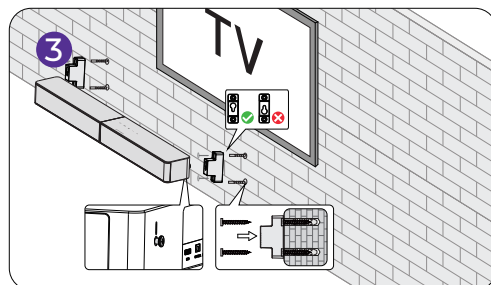
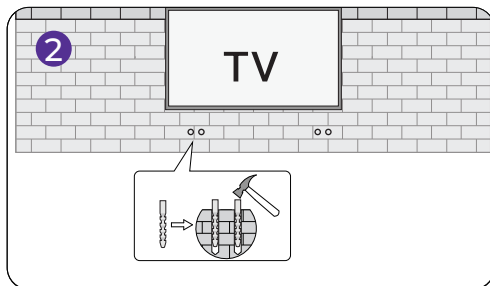
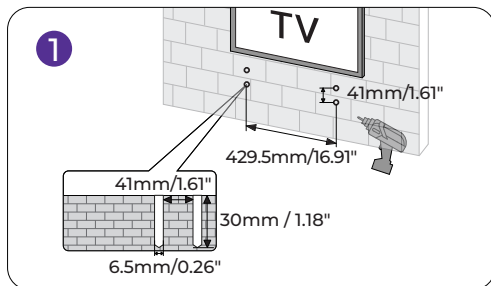

9. CONECTAR E LIGAR

- 1 Conecte o adaptador de energia da soundbar a uma tomada.

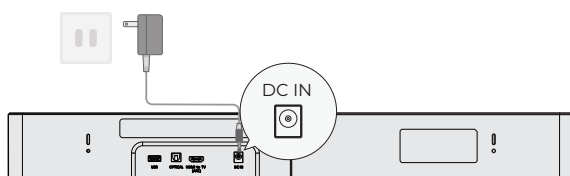

- 2 Conecte o cabo de alimentação do subwoofer a uma tomada.

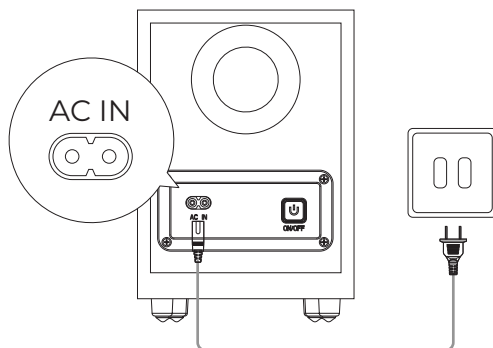

- 3 Nota: Recomenda-se usar pilhas alcalinas descartáveis. Pilhas recarregáveis não são recomendadas.

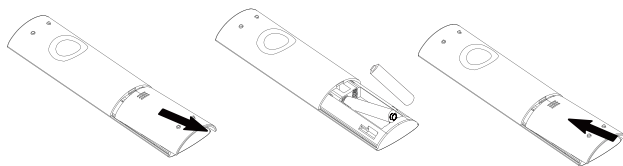

Baterias não incluídas.

10. CONECTAR À TV VIA HDMI ARC

- 1 Ligue uma extremidade do cabo HDMI à porta ARC na parte traseira da TV.

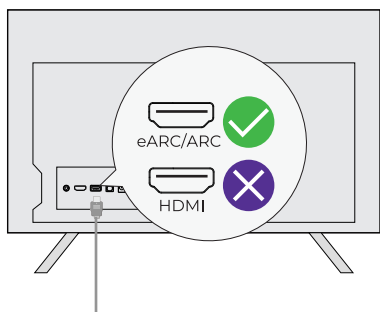

- 2 Ligue a outra extremidade do cabo HDMI à porta ARC da soundbar.

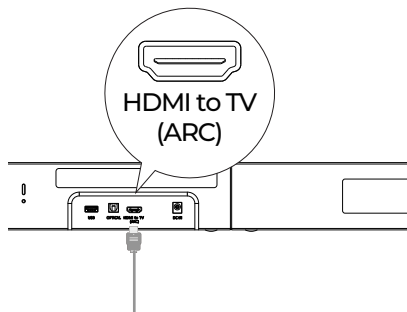

- 3 Prima o botão "Source" no comando para seleccionar a entrada "ARC".

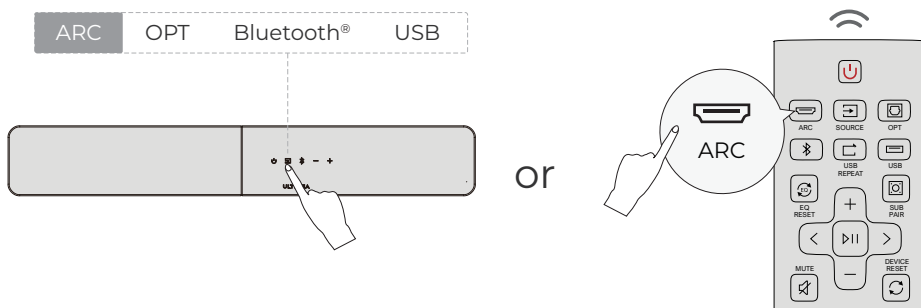

Se não houver som, tente definir a saída de áudio da TV para PCM: Definições da TV > Início > Definições > Som > Saída de Áudio Digital > PCM

HDMI ARC suporta transmissão de áudio bidirecional entre a sua TV e o sistema de áudio através de um único cabo HDMI.

Nota: Ative a função "CEC" na sua TV. Quando ARC estiver ligado, o comando remoto da TV pode controlar simultaneamente a soundbar e a TV: 1 Ligar/Desligar 2 Ajustar Volume

11. CONECTAR À TV VIA CABO ÓPTICO

- 1 Certifique-se de que a porta da TV seja OPTICAL OUT. Conecte ambas as extremidades do cabo óptico às portas OPTICAL da TV e da soundbar.

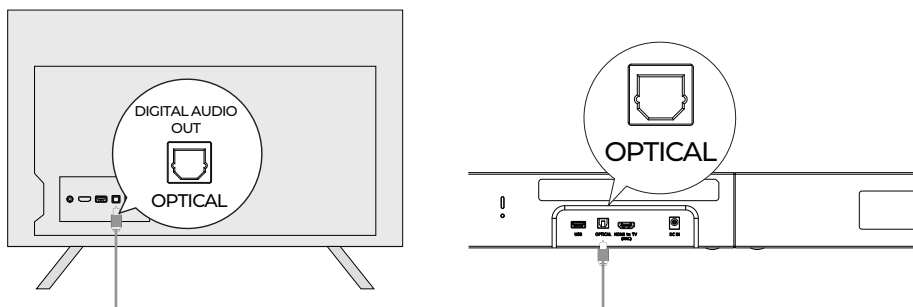

- 2 Certifique-se de que o conector óptico esteja inserido corretamente conforme mostrado na imagem. Não o insira ao contrário para evitar danos à porta óptica.
- 3 Configurações da TV > Início > Configurações > Som > Saída de Áudio Digital > PCM

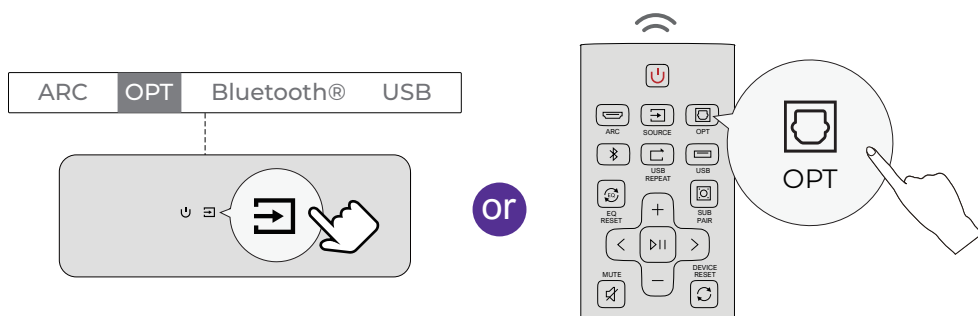

Nota: Se o áudio estiver sendo reproduzido pelos alto-falantes internos da TV, silencie a TV ou reduza o volume ao mínimo.

12. CONECTAR AO Bluetooth®

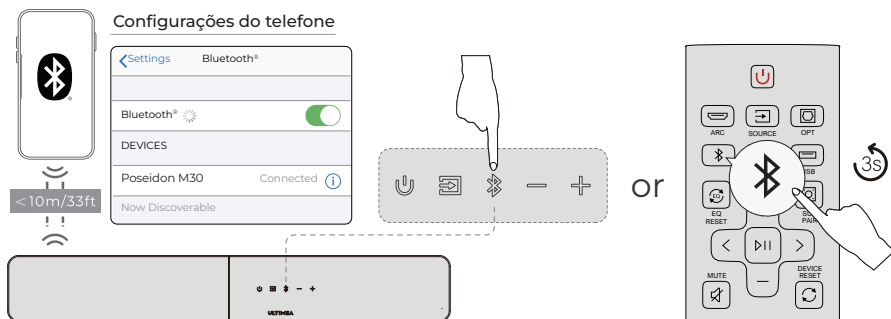

- 1 Pressione o botão "Bluetooth" na soundbar ou o botão "Bluetooth" no controle remoto para entrar no modo de pareamento Bluetooth®
- 2 Acesse as configurações de Bluetooth® do seu celular, encontre e selecione "Poseidon M30" para conectar a soundbar
- 3 Nota: Se já estiver no modo Bluetooth® e conectado, pressione e segure o botão "Bluetooth" por 3 segundos para desconectar o dispositivo atual e depois conecte manualmente um novo dispositivo no seu celular / PC / TV

13. REEMPARELHAR O SUBWOOFER

Normalmente, a soundbar e o subwoofer já vêm emparelhados de fábrica. Se a conexão for perdida, siga os passos abaixo para emparelhá-los novamente:

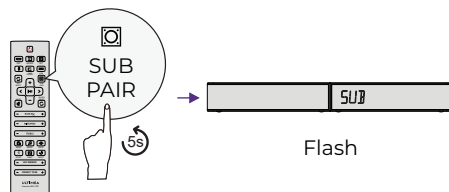

- 1 Prima sem soltar o botão "SUB PAIR" no controle remoto durante 5 segundos. O visor da unidade principal irá piscar "SUB" para indicar o modo de emparelhamento.

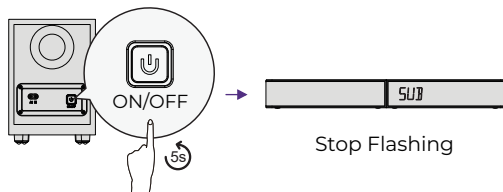

- 2 Prima sem soltar o botão ON/OFF na parte traseira do subwoofer durante 5 segundos para entrar no modo de emparelhamento.
- 3 Quando o emparelhamento for bem-sucedido, o visor da unidade principal deixará de piscar e a luz indicadora do subwoofer permanecerá acesa continuamente

14. RESTAURAR CONFIGURAÇÕES DE FÁBRICA

Prima sem soltar o botão **DEVICE RESET** durante 5 segundos para restaurar as definições de fábrica.

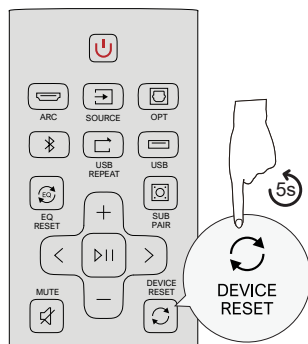

15. AJUSTAR O VOLUME DO SOM DE AVISO

Se o tom de aviso da soundbar estiver muito alto, você pode ajustar o volume usando o aplicativo **ULTIMEA**.

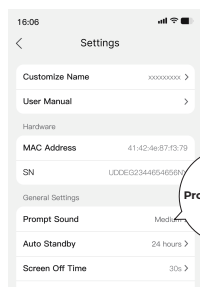
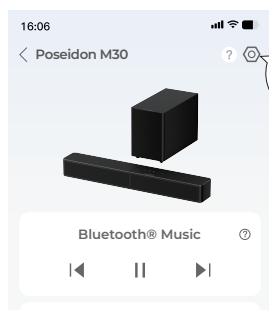

- 1 Escaneie o código QR para baixar o aplicativo ULTIMEA e depois adicione sua soundbar no aplicativo.
- 2 Abra a página Detalhes do dispositivo da soundbar, toque no ícone Configurações no canto superior direito e selecione "Prompt Sound Volume". Ajuste o nível conforme necessário.

Model Number	UC000
Power Supply	18V 2A DC(Soundbar); 100-240V~50/60Hz AC (Subwoofer)
Soundbar Drivers	Soundbar: 2.25" × 2, Subwoofer: 5.25"
Auto Standby	The soundbar will turn to standby mode if there is no audio signal for 15 minutes. You can set the standby time in the App
Standby Power	<0.5W
Operating Temperature	-10°C – 45°C / 14°F – 113°F
Bluetooth® Version	6.0

Soundbar	600 × 70 × 90 mm / 23.6" × 2.8" × 3.5"
Subwoofer	300 × 200 × 150 mm / 11.8" × 7.9" × 5.9"
Packaging	335 × 437 × 197 mm / 13.2" × 17.2" × 7.8"
Packaging Weight	5.8 kg / 12.8 lbs

USB Output	5V 500mA DC
Operating Altitude	2000 meters above sea level
Wall Mount Screw	4 × 35 mm / 0.2" × 1.4"
Bracket Screws Diameter	3 mm / 0.12"
Remote Control Battery Type	2 × AAA (NOT INCLUDED)
Notice: Risk of fire or explosion if the battery is replaced by an incorrect type.	

PROPER DISPOSAL INSTRUCTIONS



This mark shown on the product or its packaging, indicates that this product should not be disposed of with other household waste at the end of its working life. To prevent possible harm to the environment or human health from uncontrolled waste disposal, please separate this from other types of wastes and recycle it responsibly to promote the sustainable reuse of material resources.

WASTE ELECTRICAL & ELECTRONIC EQUIPMENT

Household user should contact either the retailer where they purchased this product, or their local government office, for details of where and how they can take this item for environmentally safe recycling. Business users should contact their suppliers and check the terms and conditions of the purchase contract. This product should not be mixed with other commercial wastes for disposal.

WIRELESS FREQUENCY RANGE AND WIRELESS OUTPUT POWER:

Frequency: 2.402GHz-2.48GHz

The Max. transmit power (Applies only to the EU): 10 dBm

FCC REGULATORY COMPLIANCE

Any changes or modifications not expressly approved by the party responsible for compliance could void the user's authority to operate the equipment.

This device complies with Part 15 of the FCC Rules.

Operation is subject to the following two conditions:

(1) This device may not cause harmful interference.

(2) This device must accept any interference received, including interference that may cause undesired operation.

NOTE: This equipment has been tested and found to comply with the limits for a Class B digital device, pursuant to part 15 of the FCC Rules. These limits are designed to provide reasonable protection against harmful interference in a residential installation. This equipment generates, uses, and can radiate radio frequency energy, and if not installed and used in accordance with the instructions, may cause harmful interference to radio communications.

However, there is no guarantee that interference will not occur in a particular installation. If this equipment does cause harmful interference to radio or television reception, which can be determined by turning the equipment off and on, the user is encouraged to try to correct the interference by one or more of the following measures:

- Reorient or relocate the receiving antenna.

- Increase the separation between the equipment and the receiver.

- Connect the equipment to an outlet on a circuit different from that to which the receiver is connected.

- Consult the dealer or an experienced radio / TV technician for help.

This equipment complies with FCC radiation exposure limits set forth for an uncontrolled environment. This equipment should be installed and operated with a minimum distance of 20cm between the radiator & your body. This transmitter must not be co-located or operating in conjunction with any other antenna or transmitter.

CE WARNINGS

(1) Do not install this equipment in a confined or building-in space such as a book case or similar unit, and remain a well ventilation conditions. The ventilation should not be impeded by covering the ventilation openings with items such as newspaper, table-cloths, curtains etc.

(2) WARNING: To reduce the risk of fire or electric shock, do not expose this apparatus to rain or moisture. The apparatus shall not be exposed to dripping or splashing and that objects filled with liquids, such as vases, shall not be placed on apparatus.

(3) WARNING: The adapter plug is used as disconnect device, the disconnect device shall remain readily operable.

(4) Frequency: 2.402GHz-2.48GHz

(5) The Max. transmit power: 10 dBm

 WARNING: This product can expose you to chemicals including lead, which is known to the State of California to cause cancer and birth defects or other reproductive harm. For more information, go to www.P65Warnings.ca.gov.

ISED WARNINGS

This device contains licence-exempt transmitter(s)/receiver(s) that comply with Innovation, Science and Economic Development Canada's licence-exempt RSS(s). Operation is subject to the following two conditions:

(1) This device may not cause interference.

(2) This device must accept any interference, including interference that may cause undesired operation of the device.

L'émetteur/récepteur exempt de licence contenu dans le présent appareil est conforme aux

CNR d'Innovation, Sciences et Développement économique Canada applicables aux appareils radio exempts de licence. L'exploitation est autorisée aux deux conditions suivantes :

1) L'appareil ne doit pas produire de brouillage;

2) L'appareil doit accepter tout brouillage radioélectrique subi, même si le brouillage est susceptible d'en compromettre le fonctionnement.

3) The device meets the exemption from the routine evaluation limits in issue6 of RSS 102 and compliance with RSS-102 RF exposure, users can obtain Canadian information on RF exposure and compliance.

Le dispositif rencontre l'exemption des limites courantes d'évaluation dans la numéro 6 de RSS 102 et la conformité à l'exposition de RSS-102 rf, utilisateurs peut obtenir l'information canadienne sur l'exposition et la conformité de rf.

This transmitter must not be co-located or operating in conjunction with any other antenna or transmitter. This equipment should be installed and operated with a minimum distance of 20 centimeters between the radiator and your body.

Cet émetteur ne doit pas être Co-placé ou ne fonctionnant en même temps qu'aucune autre antenne ou émetteur. Cet équipement devrait être installé et actionné avec une distance minimum de 20 centimètres entre le radiateur et votre corps.

Wireless Capability Description:

The subwoofer in the system is designed for wired connection and does not have the ability to transmit or receive wireless signals.

The remote control uses infrared (IR) technology for device control and does not support any other wireless signal transmission or reception capabilities.

 **CA WARNING:** Can expose you to BPA, a carcinogen, and BPA, a reproductive. toxicant. See www.P65Warnings.ca.gov.

ULTIMEA

Product Name: Soundbar
Model No.: UC000
Soundbar HVIN: UC000
Subwoofer HVIN: UC000B

EC REP Utimea GmbH
Buchenring 57, 22359 Hamburg, Germany

UK REP EVATOST CONSULTING LTD
Office 101 32 Threadneedle Street, London, United Kingdom, EC2R 8AY

@Utimea Inc. All rights reserved, registered in the United States and other countries. 801 S. Dupont Ave., Ste G, Ontario, CA, 91761, USA

Made in China
Manufacturer: Utimea Technology (Shenzhen) Limited
Address: 20th Floor, Building 4, Tianan Cloud Park, Bantian St., Longgang District, Shenzhen, China 518000

Manufacturer Contact Information:

+1 888-598-8875 (US) Mon-Fri 9am-5pm (PST) +49 89-628-25828 (EU) Mon-Fri 9am-5pm (CET) support@ultimea.com support.ultimea.com

If you need our support, kindly reach out to our service team. We are always glad to help.



Soundbar MIC ID: Subwoofer MIC ID:

FR 219-258296

FR 219-258295

PS E Shen Zhen Shi Xin Fei Yi
Ke Ji You Xian Gong Si



Warranty Extension Plan

EU DECLARATION OF CONFORMITY

We (Manufacturer is responsible for this declaration)
20th Floor, Building 4, Tianan Cloud Park, Bantian St.,
Declare under our sole responsibility that the product
Trade Mark: ULTIMEA
Product Name: Soundbar
Model No.: UC000

Utimea Technology (Shenzhen) Limited
Longgang District Shenzhen, China 518000

The product to which this declaration relates is in conformity with the essential requirements set out in the Council Directive on the Approximation of the laws of the Member States relating to the Radio Equipment Directive (2014/53/EU), the Restriction of Hazardous Substances Directive (2011/65/EU), the Electromagnetic Compatibility Directive (2014/30/EU), and the Low Voltage Directive (2014/35/EU). The product is responsible for affixing the CE marking, and the following standards were applied:

EN 55032:2015/A1:2020
EN 55035:2017/A11:2020
EN IEC 61000-3-2:2019/A2:2024
EN 61000-3-3:2013/A2:2021

ETSI EN 301 489-1 V2.2.3 (2019-11)
ETSI EN 301 489-17 V3.2.4 (2020-09)
ETSI EN 300 328 V2.2.2 (2019-07)
EN IEC 62311:2020
EN IEC 62368-1:2020+A11:2020

Full Name: Yoyo.Yu
Position: Approval Manager
Signature:
Place/Date: Shenzhen, China / Feb. 01-2026

Trade Marks:



The Bluetooth® word mark and logos are registered trademarks owned by Bluetooth SIG, Inc. and any use of such marks by Utimea Technology (Shenzhen) Limited. is under license. Other trademarks and trade names are those of their respective owners.



The terms HDMI, HDMI High-Definition Multimedia Interface, HDMI trade dress and the HDMI Logos are trademarks or registered trademarks of HDMI Licensing Administrator, Inc.