

ULTIMEA

Dolby Atmos

HDMI<sup>TM</sup>  
HIGH-DEFINITION MULTIMEDIA INTERFACE

Bluetooth<sup>®</sup>



# User Manual

Skywave F40

EN: User Manual

DE: Bedienungsanleitung

FR: Manuel d'utilisation

ES: Manual de usuario

IT: Manuale utente

PT: Manual do Usuário

NL: Gebruikershandleiding

PL: Instrukcja obsługi

SV: Användarmanual

TR: Kullanım Kılavuzu

JP: 取扱説明書

CN: 用户手册

TC: 使用者手冊

KO: 사용자 설명서

دليل المستخدم

Model No.: U4122

5.1.2 Channel Dolby Atmos Soundbar

## 1 IMPORTANT SAFETY INSTRUCTIONS

- Please read and keep these instructions. Follow all warnings and operate according to the instructions.
- Do not use the device near water, in damp environments, or in the rain. Avoid spilling liquids on the device or placing objects containing liquids (such as vases) on top of it.
- Clean only with a dry cloth. Do not use liquid cleaners.
- Do not block ventilation openings or install the device in a confined space. Ensure proper ventilation and install the device according to the manufacturer's instructions.
- Do not install the device near heat sources such as radiators, stoves, amplifiers, or other devices that produce heat. Do not cover the ventilation openings with items like newspapers or curtains.
- Only use attachments, stands, or accessories specified by the manufacturer. When using equipment with wheels, exercise caution when moving to prevent tipping.
- Protect the power cord from being walked on, pinched, or bent, especially at plugs, convenience receptacles, and the point where they exit from the device.
- Do not modify the plug's polarization or grounding features. If the plug does not fit into the outlet, consult an electrician to replace the outlet.
- Unplug the power cord during lightning storms or when not in use for long periods. To completely disconnect the device from the power supply, unplug it from the wall outlet and ensure the plug is easily accessible.
- Do not place any open flame sources, such as lit candles, on the device.
- Do not attempt to open the device. High voltage inside may cause electric shock or death. There are no user-serviceable parts inside. All servicing must be performed by qualified personnel.
- The installation height of the device must not exceed 2 meters.

## 2 ACCESSORIES LIST

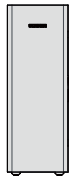

Subwoofer



Left subunit & Right subunit

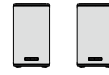

Surround Speaker x2

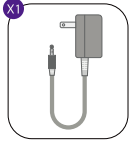

Soundbar Power Adapter (2m / 78")



Surround Power Adapter (3m / 118")

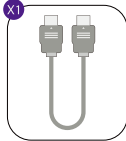

HDMI Cable (1.5m / 59")

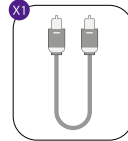

Digital Optical Cable (1.5m / 59")

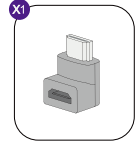

90-Degree HDMI Converter

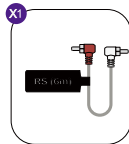

Surround Connection Cable (6m / 236")



Remote Control

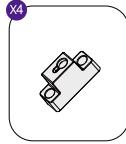

Wall Bracket X4

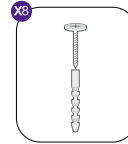

Wall Mounting Kits X8

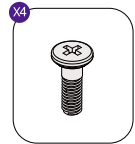

Mounting Screw X4

## 3 SOUNDBAR CONTROLS

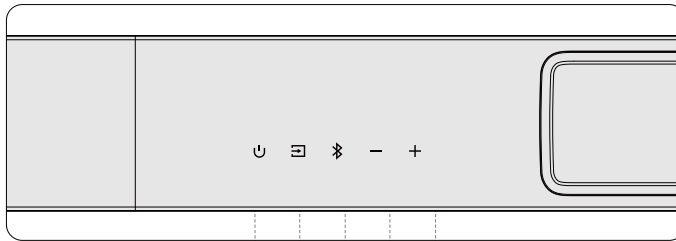

1 2 3 4 5

### Control Panel

- 1 "⏻": **Power Button**  
Press to power on / standby.
- 2 "📺": **Source**  
Press to switch channels: eARC-OPT(OPTICAL)-BT-USB.
- 3 "🔗": **Bluetooth**  
Press to switch to BT channel and enter pairing mode. Hold for 3 seconds to disconnect current device and choose to connect to a new device manually on your mobile phone / PC / TV (BT ID: Skywave F40).
- 4 "⏮": **Volume Down**
- 5 "⏭": **Volume Up**

## Remote Control

- 1 "⏻": **Power Button**  
Press to power on / standby.
- 2 "📺": **SOURCE**  
Press to switch channels.
- 3 "eARC": **eARC**  
Press to switch to HDMI eARC channel.
- 4 "🔍": **OPT**  
Press to switch to OPTICAL channel.
- 5 "📶": **BT**  
Press to switch to BLUETOOTH channel.
- 6 "🔄": **USB REPEAT**  
Press to switch between one track looping and all list looping.
- 7 "📶": **USB**  
Press to switch to USB channel.
- 8 "EQ": **EQ RESET**  
Press to bring all EQ Presets back to default.
- 9 "X": **Xupmix**  
The default setting is "on," allowing for unified control over the activation and deactivation of 6 sound effect modes.  
Xupmix on: The surround channel sound will be provided by a rich multi-channel signal processed by the algorithm, offering a more immersive auditory experience.  
Xupmix off: The surround channel sound will be optimized based on the left and right channel signals using an algorithm, resulting in a broader sound field effect.
- 10 "+": **Volume Up**
- 11 "-": **Volume Down**
- 12 "<": **Previous**  
For BT and USB mode only: Skip to previous track.
- 13 ">": **Next**  
For BT and USB mode only: Skip to next track.
- 14 "⏸": **Play / Pause**  
For BT and USB mode only.
- 15 "🔇": **MUTE**
- 16 "💡": **LED DIMMER**  
Press to adjust display brightness in 5 levels. Press and hold for 3s to turn off the LED display.
- 17 "BASS": **BASSMX**  
Press to adjust bass level, the display will show: "B5-6", "B5-5", "B5-4", "B5-3", "B5-2", "B5-1", "B5 0", "B5 1", "B5 2", "B5 3", "B5 4", "B5 5", "B5 6".
- 18 "MIDRANGE": **MIDRANGE**  
Press to adjust alto level, the display will show: "MR-6", "MR-5", "MR-4", "MR-3", "MR-2", "MR-1", "MR 0", "MR 1", "MR 2", "MR 3", "MR 4", "MR 5", "MR 6".
- 19 "TREBLE": **TREBLE**  
Press to adjust treble level, the display will show: "TJ-6", "TJ-5", "TJ-4", "TJ-3", "TJ-2", "TJ-1", "TJ 0", "TJ 1", "TJ 2", "TJ 3", "TJ 4", "TJ 5", "TJ 6".
- 20 "🎬": **MOVIE**  
Press to switch to MOVIE mode, the display will show: "MOVI".
- 21 "🎵": **MUSIC**  
Press to switch to MUSIC mode, the display will show: "MUSC".
- 22 "🎧": **VOICE**  
Press to switch to VOICE mode, the display will show: "VOIC".
- 23 "🏃": **SPORT**  
Press to switch to SPORT mode, the display will show: "SPRT".
- 24 "🎮": **GAME**  
Press to switch to GAME mode, the display will show: "GAME".
- 25 "🌙": **NIGHT**  
Press to switch to NIGHT mode, the display will show: "NIGT".
- 26 "SURROUND": **SURROUND**  
Press to adjust surround sound level, the display will show: "SR-6", "SR-5", "SR-4", "SR-3", "SR-2", "SR-1", "SR 0", "SR 1", "SR 2", "SR 3", "SR 4", "SR 5", "SR 6".
- 27 "UP-FIRING": **UP-FIRING**  
Press to display the current sky unit volume.

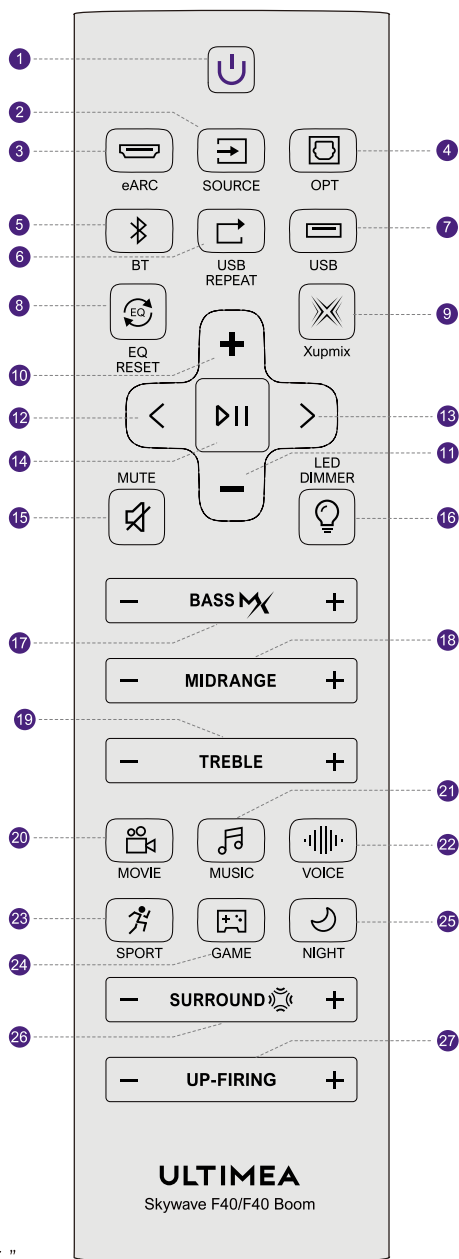

## 4 SOUNDBAR INSTALLATION

Align the joints of the two parts and twist to connect.

Caution: Please operate without powering on.

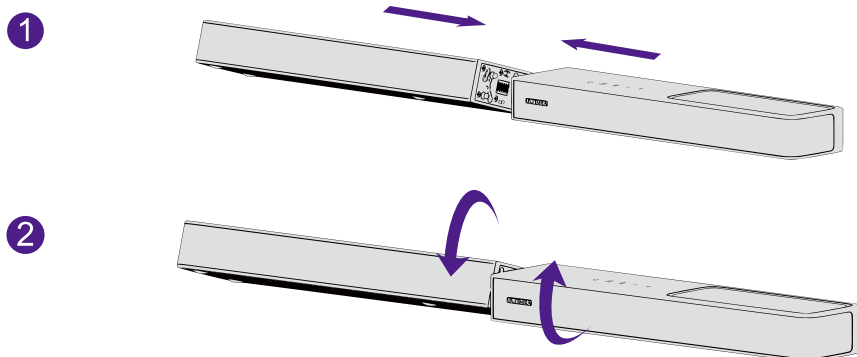

## 5 ERAR PANEL

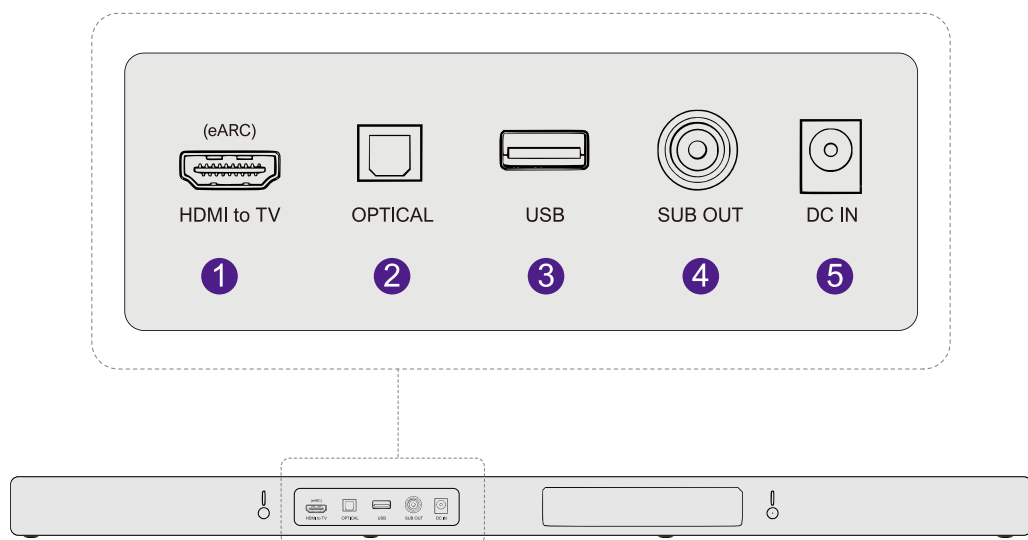

① HDMI TO TV(EARC)

④ SUB OUT

② OPTICAL

⑤ DC IN

③ USB

SUPPORT MP3 OR FLAC FILES

## 6 PLACEMENT OPTIONS

### Horizontal placement

Note: The soundbar should be placed at or near ear level.

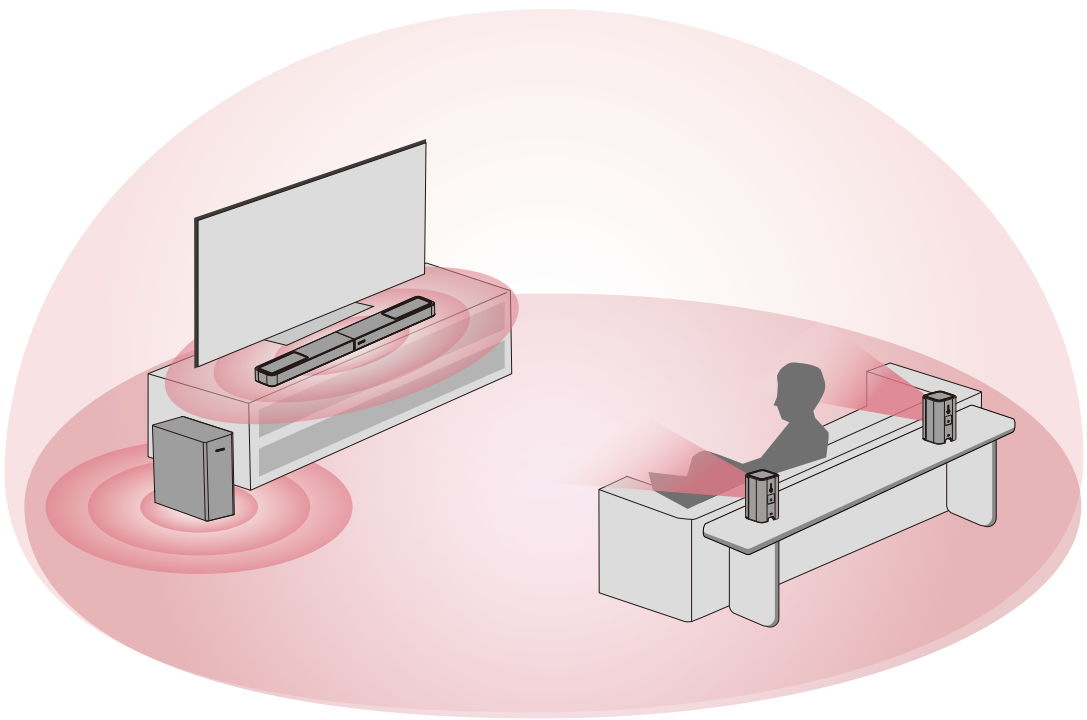

## 7 WALL MOUNT INSTALLATION

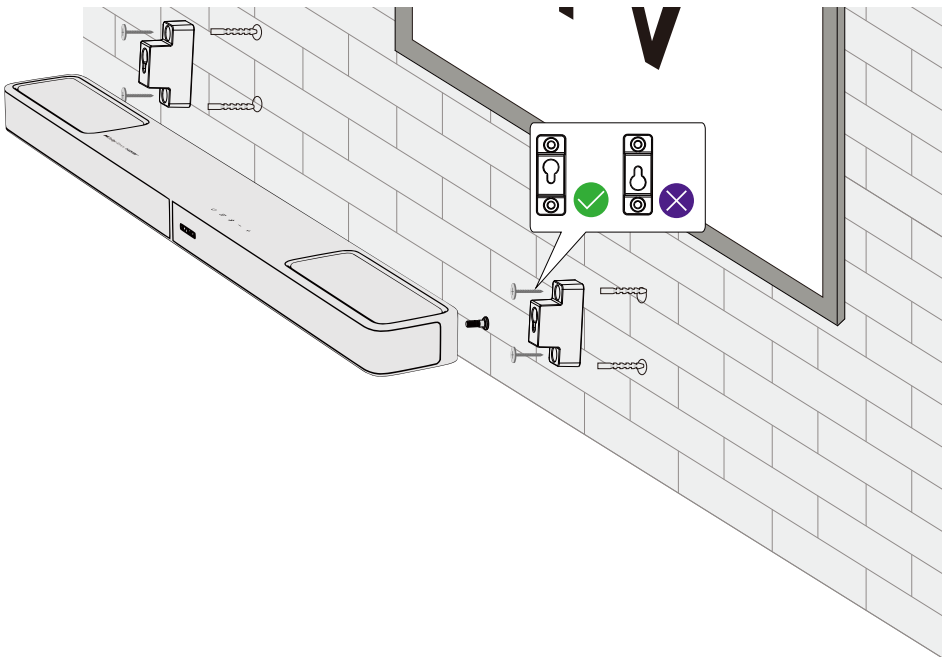

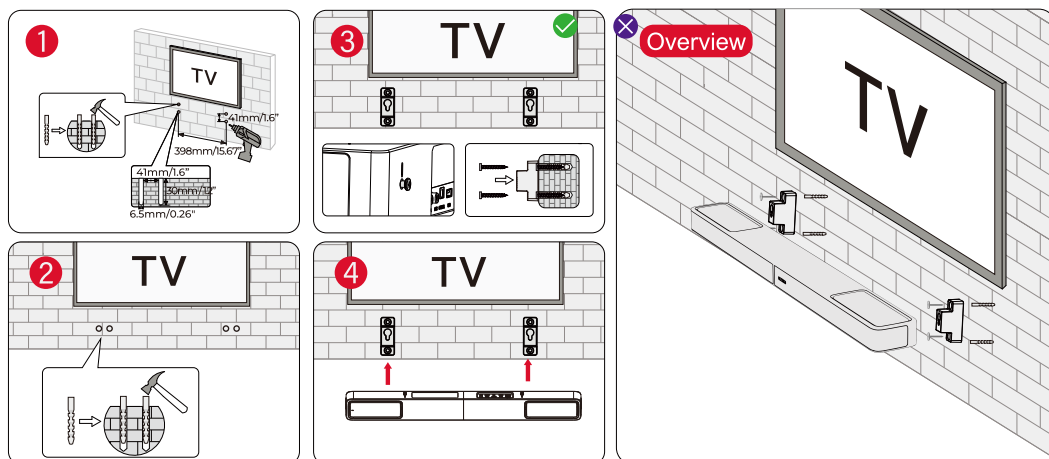

## 8 CONNECT AND POWER ON

- 1 Connect the Soundbar to the “DC IN” port using the power adapter, and plug it into a power outlet.

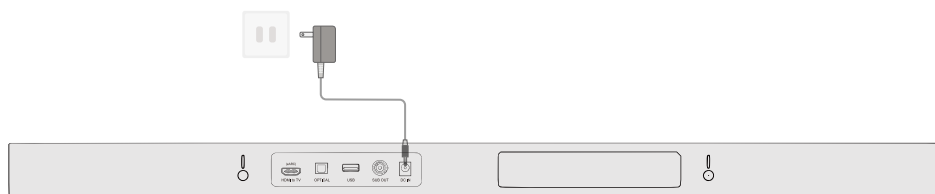

- 2 Use the RCA cable to connect the two surround speakers. Insert the red plug into the left surround speaker and the white plug into the right surround speaker. Then power the surround speakers using their dedicated power adapter.

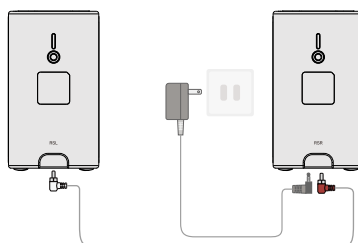

- 3 Connect the RCA plug on the subwoofer to the “SUB OUT” port on the Soundbar.

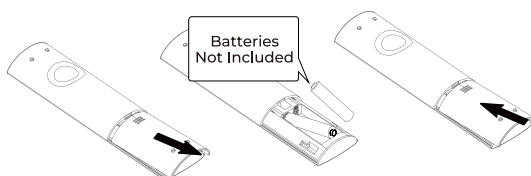

- 4 Insert batteries into the remote control before use.

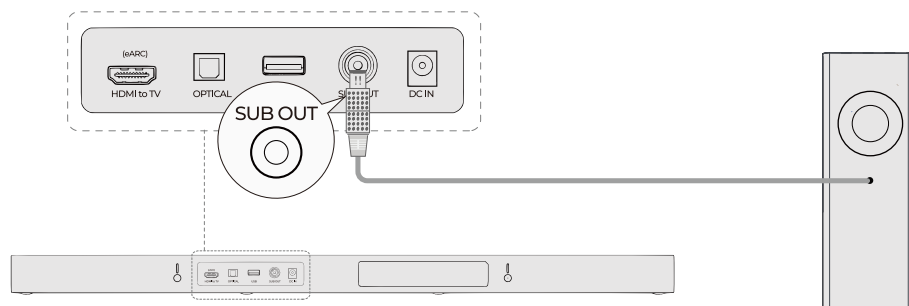

## 9 CONNECT TO TV VIA HDMI OUT ARC

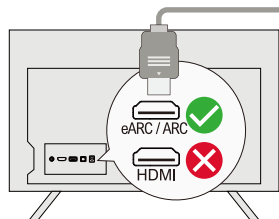

**Step 1:**

Connect one end of the HDMI cable to the eARC / ARC port on the back of your TV.

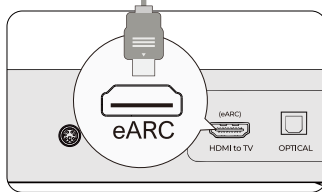

**Step 2:**

Then connect the other end into the eARC port of the soundbar.

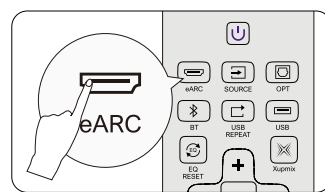

**Step 3:**

Press "eARC" button on the remote control to select "eARC" input.

**Note:**

**Make sure your TV HDMI supports eARC, otherwise the Dolby Atmos audio signal cannot be transmitted.**

**Dolby Atmos:** If you are watching a movie in the Dolby Atmos format, please set the audio output on your TV to Pass Through:

TV Settings > Home > Settings > Sound > Digital Audio Output > Pass Through

**DTS:** If you are watching a movie in the DTS format, please set the audio output on your TV to PCM:

TV Settings > Home > Settings > Sound > Digital Audio Output > PCM

**What's the difference between: HDMI IN, HDMI ARC, HDMI eARC?**

**HDMI IN** is a standard HDMI input that allows you to connect devices to your TV or audio system. It supports audio and video signals, but it does not support audio return channel (ARC) or enhanced audio return channel (eARC) functionality.

**HDMI ARC** is a special HDMI port that supports two-way communication between your TV and audio system. This means that audio can be sent from your TV to your audio system, and audio system can send audio back to your TV.

**HDMI eARC** (Enhanced Audio Return Channel) is an updated version of HDMI ARC that supports higher quality audio formats such as Dolby Atmos and DTS:X.

**Note: Please turn on the "CEC" function on your TV.**

When eARC / ARC is connected, your TV remote control can control the soundbar and TV simultaneously: ① Turn on / standby ② Adjust the volume



## 10 CONNECT TO TV VIA OPTICAL CABLE

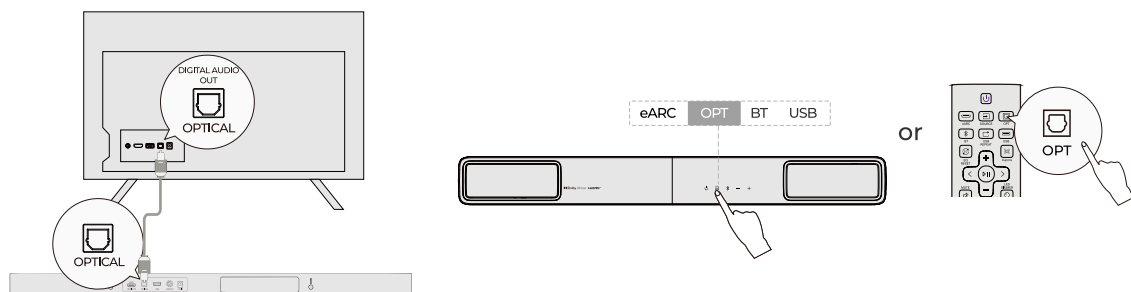

- 1 Make sure the TV's port is OPTICAL OUT, connect both sides of the cable to OPTICAL, for both the TV and the soundbar.
- 2 Make sure the optical plug is inserted correctly as it shows in the picture. Do not insert the plug upside down and break the optical.

**Note:** If audio is playing from the internal TV speakers, mute or minimize the TV volume.

**In Optical Mode: Please set the TV audio output to PCM:** TV Settings > Home > Settings > Sound > Digital Audio Output > PCM

## 11 CONNECT TO BLUETOOTH

- 1 Press the “” button on the soundbar or press the “” button on the remote control to enter Bluetooth pairing mode.
- 2 Go to the Bluetooth setting on your phone, find and select “**Skywave F40**” to connect the soundbar.
- 3 Note: If it's already in the Bluetooth mode and connected, press and hold “” button for 3 seconds to disconnect current device and choose to connect to a new device manually on your mobile phone / PC / TV.

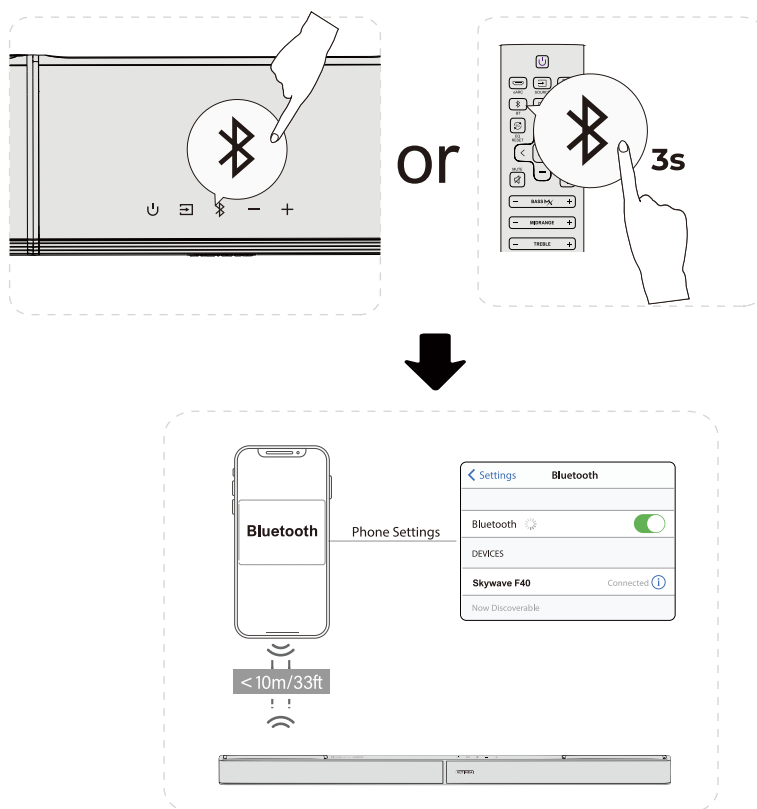

## 12 RE-PAIR SURROUND

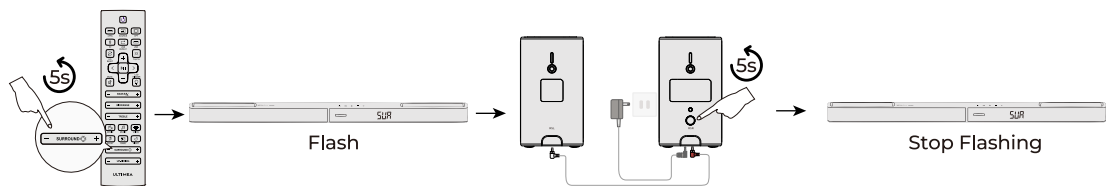

**Normally, the Soundbar and subwoofer are pre-paired. If the connection is lost, please follow the steps below to re-pair them:**

- 1 Press and hold the center "Surround" button on the remote control for 5 seconds. The main unit display will flash "SUB" to indicate pairing mode.
- 2 Press and hold the pairing button on the back of the subwoofer for 5 seconds to enter pairing mode.
- 3 When pairing is successful, the main unit display will stop flashing and the subwoofer indicator light will remain steadily on.

## 13 SPECIFICATIONS

<b>Model Number</b>	U4122
<b>Power Supply</b>	DC 24V $\Rightarrow$ 3A(Soundbar) / DC 14V--1A(Surround)
<b>Soundbar Drivers</b>	Soundbar:3.4" x1.5" x 3 + 1.75" x 2 , Surround: 2" x 2, Subwoofer: 5.25" x 1
<b>Frequency Response</b>	45Hz - 20kHz (-6dB)
<b>Auto Standby</b>	The sounddbar will turn to standby mode if there is no audio signal for 15 minutes. You can set the standby time in the App
<b>Standby Power</b>	<0.5W
<b>Operating Temperature</b>	-10 C -45 C / 14°F-113°F
<b>Bluetooth Version</b>	5.4

<b>Soundbar</b>	800 x 46 x 90 mm / 31.5" x 1.81" x 3.54"
<b>Subwoofer</b>	106 x 282 x 317 mm / 4.17" x 11.10" x 12.48"
<b>Surround Speaker</b>	69 x 120 x 69 mm / 2.72" x 4.72" x 2.72"
<b>Packaging</b>	330 x 440 x 190 mm / 12.99" x 17.32" x 7.48"
<b>Net Weight</b>	6.2 kg / 13.67 lbs
<b>Gross Weight</b>	7.0 kg / 15.43 lbs

# IMPORTANT SAFETY INSTRUCTIONS

1. READ these instructions.
2. KEEP these instructions.
3. HEED all warnings.
4. FOLLOW all instructions.
5. DO NOT use this apparatus near water.
6. CLEAN ONLY with dry cloth.
7. DO NOT block any ventilation openings. Install in accordance with the manufacturer's instructions.
8. DO NOT install near any heat sources such as radiators, heat registers, stoves, or other apparatus (including amplifiers) that produce heat.
9. DO NOT defeat the safety purpose of the polarized or grounding type plug. A polarized plug has two blades with one wider than the other. A grounding type plug has two blades and a third grounding prong. The wider blade or the third prong are provided for your safety. If the provided plug does not fit into your outlet, consult an electrician for replacement of the obsolete outlet.
10. PROTECT the power cord from being walked on or pinched, particularly at plugs, convenience receptacles, and the point where they exit from the apparatus.
11. ONLY USE attachments/accessories specified by the manufacturer.
12. CAUTION: Use only with a cart, stand, tripod, bracket, or table specified by the manufacturer, or sold with the apparatus. When a cart is used, use caution when moving the cart/apparatus combination to avoid injury from tip-over. Use with other equipment or carts may result in instability causing injury.
13. UNPLUG this apparatus during lightning storms or when unused for long periods of time.
14. REFER all servicing to qualified service personnel. Servicing is required when the apparatus has been damaged in any way, such as power-supply cord or plug is damaged, liquid has been spilled or objects have fallen into the apparatus, the apparatus has been exposed to rain or moisture, does not operate normally, or has been dropped.
15. DO NOT expose this apparatus to dripping or splashing and ensure that no objects filled with liquids, such as vases, are placed on the apparatus.
16. To completely disconnect this apparatus from the AC Mains, disconnect the power supply cord plug from the AC receptacle.
17. Where the mains plug, an appliance coupler or adapter plug is used as the disconnect device, the disconnect device shall remain readily operable.
18. WARNING- DO NOT install this equipment in a confined or building-in space such as a book case or similar unit, and remain a well ventilation conditions. The ventilation should not be impeded by covering the ventilation openings with items such as newspaper, table-cloths, curtains etc.
19. WARNING- To reduce the risk of fire or electric shock, do not expose this apparatus to rain or moisture. The apparatus shall not be exposed to dripping or splashing and that objects filled with liquids, such as vases, shall not be placed on apparatus.
20. WARNING- Do Not Open! Risk of Electrical Shock. Voltages in this equipment are hazardous to life. No user-serviceable parts inside. Refer all servicing to qualified service personnel. Place the equipment near a main power supply outlet and make sure that you can easily access the power breaker switch.
21. No naked flame sources – such as lighted candles – should be placed on the product.
22. Product is to be mounted at a maximum height of 2 m.

# PROPER DISPOSAL INSTRUCTIONS

 This mark shown on the product or its packaging, indicates that this product should not be disposed of with other household waste at the end of its working life.  
To prevent possible harm to the environment or human health from uncontrolled waste disposal, please separate this from other types of wastes and recycle it responsibly to promote the sustainable reuse of material resources.

# Waste Electrical & Electronic Equipment

Household user should contact either the retailer where they purchased this product, or their local government office, for details of where and how they can take this item for environmentally safe recycling.  
Business users should contact their suppliers and check the terms and conditions of the purchase contract. This product should not be mixed with other commercial wastes for disposal.

# WIRELESS FREQUENCY RANGE AND WIRELESS OUTPUT POWER:

Frequency: 2.402GHz-2.48GHz  
The Max. transmit power (Applies only to the EU): 10 dBm

# FCC REGULATORY COMPLIANCE

Any changes or modifications not expressly approved by the party responsible for compliance could void the user's authority to operate the equipment.  
This device complies with Part 15 of the FCC Rules.  
Operation is subject to the following two conditions:  
(1) This device may not cause harmful interference.  
(2) This device must accept any interference received, including interference that may cause undesired operation.  
NOTE: This equipment has been tested and found to comply with the limits for a Class B digital device, pursuant to part 15 of the FCC Rules. These limits are designed to provide reasonable protection against harmful interference in a residential installation. This equipment generates, uses, and can radiate radio frequency energy, and if not installed and used in accordance with the instructions, may cause harmful interference to radio communications.  
However, there is no guarantee that interference will not occur in a particular installation. If this equipment does cause harmful interference to radio or television reception, which can be determined by turning the equipment off and on, the user is encouraged to try to correct the interference by one or more of the following measures:  
- Reorient or relocate the receiving antenna.  
- Increase the separation between the equipment and the receiver.  
- Connect the equipment to an outlet on a circuit different from that to which the receiver is connected.  
- Consult the dealer or an experienced radio / TV technician for help.  
This equipment complies with FCC radiation exposure limits set forth for an uncontrolled environment. This equipment should be installed and operated with a minimum distance of 20cm between the radiator & your body. This transmitter must not be co-located or operating in conjunction with any other antenna or transmitter.

# ISED WARNINGS

This device contains licence-exempt transmitter (s) / receiver (s) that comply with Innovation, Science and Economic Development Canada's licence-exempt RSS (s). Operation is subject to the following two conditions:  
(1) This device may not cause interference.  
(2) This device must accept any interference, including interference that may cause undesired operation of the device.  
The device meets the exemption from the routine evaluation limits in issue 6 of RSS 102 and compliance with RSS-102 RF exposure, users can obtain Canadian information on RF exposure and compliance.

This transmitter must not be co-located or operating in conjunction with any other antenna or transmitter. This equipment should be installed and operated with a minimum distance of 20 centimeters between the radiator and your body.

Cet appareil contient des émetteurs/récepteurs exempts de licence qui sont conformes aux CNR d'Innovation, Sciences et Développement économique Canada. Son fonctionnement est soumis aux deux conditions suivantes :

(1) Cet appareil ne doit pas causer d'interférences.

(2) Cet appareil doit accepter toute interférence, y compris les interférences qui peuvent entraîner un fonctionnement indésirable de l'appareil.

Le dispositif rencontre l'exemption des limites courantes d'évaluation dans la numéro 6 de RSS 102 et la conformité à l'exposition de RSS-102 rf, utilisateurs peut obtenir l'information canadienne sur l'exposition et la conformité de rf.

Cet émetteur ne doit pas être Co-placé ou ne fonctionnant en même temps qu'aucune autre antenne ou émetteur. Cet équipement devrait être installé et actionné avec une distance minimum de 20 centimètres entre le radiateur et votre corps.

**⚠ WARNING:** This product can expose you to chemicals including lead, which is known to the State of California to cause cancer and birth defects or other reproductive harm. For more information, go to [www.P65Warnings.ca.gov](http://www.P65Warnings.ca.gov).

## EU Declaration of Conformity

We (Manufacturer is responsible for this declaration)  
Ultimea Technology (Shenzhen) Limited  
(Company name)

20th Floor, Building 4, Tianan Cloud Park, Bantian St.,  
Longgang District Shenzhen, China 518000  
(Company address)

Declare under our sole responsibility that the product  
Trade Mark: ULTIMEA  
Product Name: Soundbar  
Model No.: U4122

To which this declaration relates is in conformity with the essential requirement set out in the Council Directive on the Approximation of the laws of the Member States relating to RED Directive (2014/53/EU) & RoHS (2011/65/EU) product is responsible to affix CE marking, the following standards were applied:

- EN 55032:2015/A1:2020
- EN 55035:2017/A11:2020
- EN IEC 61000-3-2:2019/A1:2021
- EN 61000-3-3:2013/A2:2021
- ETSI EN 301 489-1 V2.2.3 (2019-11)
- ETSI EN 301 489-17 V3.2.4 (2020-09)
- ETSI EN 300 328 V2.2.2 (2019-07)
- EN 50663: 2017
- EN IEC 62368-1:2020+A11:2020
- IEC 62321-3-1:2013
- IEC 62321-4:2013+A1:2017
- IEC 62321-5:2013
- IEC 62321-6:2015
- IEC 62321-7-1:2015
- IEC 62321-7-2:2017
- IEC 62321-8:2017

# ULTIMEA

Product Name: Soundbar  
Model No.: U4122

EC	REP	Ultimea GmbH Buchenring 57, 22359 Hamburg, Germany
UK	REP	EVATOST CONSULTING LTD Office 101 32 Threadneedle Street, London, United Kingdom, EC2R 8AY

@Dyanic Inc. All rights reserved, registered in the United States and other countries.9804 Crescent Center Drive, Suite 604, Rancho Cucamonga, CA 91730

Made in China  
Manufacturer: Ultimea Technology (Shenzhen) Limited  
Address: 20th Floor, Building 4, Tianan Cloud Park, Bantian St.,Longgang District, Shenzhen, China 518000

Full Name: Yoyo.Yu  
Position: Approbation Manager  
Signature:   
Place/Date: Shenzhen, China / Apr. 15-2025

## Trade Marks:



Dolby, Dolby Atmos, and the double-D symbol are registered trademarks of Dolby Laboratories Licensing Corporation. Manufactured under license from Dolby Laboratories. Confidential unpublished works. Copyright © 2012–2025 Dolby Laboratories. All rights reserved.





The Bluetooth® word mark and logos are registered trademarks owned by Bluetooth SIG, Inc. and any use of such marks by Ultimea Technology (Shenzhen) Limited. is under license. Other trademarks and trade names are those of their respective owners.



The terms HDMI, HDMI High-Definition Multimedia Interface, HDMI trade dress and the HDMI Logos are trademarks or registered trademarks of HDMI Licensing Administrator, Inc.

Manufacturer Contact Information:

+1 888-598-8875 (US)  
Mon-Fri 9am-5pm (PST)  
+49 89-628-25828 (EU)  
Mon-Fri 9am-5pm (CET)

 [support@ultimea.com](mailto:support@ultimea.com)  
 [support.ultimea.com](https://support.ultimea.com)

Contact our service team for support. We're glad to help.



Download Ultimea App



Search for "ULTIMEA" on social media.

