

ULTIMEA

Dolby Atmos

HDMI™
HIGH DEFINITION MULTIMEDIA INTERFACE

Bluetooth®



User Manual

Nova S50

EN: User Manual

DE: Benutzerhandbuch

JP: ユーザーマニュアル

FR: Manuel de l'utilisateur

IT: Manuale d'uso

ES: Manual del usuario

Model No.: U2120
Nova S50 2.1 Channel Virtual Atmos Soundbar

Contents

01	User Manual	English
	Connection and Installation	02
05	Benutzerhandbuch	Deutsch
	Anschluss und Installation	06
09	ユーザーマニュアル	日本語
	接続と設置	10
13	Mode d'Emploi	Français
	Raccordement et installation	14
17	Manuale d'uso	Italiano
	Connessione e installazione	18
21	Manual del usuario	Español
	Conexión e instalación	22

User Manual

WE ARE
READY
TO HELP



support@ultimea.com



Model No.: U2120

Prefer video tutorial?

Setup guidance video, USER MANUAL or Trouble Shooting on ULTIMEA website.

@ultimea_official



support.ultimea.com

+1 888-598-8875 (US) Mon-Fri 9am-5pm (PST)
 +49 89-628-25828 (EU) Mon-Fri 9am-5pm (CET)

1 ACCESSORIES LIST



Subwoofer



Soundbar



Power Adaptor



Stereo 3.5mm to 3.5mm Audio Cable



HDMI Cable

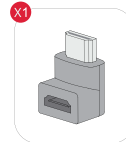

HDMI Adaptor

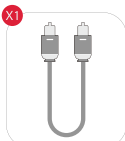

Digital Optical Cable



Remote Control

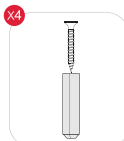

Wall Mounted Kit

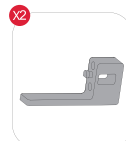

Wall Bracket



User Manual

2 SOUNDBAR CONTROLS

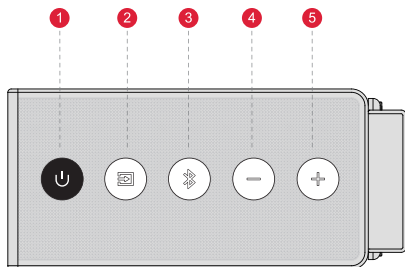

Control Panel

- 1 : **Power Button**
Press to power on / Hold for 3 seconds to power off.
- 2 : **Input Mode**
Press to switch channels: eARC-OPT-BT-AUX-USB.
- 3 : **BT**
Press to switch to Bluetooth channel and enter pairing mode. Hold for 3 seconds to disconnect the current device and connect to a new device manually on your mobile phone / PC / TV (BT ID: Nova S50).
- 4 : **Volume Down**
- 5 : **Volume Up**

Remote Control

- 1 "U": **Power Button**
Press to power on / Hold for 3 seconds to power off.
- 2 "eARC": **eARC**
Press to switch to HDMI eARC channel.
- 3 "BT": **BT**
Press to switch to Bluetooth channel and enter pairing mode. Hold for 3 seconds to disconnect the current device and connect to a new device manually on your mobile phone / PC / TV (BT ID: Nova S50).
- 4 "OPT": **OPT**
Press to switch to OPTICAL channel.
- 5 "AUX": **AUX**
Press to switch to AUX channel.
- 6 "USB": **USB**
Press to to switch to USB channel.
- 7 "LED": **LED**
Press to turn on the LED, press again to turn off.
- 8 "+": **Volume Up**
- 9 "-": **Volume Down**
- 10 "<": **Previous**
For BT and USB mode only: Skip to previous track.
- 11 ">": **Next**
For BT and USB mode only: Skip to next track.
- 12 "Play / Pause": **Play / Pause**
For BT and USB mode only.
USB mode: Hold for 3 seconds to switch between single loop playback and list loop playback.
- 13 "MOVIE": **MOVIE**
Press to switch to MOVIE mode.
- 14 "GAME": **GAME**
Press to switch to GAME mode.
- 15 "MUSIC": **MUSIC**
Press to switch to MUSIC mode.
- 16 "BASS MX": **BASSMX™**
Press to adjust bass level, the display will show: "B5-1", "B5 0", "B5 1".
- 17 "Mute / Recover the volume."

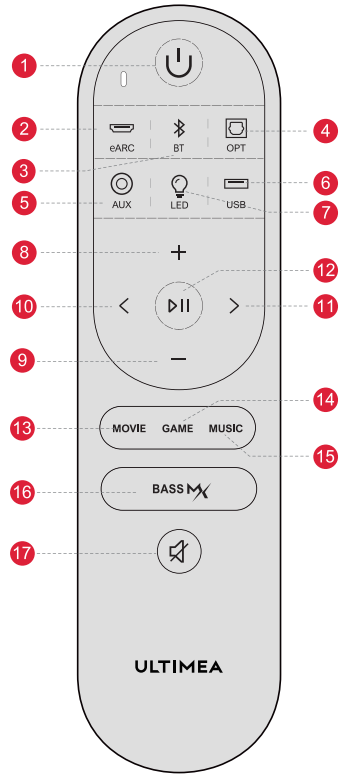

3 CONNECT TO SUBWOOFER

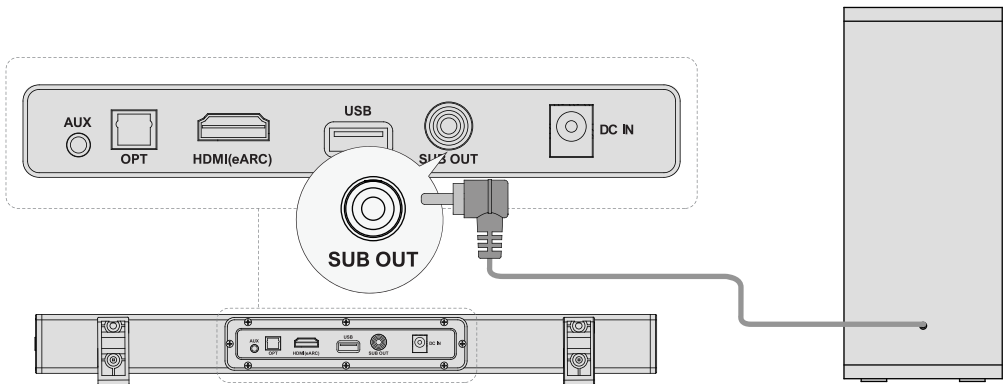

4 CONNECT TO TV VIA HDMI eARC / ARC

EN

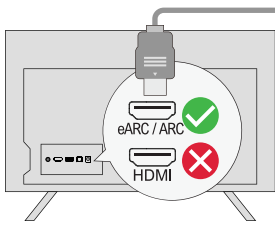

Step 1:
Connect one end of the HDMI cable to the eARC / ARC port on the back of your TV.

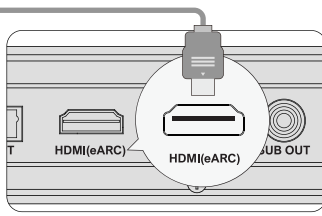

Step 2:
Then connect the other end to the HDMI(eARC) port of the soundbar.

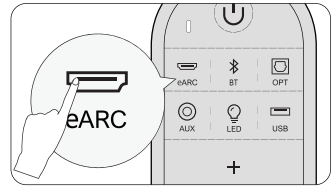

Step 3:
Press "eARC" button on the remote control to select "HDMI(eARC)" input.

Note:

Make sure your TV HDMI supports eARC, otherwise the Dolby Atmos audio signal cannot be transmitted.

Atmos: If you are watching a movie in the Dolby Atmos format, please set the audio output on your TV to Pass Through:

TV Settings > Home > Settings > Sound > Digital Audio Output > Pass Through

DTS: If you are watching a movie in the DTS format, please set the audio output on your TV to PCM:

TV Settings > Home > Settings > Sound > Digital Audio Output > PCM

What's the difference between: HDMI IN, HDMI ARC, HDMI eARC?

HDMI IN is a standard HDMI input that allows you to connect devices to your TV or audio system. It supports audio and video signals, but it does not support audio return channel (ARC) or enhanced audio return channel (eARC) functionality.

HDMI ARC is a special HDMI port that supports two-way communication between your TV and audio system. This means that audio can be sent from your TV to your audio system, and audio system can send audio back to your TV.

HDMI eARC (Enhanced Audio Return Channel) is an updated version of HDMI ARC that supports higher quality audio formats such as Dolby Atmos and DTS:X.

Note: Please turn on the "CEC" function on your TV.

When eARC / ARC is connected, your TV remote control can control the soundbar and TV simultaneously:

- 1 Turn on / off
- 2 Adjust the volume

5 CONNECT TO TV VIA OPTICAL / AUX

OPTICAL

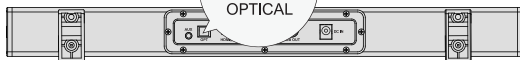
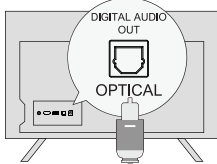

OPTION 1: OPTICAL

- 1 Make sure the TV's port is OPTICAL OUT, connect both sides of the cable to OPTICAL, for both the TV and the soundbar.
- 2 Make sure the optical plug is inserted correctly as it shows in the picture. Do not insert the plug upside down and break the optical.

Note: If audio is playing from the internal TV speakers, mute or minimize the TV volume.

AUX

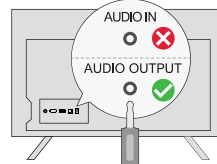

OPTION 2: AUX

- 1 Connect the 3.5mm to 3.5mm Audio Cable to your TV's AUDIO OUT port.
- 2 Not support AUDIO IN port on TV.

Note: Please remember to unplug the AUX cable from TV and Soundbar when you want to switch to other mode.

In Optical Mode: If there is no sound, try setting the TV audio output to PCM: TV Settings > Home > Settings > Sound > Digital Audio Output > PCM

6 CONNECT TO BLUETOOTH®

- 1 Press the "BT" button on the soundbar or remote control to enter Bluetooth pairing mode.
- 2 Open your phone's Bluetooth settings, find and select "Nova S50" to connect the soundbar.

Note: If it's already in the Bluetooth mode and connected, press and hold "BT" button for 3 seconds to disconnect the current device and connect to new device manually on your mobile phone / PC / TV.

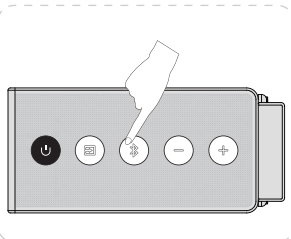

OR

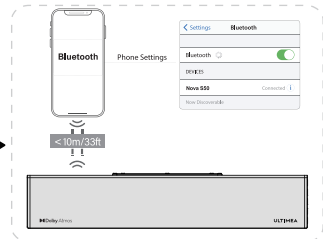
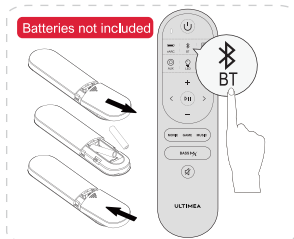

7 PLACEMENT OPTIONS

EN

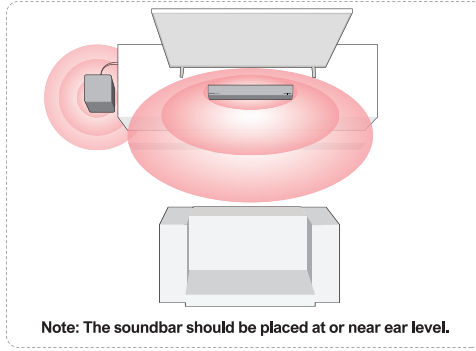

8 WALL MOUNT INSTALLATION

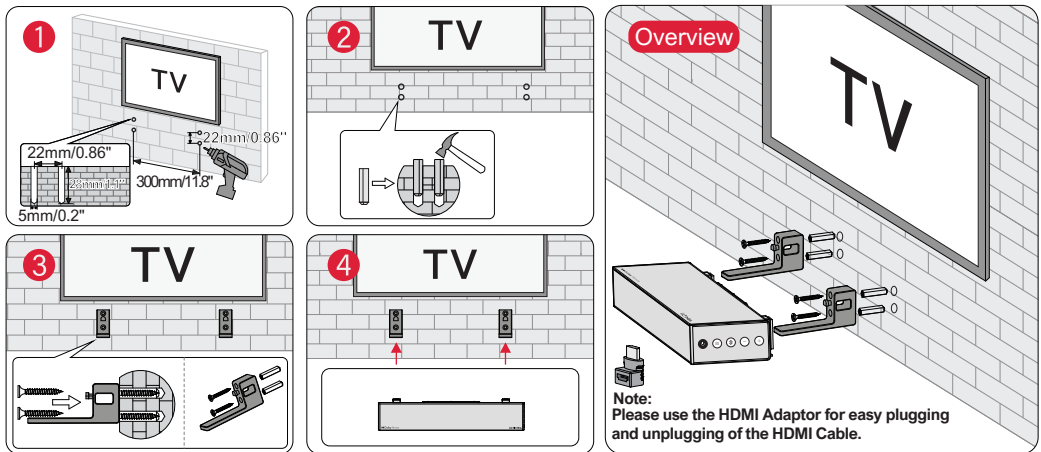

9 SPECIFICATIONS

Model Number	U2120
Power Supply	AC 110-240V, ~50/60Hz
Soundbar Drivers	(1.2" x 3.8") x 2 (Soundbar) + 5.25" (Subwoofer)
Frequency Response	45Hz - 18kHz
Standby Power	<0.5W
Operating Temperature	0°C - 45°C / 32°F - 113°F
Bluetooth Vision	5.3

Dimensions and Weight	
Soundbar	400(W) x 38(H) x 76(D)mm 15.7" x 1.5" x 3.0"
Subwoofer	270(W) x 115(H) x 270(D)mm 10.5" x 4.5" x 10.6"
Packaging	332(W) x 432(H) x 190(D)mm 13.1" x 17" x 7.5"
Net Weight	3.2kg / 7.05lbs
Gross Weight	4.68kg / 10.32lbs

Benutzerhandbuch



Modell Nr.: U2120

WIR SIND
BEREIT
ZU HELFEN



support@ultimea.com

Bevorzugen Sie ein Video-Tutorial?

Setup-Anleitung Video, oder USER MANUAL auf ULTIMEA Website.

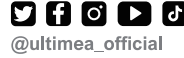

@ultimea_official



support.ultimea.com

+1 888-598-8875 (US) Mon-Fri 9am-5pm (PST)
+49 89-628-25828 (EU) Mon-Fri 9am-5pm (CET)

1 ZUBEHÖRLISTE

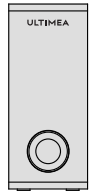

Soundbar



Subwoofer



Netzadapter



Stereo 3,5mm auf 3,5mm Audiokabel



HDMI-Kabel

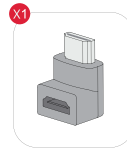

HDMI-Adapter



Optisches Digitalkabel



Fernbedienung

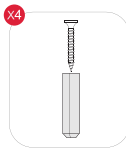

Wandmontage-Kit

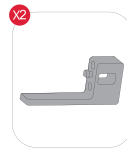

Wandhalterung



Benutzerhandbuch

2 SOUNDBAR-BEDIENELEMENTE

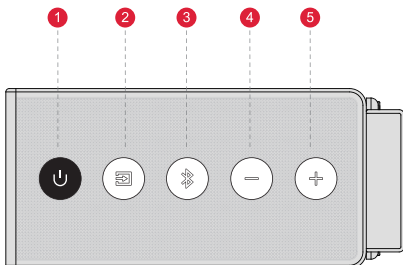

Bedienfeld

- 1 **“⏻”**: **Einschalttaste**
Zum Einschalten drücken / zum Ausschalten 3 Sekunden lang gedrückt halten.
- 2 **“📺”**: **Eingangsmodus**
Drücken, um den Kanal zu wechseln: eARC-OPT-BT-AUX-USB.
- 3 **“📶”**: **BT**
Drücken Sie , um zum Bluetooth-Kanal zu wechseln und den Kopplungsmodus zu aktivieren. Halten Sie die Taste 3 Sekunden lang gedrückt, um die Verbindung mit dem aktuellen Gerät zu trennen und sich manuell mit einem neuen Gerät auf Ihrem Mobiltelefon / PC / Fernseher zu verbinden. (BT ID: Nova S50).
- 4 **“= ”**: **Lautstärke verringern**
- 5 **“+ ”**: **Lauter**

Fernsteuerung

- 1 "⏻": **Einschalttaste**
Zum Einschalten drücken / zum Ausschalten 3 Sekunden lang gedrückt halten.
- 2 "eARC": **eARC**
Drücken, um zum HDMI eARC-Kanal zu wechseln.
- 3 "📶": **BT**
Drücken Sie , um zum Bluetooth-Kanal zu wechseln und den Kopplungsmodus zu aktivieren. Halten Sie die Taste 3 Sekunden lang gedrückt, um die Verbindung mit dem aktuellen Gerät zu trennen und sich manuell mit einem neuen Gerät auf Ihrem Mobiltelefon / PC / Fernseher zu verbinden. (BT ID: Nova S50).
- 4 "📺": **OPT**
Drücken, um zum OPTICAL-Kanal zu wechseln.
- 5 "🔊": **AUX**
Drücken Sie diese Taste, um zum AUX-Kanal zu wechseln.
- 6 "📀": **USB**
Drücken Sie diese Taste, um zum USB-Kanal zu wechseln.
- 7 "💡": **LED**
Drücken Sie die Taste, um auf den USB-Kanal umzuschalten, drücken Sie die Taste, um die LED einzuschalten, drücken Sie erneut, um sie auszuschalten.
- 8 "➕": **Lautstärke aufwärts**
- 9 "➖": **Lautstärke runter**
- 10 "⏪": **Zurück**
BT- und USB-Modus: Sprung zum nächsten Titel.
- 11 "⏩": **Nächster**
For BT and USB mode only: Skip to next track.
- 12 "⏸": **Wiedergabe / Pause**
Nur für BT- und USB-Modus,
USB-Modus: Halten Sie die Taste 3 Sekunden lang gedrückt, um zwischen Einzelschleifenwiedergabe und Listenschleifenwiedergabe umzuschalten.
- 13 "MOVIE": **MOVIE**
Drücken Sie , um in den MOVIE-Modus zu wechseln.
- 14 "GAME": **GAME**
Drücken Sie , um in den GAME-Modus zu wechseln.
- 15 "MUSIC": **MUSIC**
Drücken Sie , um in den MUSIC-Modus zu wechseln.
- 16 "BASS MX": **BASSMX™**
Drücken Sie diese Taste, um den Basspegel einzustellen; auf dem Display wird angezeigt: "BS-1", "BS 0", "BS 1".
- 17 "🔇": Stummschaltung / Wiederherstellung der Lautstärke.

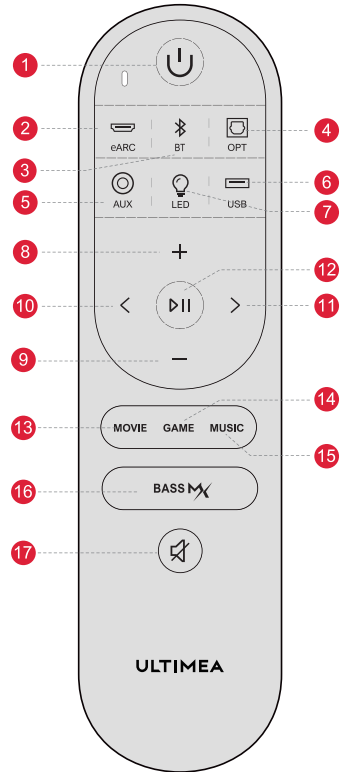

3 ANSCHLUSS AN SUBWOOFER

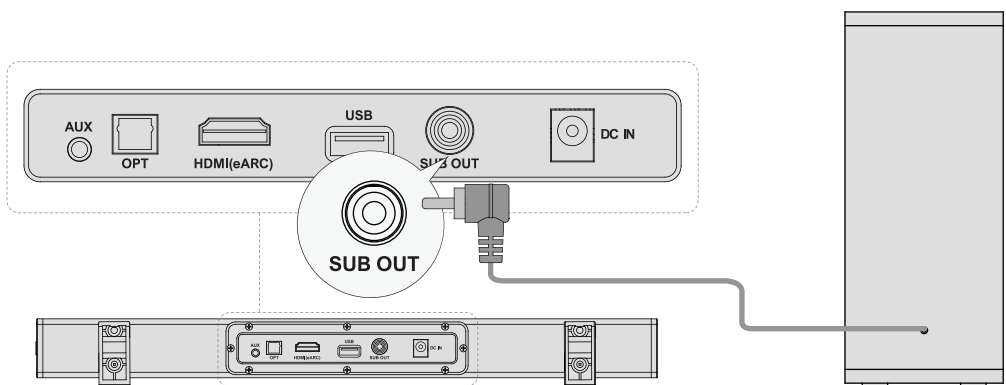

4 ANSCHLUSS AN DEN TV VIA HDMI eARC / ARC

DE

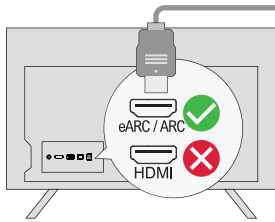

Schritt 1:

Schließen Sie ein Ende des HDMI-Kabels an den eARC / ARC Anschluss auf der Rückseite Ihres Fernsehers an.

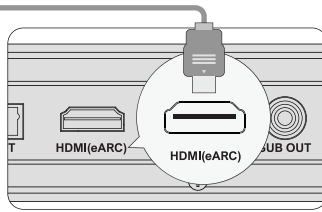

Schritt 2:

Schließen Sie dann das andere Ende an den HDMI (eARC)-Anschluss der Soundbar an.

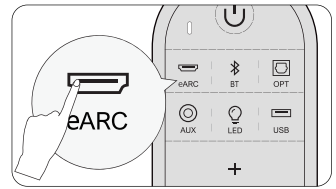

Schritt 3:

Drücken Sie die Taste "eARC" auf der Fernbedienung, um den Eingang "HDMI (eARC)" auszuwählen.

Hinweis:

Vergewissern Sie sich, dass der HDMI-Anschluss Ihres Fernsehers eARC unterstützt, sonst kann das Dolby Atmos-Audiosignal nicht übertragen werden.

Atmos: Wenn Sie einen Film im Dolby Atmos-Format ansehen, stellen Sie bitte den Audioausgang an Ihrem Fernseher auf Pass Through: TV-Einstellungen > Home > Einstellungen > Ton > Digitaler Audioausgang > Pass Through

DTS: Wenn Sie sich einen Film im DTS-Format ansehen, stellen Sie den Audioausgang an Ihrem Fernseher bitte auf PCM: TV-Einstellungen > Home > Einstellungen > Ton > Digitaler Audioausgang > PCM

Was ist der Unterschied zwischen: HDMI IN, HDMI ARC, HDMI eARC?

HDMI IN ist ein Standard-HDMI-Eingang, über den Sie Geräte an Ihren Fernseher oder Ihr Audiosystem anschließen können. Er unterstützt Audio- und Videosignale, aber keine Audio-Rückkanal- (ARC) oder erweiterte Audio-Rückkanal- (eARC) Funktionalität.

HDMI ARC ist ein spezieller HDMI-Anschluss, der die Zwei-Wege-Kommunikation zwischen Ihrem Fernsehgerät und Ihrem Audiosystem unterstützt. Das bedeutet, dass Audiosignale von Ihrem Fernseher an Ihr Audiosystem gesendet werden können und das Audiosystem Audiosignale zurück an Ihren Fernseher senden kann.

HDMI eARC (Enhanced Audio Return Channel) ist eine aktualisierte Version von HDMI ARC, die höherwertige Audioformate wie Dolby Atmos und DTS:X unterstützt.

Hinweis: Bitte schalten Sie die "CEC"-Funktion an Ihrem Fernseher ein.

Wenn eARC / ARC angeschlossen ist, kann Ihre TV-Fernbedienung die Soundbar und den Fernseher gleichzeitig steuern:

- 1 Einschalten / Ausschalten
- 2 Lautstärke einstellen

5 ANSCHLUSS AN FERNSEHER ÜBER OPTISCH / AUX

OPTISCH

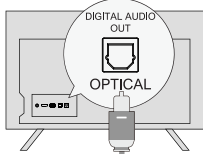

OPTION 1: OPTISCH

- 1 Vergewissern Sie sich, dass das Kabel an den OPTICAL OUT-Anschluss Ihres Fernsehers und das andere Ende an den OPTICAL-Anschluss der Soundbar angeschlossen ist.
 - 2 Vergewissern Sie sich, dass der optische Stecker richtig eingesteckt ist, wie auf dem Bild zu sehen. Stecken Sie den Stecker nicht verkehrt herum ein und brechen Sie die Optik nicht ab.
- Hinweis:** Wenn der Ton über die internen TV-Lautsprecher wiedergegeben wird, schalten Sie die Lautstärke des Fernsehers stumm oder verringern Sie sie.

AUX

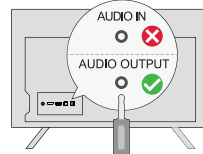

OPTION 2: AUX

- 1 Schließen Sie das 3,5-mm-auf-3,5-mm-Audiokabel an den RCA AUDIO OUT-Anschluss Ihres Fernsehers an.
 - 2 Unterstützt nicht den AUDIO IN-Anschluss des Fernsehers.
- Hinweis:** Bitte denken Sie daran, das AUX-Kabel vom Fernseher und der Soundbar zu trennen, wenn Sie einen anderen Modus verwenden möchten.

Im optischen Modus: Wenn kein Ton zu hören ist, versuchen Sie, den Audioausgang des Fernsehers auf PCM einzustellen:
TV-Einstellungen > Home > Einstellungen > Ton > Digitaler Audioausgang > PCM

6 MIT BLUETOOTH VERBINDEN

- 1 Drücken Sie die Taste "BT" auf der Soundbar oder der Fernbedienung, um den Bluetooth-Kopplungsmodus zu aktivieren.
 - 2 Öffnen Sie die Bluetooth-Einstellungen Ihres Telefons, suchen und wählen Sie "Nova S50", um die Soundbar zu verbinden.
- Hinweis:** Wenn sich das Gerät bereits im Bluetooth-Modus befindet und verbunden ist, halten Sie die Taste "BT" 3 Sekunden lang gedrückt, um die Verbindung mit dem aktuellen Gerät zu trennen und manuell eine Verbindung mit einem neuen Gerät auf Ihrem Mobiltelefon / PC / Fernseher herzustellen.

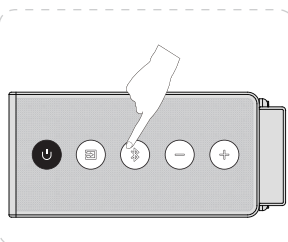

oder

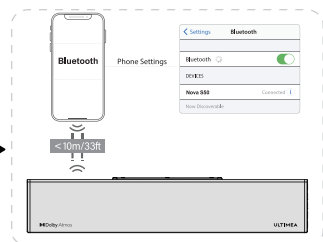
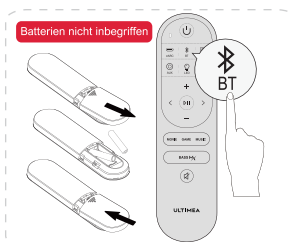

7 PLATZIERUNGSMÖGLICHKEITEN

DE

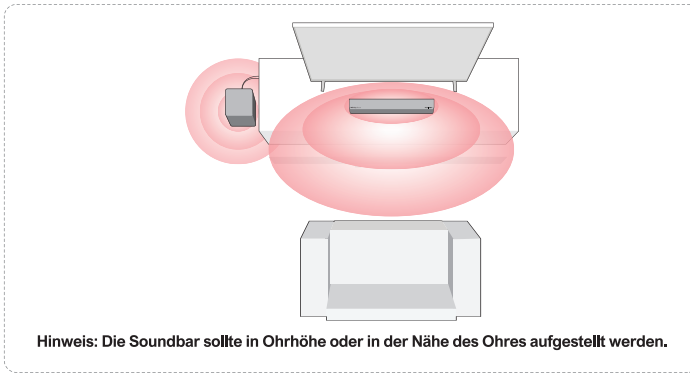

8 WANDBEFESTIGUNG

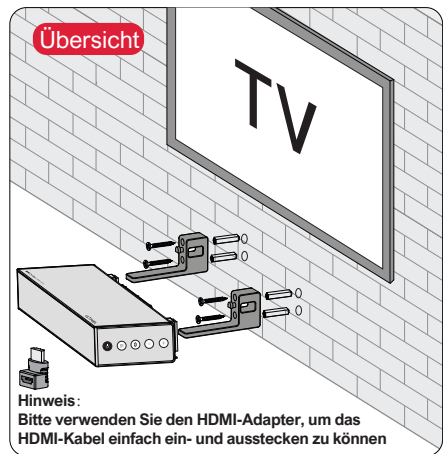
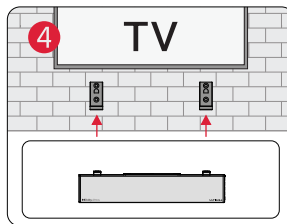
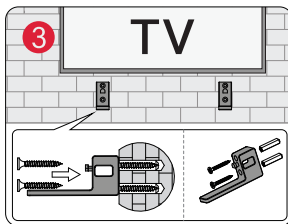
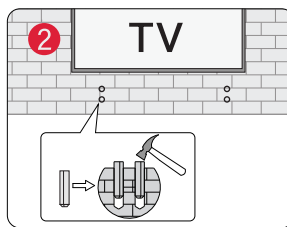
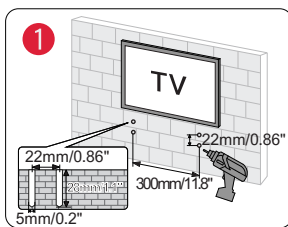

9 SPEZIFIKATIONEN

Modell-Nummer	U2120
Stromversorgung	AC 110-240V, ~50/60Hz
Soundbar-Treiber	(1.2" x 3.8") x 2 (Soundbar) + 5.25" (Subwoofer)
Frequenzgang	45Hz - 18kHz
Standby-Leistung	<0.5W
Betriebstemperatur	0°C - 45°C / 32°F - 113°F
Bluetooth Vision	5.3

Abmessungen und Gewicht	
Soundbar	400(W) x 38(H) x 76(D)mm 15.7" x 1.5" x 3.0"
Subwoofer	270(W) x 115(H) x 270(D)mm 10.5" x 4.5" x 10.6"
Verpackung	332(W) x 432(H) x 190(D)mm 13.1" x 17" x 7.5"
Nettogewicht	3.2kg / 7.05lbs
Bruttogewicht	4.68kg / 10.32lbs

ULTIMEA

Nova S50

ユーザーマニュアル

ご対応させていただきます



support@ultimea.com

JP



モデルNo: U2120

ビデオチュートリアルをご希望ですか?

ULTIMEAのホームページで、セットアップガイダンスの動画や取扱説明書をご覧ください。

@ultimea_official



support.ultimea.com

+1 888-598-8875 (US) Mon-Fri 9am-5pm (PST)
 +49 89-628-25828 (EU) Mon-Fri 9am-5pm (CET)

1 アクセサリーリスト



サブウーファー



サウンドバー



電源アダプター



ステレオ3.5mm-3.5mmオーディオケーブル



HDMIケーブル

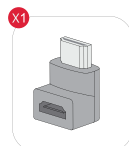

HDMIアダプター



デジタル光ケーブル



リモコン

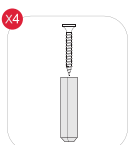

壁掛けキット



壁掛けブラケット



ユーザーマニュアル

2 サウンドバーのコントロール

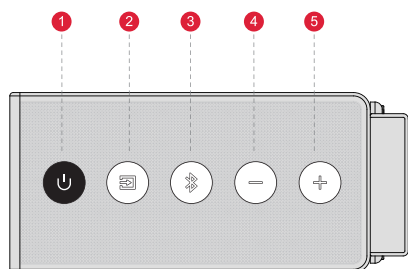

コントロールパネル

- 1 “” : 電源ボタン
押すと電源が入り、3秒間押し続けると電源が切れます。
- 2 “” : 入力モード
を押してチャンネルを切り替える: eARC-OPT-BT-AUX-USB。
- 3 “” : BT
を押すとBTチャンネルに切り替わります。
(BT ID: Nova S50)。
- 4 “” : ボリュームダウン
- 5 “” : ボリューム・アップ

リモコン

JP

- 1 “**U**”：「電源ボタン」
電源オン/3秒長押しで電源オフ。
- 2 “**eARC**”：eARC
押すとHDMI eARCチャンネルに切り替わります。
- 3 “**BT**”：BT
を押すとBTチャンネルに切り替わります。
(BT ID: Nova S50)。
- 4 “**OPT**”：OPT
押すとOPTICALチャンネルに切り替わります。
- 5 “**AUX**”：AUX
押すとAUXチャンネルに切り替わります。
- 6 “**USB**”：USB
押すとUSBチャンネルに切り替わります。
- 7 “**LED**”：LED
押すとLEDが点灯し、もう一度押すと消灯します。
- 8 “**+**”：「ボリュームアップ」
- 9 “**-**”：「ボリュームダウン」
- 10 “**<**”：前
BTおよびUSBモード：前のトラックにスキップします。
- 11 “**>**”：次へ
BTおよびUSBモード：次のトラックにスキップします。
- 12 “**▶||**”：再生/一時停止
BTおよびUSBモードのみ
USBモード：3秒間長押しすると、シングルループ再生とリストループ再生が切り替わります。
- 13 “**MOVIE**”：MOVIE
押すとMOVIEモードに切り替わります。
- 14 “**GAME**”：GAME
押すとGAMEモードに切り替わります。
- 15 “**MUSIC**”：音楽
押すとMUSICモードに切り替わります。
- 16 “**BASS**”：ベースマックス
を押して低音レベルを調整します：“B5-1”、“B5 0”、“B5 1”。
- 17 “**🔇**”：ミュート / 音量を回復します。

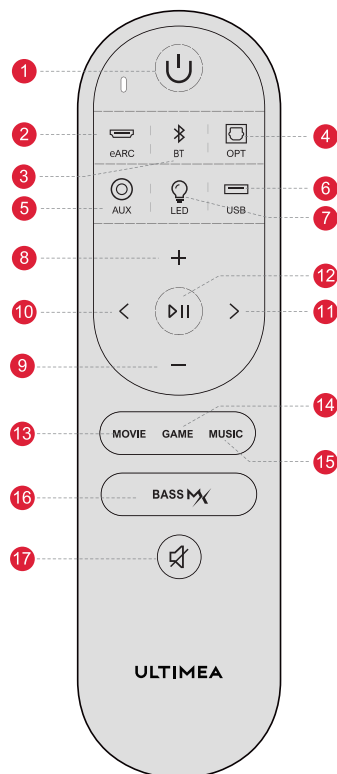

3 サブウーファーに接続

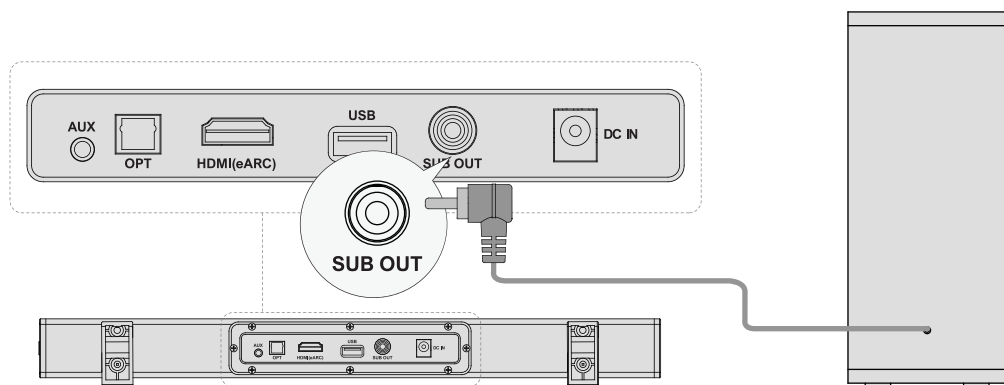

4 HDMI eARC / ARCでテレビに接続する

JP

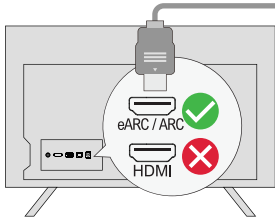

ステップ1:
HDMIケーブルの一端をテレビ背面のeARC / ARCポートに接続します。

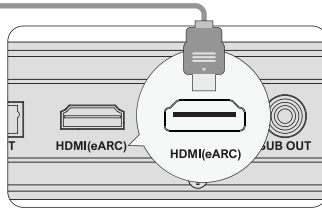

ステップ2:
もう一方の端をサウンドバーのHDMI(eARC)ポートに接続します。

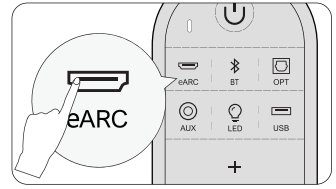

ステップ3:
リモコンの "eARC" ボタンを押して "HDMI(eARC)" 入力を選択します。

注意:

Dolby Atmos 音声フォーマットをサウンドバーに伝送するには、テレビのHDMIポートがeARCに対応している必要があります。

Atmos: Dolby Atmosフォーマットの映画を視聴する場合は、テレビの音声出力をパススルーに設定してください:

テレビの設定 > ホーム > 設定 > サウンド > デジタル音声出力 > パススルー

TV-Einstellungen > Home > Einstellungen > Ton > Digitaler Audioausgang > Pass Through

DTS: DTSフォーマットの映画を視聴する場合は、テレビの音声出力をPCMに設定してください:

テレビの設定 > ホーム > 設定 > サウンド > デジタル音声出力 > PCM

HDMI IN、HDMI ARC、HDMI eARCの違いは何ですか? HDMI IN、HDMI ARC、HDMI eARCの違いは何ですか?

HDMI IN は、テレビやオーディオシステムに機器を接続するための標準的なHDMI入力です。オーディオとビデオ信号に対応していますが、オーディオ・リターン・チャンネル (ARC) やエンハンスド・オーディオ・リターン・チャンネル (eARC) 機能には対応していません。

HDMI ARC は、テレビとオーディオシステム間の双方向通信をサポートする特別なHDMIポートです。つまり、オーディオはテレビからオーディオ・システムに送られ、オーディオ・システムはテレビにオーディオを送り返すことができます。

HDMI eARC (Enhanced Audio Return Channel) は、Dolby AtmosやDTS:Xなどの高品質オーディオフォーマットをサポートするHDMI ARCのアップデートバージョンです。

注: テレビの「CEC」機能をオンにしてください。

eARC / ARCが接続されている場合、テレビのリモコンでサウンドバーとテレビを同時に操作できます:

- ① 電源オン/オフ
- ② 音量調整

5 オプティカル/AUX経由でテレビに接続

光学式

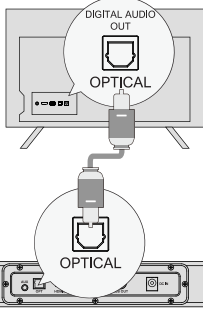

オプション1: 光学式

- ① ケーブルがテレビのOPTICAL OUTポートに接続され、もう一方がサウンドバーのOPTICALポートに接続されていることを確認してください。
- ② 光プラグが写真のように正しく挿入されていることを確認してください。プラグが逆さまに挿入され、光が破損しないようにしてください。

注: テレビ内蔵スピーカーから音声が再生される場合は、テレビの音量をミュートまたは最小にしてください。

AUX

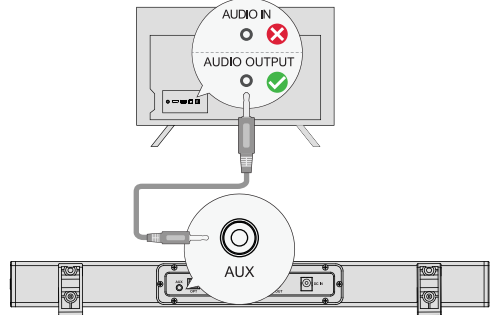

オプション2: AUX

- ① 3.5mm-3.5mmオーディオケーブルをテレビのRCA AUDIO OUTポートに接続します。
- ② テレビのAUDIO INポートには対応していません。

注: 他のモードを使用する場合は、テレビとサウンドバーからAUXケーブルを抜いてください。

オプティカルモードの場合: 音が出ない場合は、テレビの音声出力をPCMに設定してみてください:
テレビの設定 > ホーム > 設定 > サウンド > デジタル音声出力 > PCM

6 ブルートゥース接続

- ① サウンドバーまたはリモコンの "BT" ボタンを押して、Bluetoothペアリングモードに入ります。
- ② 携帯電話のBluetooth設定を開き、"Nova S50" を見つけて選択し、サウンドバーを接続します。

注: すでにBluetoothモードで接続されている場合は、"BT" ボタンを3秒間長押しして、現在のデバイスを切断し、携帯電話/PC/テレビで手動で新しいデバイスに接続します。

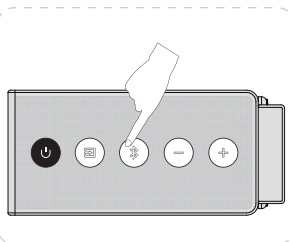

または

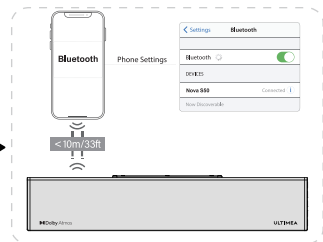
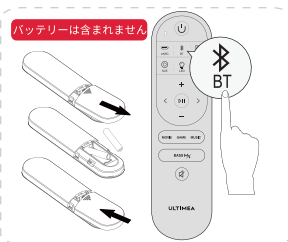

7 配置オプション

JP

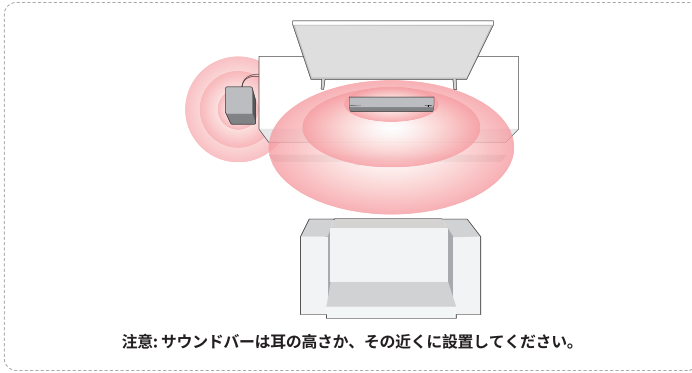

8 壁掛け設置

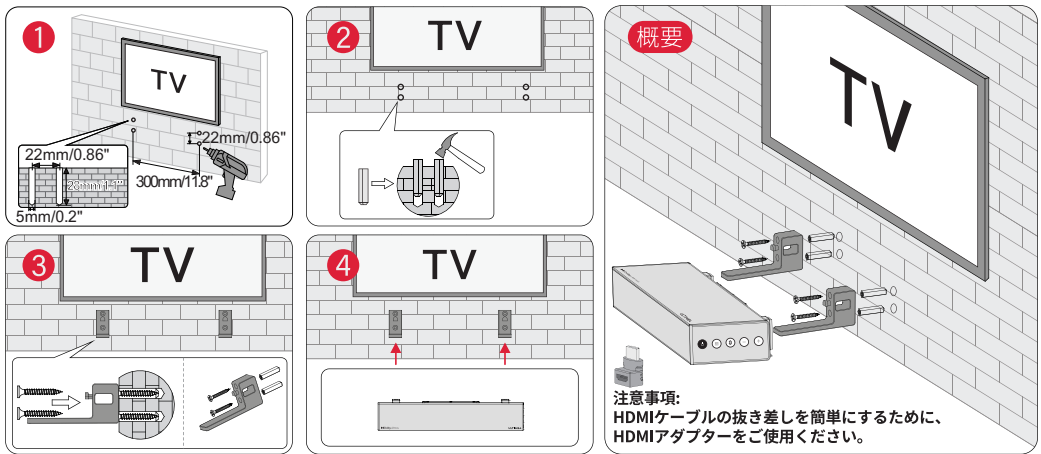

9 仕様

モデル番号	U2120
電源	AC 110-240V, ~50/60Hz
サウンドバードライバー	(1.2インチ×3.8インチ) ×2 (サウンドバー) +5.25インチ (サブウーファー)
周波数特性	45Hz - 18kHz
スタンバイ電力	<0.5W
動作温度	0°C - 45°C / 32°F - 113°F
ブルートゥース・ビジョン	5.3

寸法と重量	
サウンドバー	400(W) x 38(H) x 76(D)mm 15.7" x 1.5" x 3.0"
サブウーファー	270(W) x 115(H) x 270(D)mm 10.5" x 4.5" x 10.6"
パッケージング	332(W) x 432(H) x 190(D)mm 13.1" x 17" x 7.5"
正味重量	3.2kg / 7.05lbs
総重量	4.68kg / 10.32lbs

ULTIMEA

Nova S50

Manuel d'utilisation



N° de modèle : U2120

NOUS SOMMES PRÊTS À VOUS AIDER



support@ultimea.com

FR

Vous préférez un tutoriel vidéo ?

Vidéo d'aide à l'installation, ou MANUEL D'UTILISATION sur le site web d'ULTIMEA.

@ultimea_official



support.ultimea.com

+1 888-598-8875 (US) Mon-Fri 9am-5pm (PST)
+49 89-628-25828 (EU) Mon-Fri 9am-5pm (CET)

1 LISTE DES ACCESSOIRES



Caisson de basse

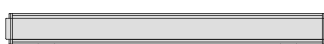

Barre de son



Adaptateur électrique

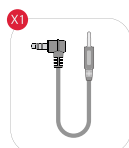

Câble audio stéréo 3,5 mm à 3,5 mm

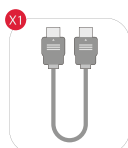

Câble HDMI

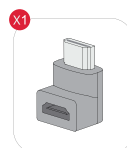

Adaptateur HDMI



Câble optique numérique



Télécommande

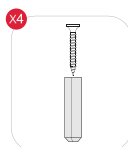

Kit de montage mural

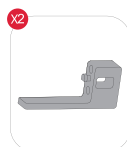

Support mural



Manuel de l'utilisateur

2 COMMANDES DE LA BARRE DE SON

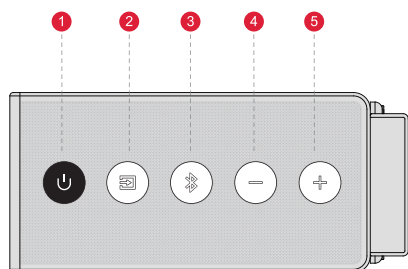

Panneau de contrôle

- 1 "⏻": Bouton d'alimentation**
Appuyez sur ce bouton pour allumer l'appareil / Maintenez-le enfoncé pendant 3 secondes pour l'éteindre.
- 2 "📺": Mode d'entrée**
Appuyez pour changer de canal : eARC-OPT-BT-AUX-USB.
- 3 "📶": BT**
Appuyez sur cette touche pour passer au canal BT / Maintenez la touche enfoncée pendant 3 secondes pour déconnecter l'appareil actuel et vous connecter manuellement à un nouvel appareil sur votre téléphone portable / PC / TV. (BT ID : Nova S50).
- 4 "⏪": Réduction du volume**
- 5 "⏩": Augmentation du volume**

Télécommande

- 1 "⏻": **Bouton d'alimentation**
Appuyer pour mettre sous tension / Maintenir pendant 3 secondes pour mettre hors tension.
- 2 "eARC": **eARC**
Appuyez sur cette touche pour passer au canal HDMI eARC.
- 3 "📶": **BT**
Appuyez sur cette touche pour passer au canal Bluetooth et entrer en mode d'appairage. Maintenez cette touche enfoncée pendant 3 secondes pour déconnecter l'appareil actuel et vous connecter manuellement à un nouvel appareil sur votre téléphone portable / PC / TV (BT ID : Nova S50).
- 4 "📺": **OPT**
Appuyez sur cette touche pour passer au canal OPTICAL.
- 5 "🎧": **AUX**
Appuyez sur cette touche pour passer au canal AUX.
- 6 "📀": **USB**
Appuyez sur cette touche pour passer au canal USB.
- 7 "💡": **LED**
Appuyez sur cette touche pour allumer la LED, appuyez à nouveau pour l'éteindre.
- 8 "+": **Augmentation du volume**
- 9 "-": **Diminution du volume**
- 10 "<": **Précédent**
Mode BT et USB : Passer à la piste précédente.
- 11 ">": **Suivant**
Mode BT et USB : Passer à la piste suivante.
- 12 "▶||": **Lecture/Pause**
Pour les modes BT et USB uniquement.
Mode USB : Maintenez cette touche enfoncée pendant 3 secondes pour basculer entre la lecture d'une boucle unique et la lecture d'une boucle de liste.
- 13 "MOVIE": **MOVIE**
Appuyez sur cette touche pour passer au mode MOVIE.
- 14 "GAME": **GAME**
Appuyez sur cette touche pour passer en mode JEU.
- 15 "MUSIC": **MUSIQUE**
Appuyez sur cette touche pour passer en mode MUSIQUE.
- 16 "BASS MX": **BASSMX™**
Appuyez sur pour régler le niveau des basses, l'écran affiche: "B5-1", "B5 0", "B5 1".
- 17 "🔇": **Mute / Récupérer le volume.**

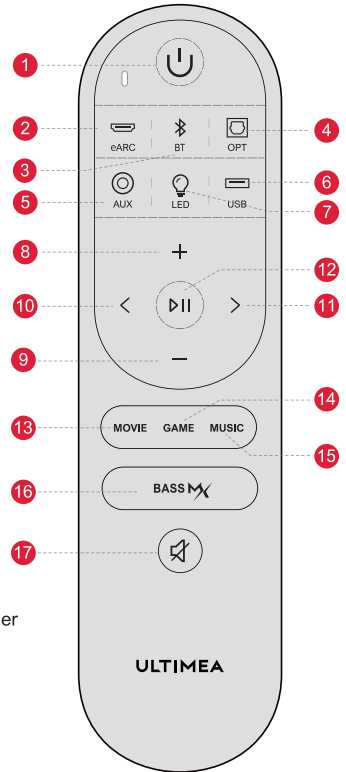

3 CONNECTER AU CAISSON DE BASSE

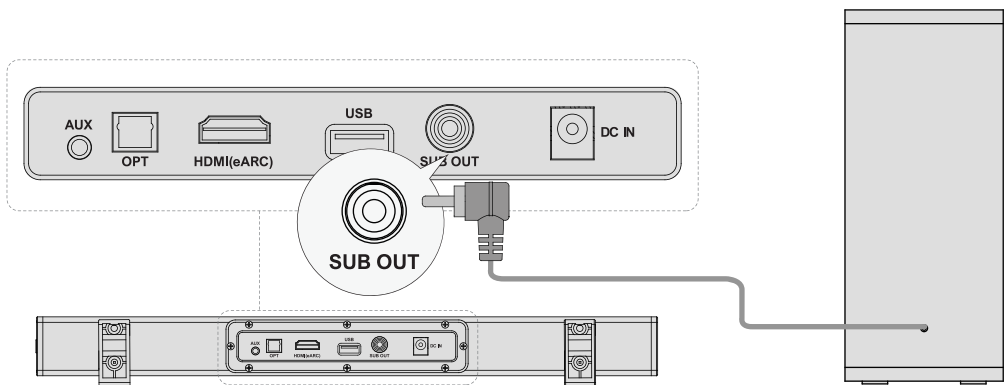

4 CONNEXION AU TÉLÉVISEUR VIA HDMI eARC / ARC

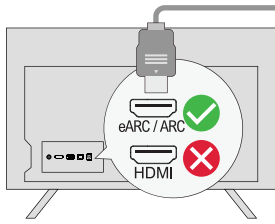

Étape 1:

Connectez une extrémité du câble HDMI au port eARC / ARC à l'arrière de votre téléviseur.

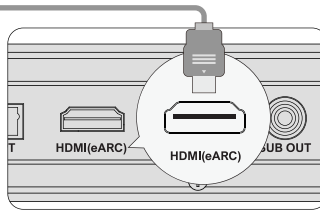

Étape 2:

Connectez ensuite l'autre extrémité au port HDMI (eARC) de la barre de son.

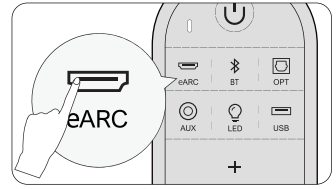

Étape 3:

Appuyez sur le bouton "eARC" de la télécommande pour sélectionner l'entrée "HDMI (eARC)".

Remarque :

Le port HDMI de votre téléviseur doit prendre en charge l'eARC pour transmettre le format audio Dolby Atmos à votre Soundbar.

Atmos : Si vous regardez un film au format Dolby Atmos, réglez la sortie audio de votre téléviseur sur Pass Through:

Réglages TV > Accueil > Réglages > Son > Sortie audio numérique > Pass Through

DTS : Si vous regardez un film au format DTS, réglez la sortie audio de votre téléviseur sur PCM:

Réglages TV > Accueil > Réglages > Son > Sortie audio numérique > PCM

Quelle est la différence entre : HDMI IN, HDMI ARC, HDMI eARC ?

HDMI IN est une entrée HDMI standard qui vous permet de connecter des appareils à votre téléviseur ou à votre système audio. Elle prend en charge les signaux audio et vidéo, mais ne prend pas en charge la fonctionnalité de canal de retour audio (ARC) ou de canal de retour audio amélioré (eARC).

HDMI ARC est un port HDMI spécial qui prend en charge la communication bidirectionnelle entre votre téléviseur et votre système audio. Cela signifie que le son peut être envoyé de votre téléviseur à votre système audio, et que le système audio peut renvoyer le son à votre téléviseur.

HDMI eARC (Enhanced Audio Return Channel) est une version actualisée de HDMI ARC qui prend en charge des formats audio de meilleure qualité tels que Dolby Atmos et DTS:X.

Remarque : veuillez activer la fonction "CEC" sur votre téléviseur.

Lorsque eARC / ARC est connecté, la télécommande de votre téléviseur peut contrôler la barre de son et le téléviseur simultanément :

- 1 Allumer / éteindre
- 2 Régler le volume

5 CONNECTER AU TÉLÉVISEUR VIA OPTIQUE / AUX

OPTIQUE

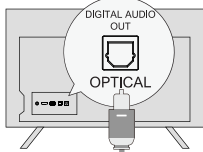

OPTION 1 : OPTIQUE

- 1 Assurez-vous que le câble est connecté au port OPTICAL OUT de votre téléviseur et l'autre extrémité au port OPTICAL de la barre de son.
- 2 Assurez-vous que la prise optique est insérée correctement, comme indiqué sur l'image. N'insérez pas la fiche à l'envers et ne cassez pas le câble optique.

Remarque : Si le son est diffusé par les haut-parleurs internes du téléviseur, coupez ou réduisez le volume du téléviseur.

AUX

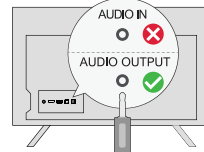

OPTION 2 : AUX

- 1 Connectez le câble audio 3,5 mm à 3,5 mm au port RCA AUDIO OUT de votre téléviseur.
- 2 le port AUDIO IN de la télévision n'est pas pris en charge.

Remarque : N'oubliez pas de débrancher le câble AUX du téléviseur et de la barre de son lorsque vous souhaitez utiliser un autre mode.

En mode optique : S'il n'y a pas de son, essayez de régler la sortie audio du téléviseur sur PCM :

Réglages TV > Accueil > Réglages > Son > Sortie audio numérique > PCM

6 SE CONNECTER À BLUETOOTH

- 1 Appuyez sur le bouton "BT" de la barre de son ou de la télécommande pour entrer en mode d'appairage Bluetooth.

- 2 Ouvrez les paramètres Bluetooth de votre téléphone, recherchez et sélectionnez "Nova S50" pour connecter la barre de son.

Remarque : Si l'appareil est déjà en mode Bluetooth et connecté, appuyez sur le bouton "BT" et maintenez-le enfoncé pendant 3 secondes pour déconnecter l'appareil actuel et vous connecter manuellement à un nouvel appareil sur votre téléphone portable / PC / TV.

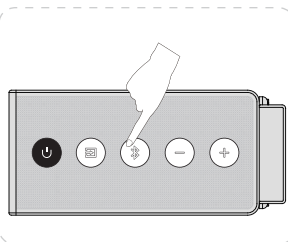

OU

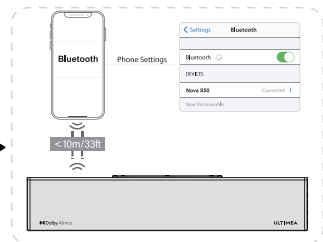
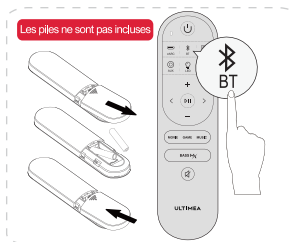

7 OPTIONS DE PLACEMENT

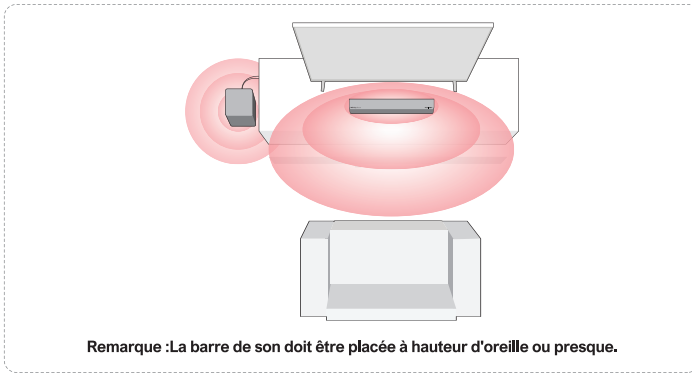

FR

8 INSTALLATION MURALE

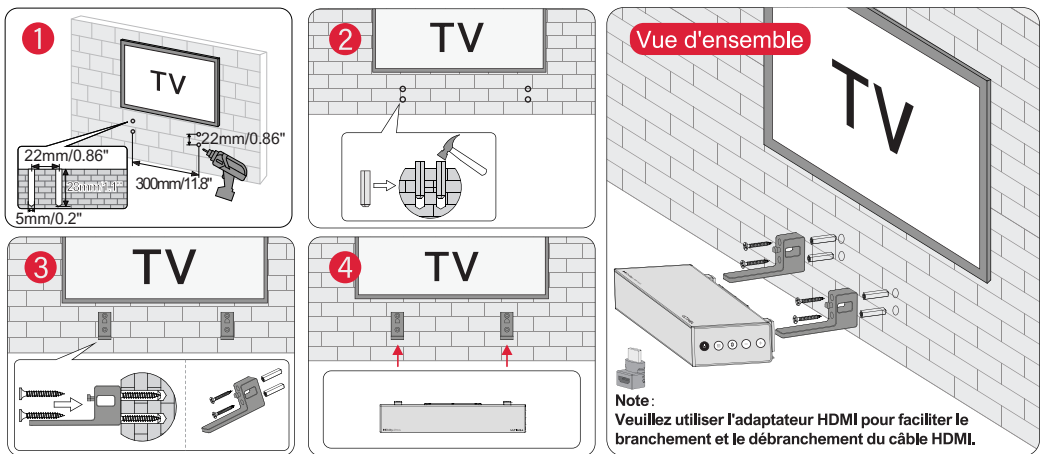

9 CARACTÉRISTIQUES TECHNIQUES

Alimentation électrique	U2120
Soundbar Drivers	AC 110-240V, ~50/60Hz
Barre de son Pilotes	(1.2" x 3.8") x 2 (Soundbar) + 5.25" (Subwoofer)
Réponse en fréquence	45Hz - 18kHz
Puissance en veille	<0.5W
Température de fonctionnement	0°C - 45°C / 32°F - 113°F
Vision Bluetooth	5.3

Dimensions et poids	
Soundbar	400(W) x 38(H) x 76(D)mm 15.7" x 1.5" x 3.0"
Caisson de basse	270(W) x 115(H) x 270(D)mm 10.5" x 4.5" x 10.6"
Emballage	332(W) x 432(H) x 190(D)mm 13.1" x 17" x 7.5"
Poids net	3.2kg / 7.05lbs
Poids brut	4.68kg / 10.32lbs

ULTIMEA

Nova S50

Manuale d'uso



Modello n.: U2120

SIAMO PRONTI AD AIUTARE



support@ultimea.com

Preferite un video tutorial?

Video guida all'installazione o MANUALE D'USO sul sito web di ULTIMEA.



@ultimea_official



support.ultimea.com

+1 888-598-8875 (US) Mon-Fri 9am-5pm (PST)
+49 89-628-25828 (EU) Mon-Fri 9am-5pm (CET)

IT

1 ELENCO DEGLI ACCESSORI

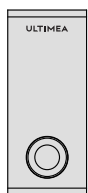

Subwoofer



Soundbar



Adattatore di alimentazione



Cavo audio stereo da 3,5 mm a 3,5 mm



Cavo HDMI

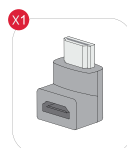

Adattatore HDMI



Cavo ottico digitale



Telecomando

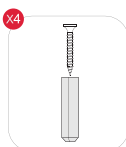

Kit di montaggio a parete



Staffa a parete



Manuale d'uso

2 CONTROLLI DELLA SOUNDBAR

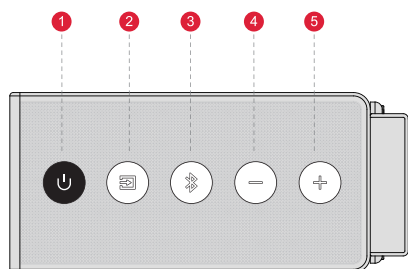

Pannello di controllo

- 1 **“⏻”**: **pulsante di accensione**
Premere per accendere / Tenere premuto per 3 secondi per spegnere.
- 2 **“📺”**: **Modalità di ingresso**
Premere per cambiare canale: eARC-OPT-BT-AUX-USB.
- 3 **“📶”**: **BT**
Premere per passare al canale BT / Tenere premuto per 3 secondi per scollegare il dispositivo corrente e collegarsi a un nuovo dispositivo (ID BT: Nova S50).
- 4 **“—”**: **Volume giù**
- 5 **“+”**: **Volume alto**

Telecomando

- 1 “⏻”: **Tasto di accensione**
Premere per accendere / Tenere premuto per 3 secondi per spegnere.
- 2 “eARC”: **eARC**
Premere per passare al canale HDMI eARC.
- 3 “📶”: **BT**
Premere per passare al canale BT / Tenere premuto per 3 secondi per scollegare il dispositivo corrente e collegarsi a un nuovo dispositivo. (ID BT: Nova S50).
- 4 “📺”: **OPT**
Premere per passare al canale ottico.
- 5 “🎧”: **AUX**
Premere per passare al canale AUX.
- 6 “📀”: **USB**
Premere per passare al canale USB.
- 7 “💡”: **LED**
Premere per accendere il LED, premere nuovamente per spegnerlo.
- 8 “+”: **Volume su**
- 9 “-”: **Volume giù**
- 10 “<”: **Precedente**
Modalità BT e USB: Passa al brano precedente.
- 11 “>”: **successivo**
Modalità BT e USB: Passa alla traccia successiva.
- 12 “⏸”: **Riproduzione / Pausa**
Solo per le modalità BT e USB.
Modalità USB: Tenere premuto per 3 secondi per passare dalla riproduzione di un singolo loop alla riproduzione di un elenco di loop.
- 13 “MOVIE”: **FILMATO**
Drücken Sie , um in den MOVIE-Modus zu wechseln.
- 14 “GAME”: **GIOCO**
Drücken Sie , um in den GAME-Modus zu wechseln.
- 15 “MUSIC”: **MUSICA**
Drücken Sie , um in den MUSIC-Modus zu wechseln.
- 16 “BASS Mx”: **BASSMX™**
Premere per regolare il livello dei bassi; il display visualizza: “B5-1”, “B5 0”, “B5 1”.
- 17 “🔇”: **Mute / Recupera il volume.**

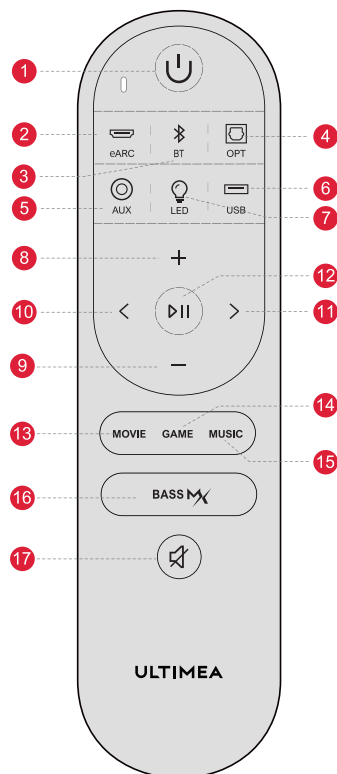

3 COLLEGAMENTO AL SUBWOOFER

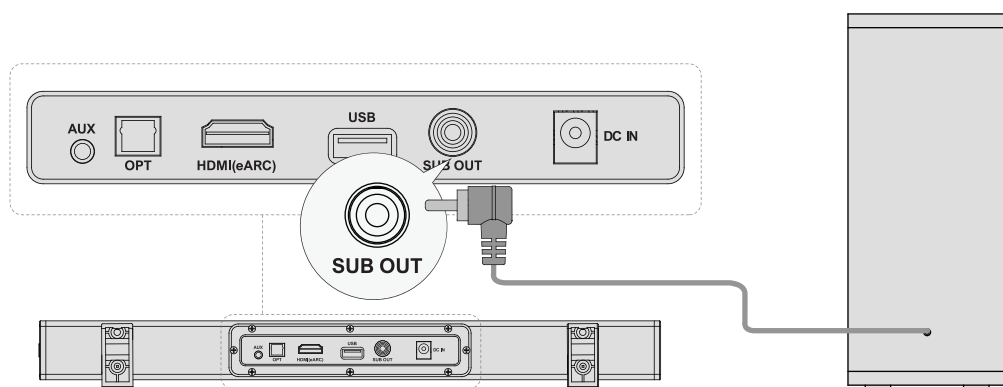

4 COLLEGAMENTO AL TV TRAMITE HDMI eARC / ARC

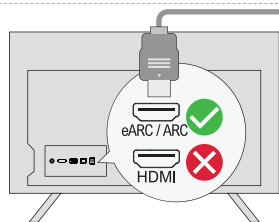

Passo 1:
Collegare un'estremità del cavo HDMI alla porta eARC / ARC sul retro del televisore.

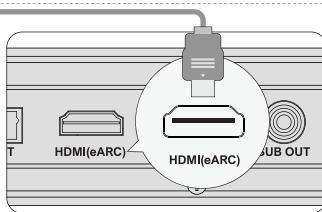

Passo 2:
Collegare quindi l'altra estremità alla porta HDMI (eARC) della soundbar.

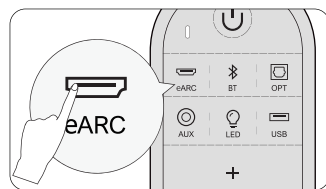

Passo 3:
Premere il tasto "eARC" sul telecomando per selezionare l'ingresso "HDMI (eARC)".

Nota:

La porta HDMI del televisore deve supportare eARC per trasmettere il formato audio Dolby Atmos alla Soundbar.

Atmos: se si guarda un film in formato Dolby Atmos, impostare l'uscita audio del televisore su Pass Through:

Impostazioni TV > Home > Impostazioni > Suono > Uscita audio digitale > Passa attraverso

DTS: Se si sta guardando un film in formato DTS, impostare l'uscita audio sul televisore su PCM:

Impostazioni TV > Home > Impostazioni > Audio > Uscita audio digitale > PCM

Qual è la differenza tra: HDMI IN, HDMI ARC, HDMI eARC?

HDMI IN è un ingresso HDMI standard che consente di collegare i dispositivi al televisore o al sistema audio. Supporta segnali audio e video, ma non supporta la funzionalità ARC (Audio Return Channel) o eARC (Enhanced Audio Return Channel).

HDMI ARC è una porta HDMI speciale che supporta la comunicazione bidirezionale tra il televisore e il sistema audio. Ciò significa che l'audio può essere inviato dal televisore al sistema audio e il sistema audio può inviare l'audio al televisore.

HDMI eARC (Enhanced Audio Return Channel) è una versione aggiornata dell'HDMI ARC che supporta formati audio di qualità superiore come Dolby Atmos e DTS:X.

Nota: attivare la funzione "CEC" sul televisore.

Quando è collegato eARC / ARC, il telecomando del televisore può controllare contemporaneamente la soundbar e il televisore:

- 1 Accendere / Spegnerne
- 2 Regolare il volume

5 COLLEGAMENTO ALLA TV VIA OTTICO/AUSILIARIO

OTTICA

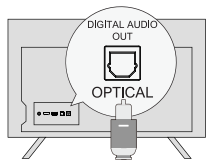

OPZIONE 1: OTTICA

- 1 Assicurarsi che il cavo sia collegato alla porta OPTICAL OUT del televisore e l'altra estremità alla porta OPTICAL del sistema Soundbar.
- 2 Assicurarsi che la spina ottica sia inserita correttamente come mostrato nell'immagine. Non inserire la spina al contrario e non rompere l'ottica.

Nota: se l'audio viene riprodotto dagli altoparlanti interni del televisore, disattivare o ridurre al minimo il volume del televisore.

AUX

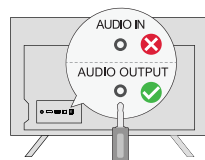

OPZIONE 2: AUX

- 1 Collegare il cavo audio da 3,5 mm a 3,5 mm alla porta RCA AUDIO OUT del televisore.
- 2 Non supporta la porta AUDIO IN del televisore.

Nota: ricordarsi di scollegare il cavo AUX dal televisore e dalla Soundbar quando si desidera utilizzare un'altra modalità.

In modalità ottica: Se non si sente alcun suono, provare a impostare l'uscita audio del televisore su PCM:

Impostazioni TV > Home > Impostazioni > Audio > Uscita audio digitale > PCM

6 CONNETTERSI AL BLUETOOTH

- 1 Premere il pulsante "BT" sulla soundbar o sul telecomando per accedere alla modalità di accoppiamento Bluetooth.
- 2 Aprire le impostazioni Bluetooth del telefono, trovare e selezionare "Nova S50" per collegare la soundbar.

Nota: se è già in modalità Bluetooth e collegato, tenere premuto il pulsante "BT" per 3 secondi per scollegare il dispositivo corrente e collegarsi manualmente a un nuovo dispositivo sul telefono cellulare / PC / TV.

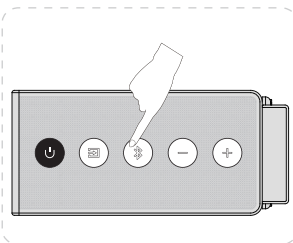

Batterie non incluse

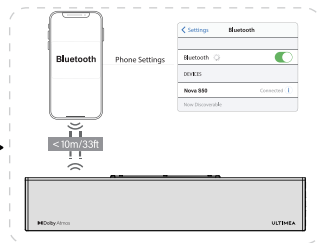
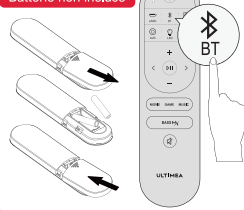

7 OPZIONI DI POSIZIONAMENTO

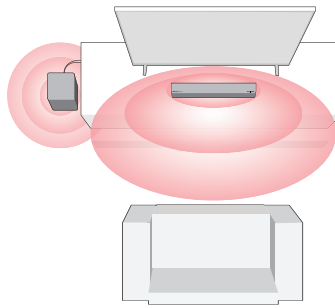

Nota: La soundbar deve essere posizionata all'altezza delle orecchie o vicino ad esse.

IT

8 INSTALLAZIONE A PARETE

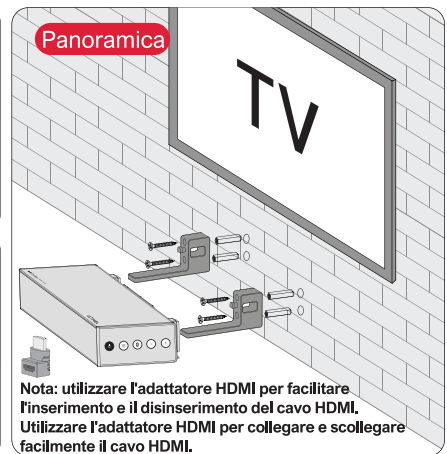
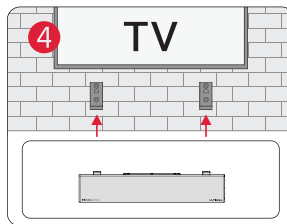
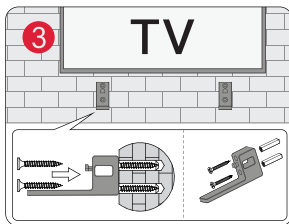
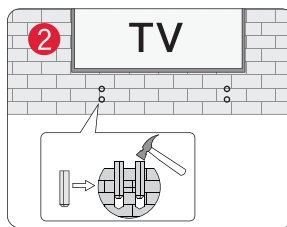
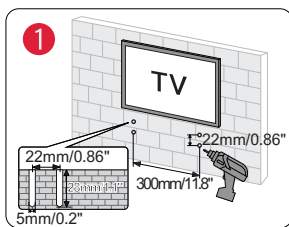

9 SPECIFICHE

Numero di modello	U2120
Alimentazione	AC 110-240V, ~50/60Hz
Driver della soundbar	(1.2" x 3.8") x 2 (Soundbar) + 5.25" (Subwoofer)
Risposta in frequenza	45Hz - 18kHz
Potenza in standby	<0.5W
Temperatura di esercizio	0°C - 45°C / 32°F - 113°F
Bluetooth Vision	5.3

Visione Bluetooth	
Soundbar	400(W) x 38(H) x 76(D)mm 15.7" x 1.5" x 3.0"
Subwoofer	270(W) x 115(H) x 270(D)mm 10.5" x 4.5" x 10.6"
Imballaggio	332(W) x 432(H) x 190(D)mm 13.1" x 17" x 7.5"
Peso netto	3.2kg / 7.05lbs
Peso lordo	4.68kg / 10.32lbs

ULTIMEA

Nova S50

Manual del usuario

ESTAMOS LISTOS PARA AYUDAR



support@ultimea.com



Nº de modelo: U2120

¿Prefiere un tutorial en vídeo?

Vídeo guía de instalación o MANUAL DE USUARIO en el sitio web de ULTIMEA.

[Twitter](#) [Facebook](#) [Instagram](#) [YouTube](#) [Spotify](#)
@ultimea_official



support.ultimea.com

ES

+1 888-598-8875 (US) Mon-Fri 9am-5pm (PST)
+49 89-628-25828 (EU) Mon-Fri 9am-5pm (CET)

1 LISTA DE ACCESORIOS

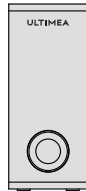

Subwoofer



Barra de sonido



Adaptador de corriente



Cable de audio estéreo de 3,5 mm a 3,5 mm

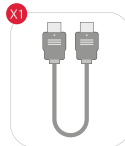

Cable HDMI

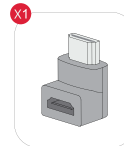

Adaptador HDMI



Cable óptico digital



Mando a distancia

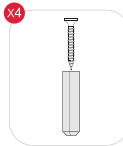

Kit de montaje en pared

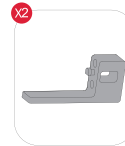

Soporte de pared



Manual del usuario

2 CONTROLES DE LA BARRA DE SONIDO

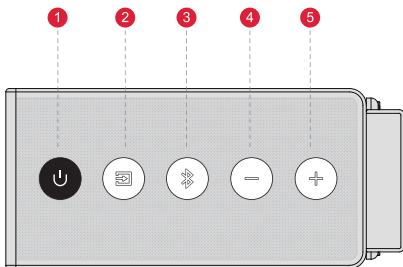

Panel de control

- 1 “”: **Botón de encendido**
Pulse para encender / Mantenga pulsado durante 3 segundos para apagar.
- 2 “”: **Modo de entrada**
Pulse para cambiar de canal: eARC-OPT-BT-AUX-USB.
- 3 “”: **BT**
Pulse para cambiar al canal BT / Mantenga pulsado durante 3 segundos para desconectar el dispositivo actual y conectarse a un nuevo dispositivo (BT ID: Nova S50).
- 4 “”: **Bajar volumen**
- 5 “”: **Subir volumen**

Mando a distancia

- 1 “U”: **Botón de encendido**
Pulse para encender / Mantenga pulsado durante 3 segundos para apagar.
- 2 “eARC”: **eARC**
Pulse para cambiar al canal HDMI eARC.
- 3 “BT”: **BT**
Pulse para cambiar al canal BT / Mantenga pulsado durante 3 segundos para desconectar el dispositivo actual y conectarse a un nuevo dispositivo. (BT ID: Nova S50).
- 4 “OPT”: **OPT**
Pulse para cambiar al canal OPTICAL.
- 5 “AUX”: **AUX**
Pulse para cambiar al canal AUX.
- 6 “USB”: **USB**
Pulse para cambiar al canal USB.
- 7 “LED”: **LED**
Pulse para encender el LED, pulse de nuevo para apagarlo.
- 8 “+”: **Subir volumen**
- 9 “-”: **Bajar volumen**
- 10 “<”: **Anterior**
Modo BT y USB: Salta a la pista anterior.
- 11 “>”: **Siguiente**
Modo BT y USB: Salta a la pista siguiente.
- 12 “▶||”: **Reproducir / Pausa**
Sólo para los modos BT y USB.
Modo USB: Mantenga pulsado durante 3 segundos para cambiar entre reproducción de bucle simple y reproducción de bucle de lista.
- 13 “MOVIE”: **MOVIE**
Pulse para cambiar al modo MOVIE.
- 14 “GAME”: **JUEGO**
Pulse para cambiar al modo JUEGO.
- 15 “MUSIC”: **MUSIC**
Pulse para cambiar al modo MÚSICA.
- 16 “BASS MX”: **BASSMX™**
Pulse para ajustar el nivel de graves, la pantalla mostrará: “B5-1”, “B5 0”, “B5 1”.
- 17 “🔇”: **Silenciar / Recuperar el volumen.**

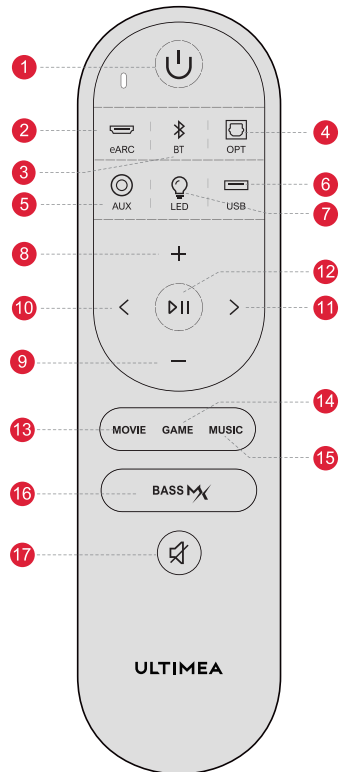

3 CONECTAR AL SUBWOOFER

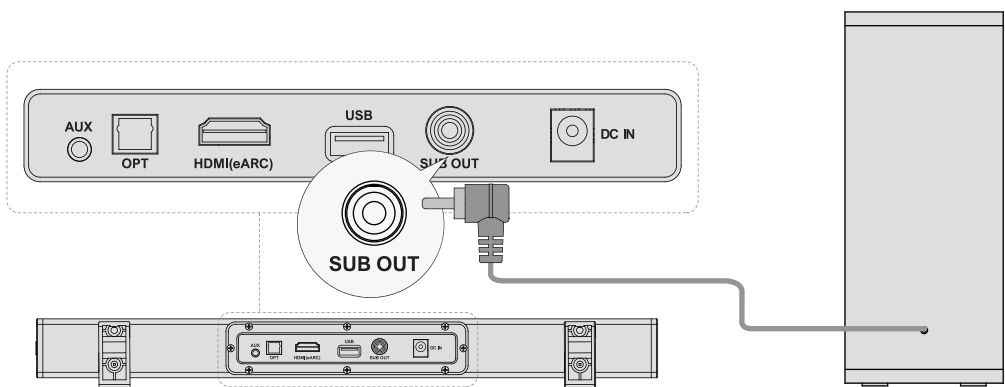

4 CONECTE AL TELEVISOR MEDIANTE HDMI eARC / ARC

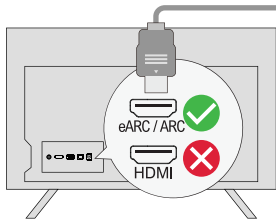

Paso 1:

Conecte un extremo del cable HDMI al puerto eARC / ARC de la parte posterior del televisor.

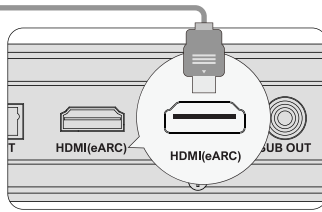

Paso 2:

A continuación, conecte el otro extremo al puerto HDMI (eARC) de la barra de sonido.

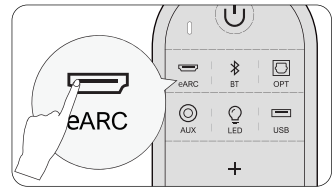

Paso 3:

Press "eARC" button on the remote control to select "HDMI (eARC)" input.

Nota:

El puerto HDMI de su televisor debe ser compatible con eARC para transmitir el formato de audio Dolby Atmos a su Soundbar.

Atmos: Si está viendo una película en formato Dolby Atmos, ajuste la salida de audio del televisor en Pass Through:

Ajustes TV > Inicio > Ajustes > Sonido > Salida de audio digital > Pass Through.

DTS: Si está viendo una película en formato DTS, configure la salida de audio del televisor como PCM:

Ajustes TV > Inicio > Ajustes > Sonido > Salida de audio digital > PCM

¿Cuál es la diferencia entre: HDMI IN, HDMI ARC, HDMI eARC?

HDMI IN es una entrada HDMI estándar que permite conectar dispositivos al televisor o al sistema de audio. Admite señales de audio y vídeo, pero no es compatible con las funciones de canal de retorno de audio (ARC) o canal de retorno de audio mejorado (eARC).

HDMI ARC es un puerto HDMI especial que permite la comunicación bidireccional entre el televisor y el sistema de audio. Esto significa que el audio puede enviarse desde el televisor al sistema de audio, y el sistema de audio puede devolver el audio al televisor.

HDMI eARC (canal de retorno de audio mejorado) es una versión actualizada de HDMI ARC que admite formatos de audio de mayor calidad, como Dolby Atmos y DTS:X.

Nota: Active la función "CEC" en su televisor.

Cuando eARC / ARC está conectado, el mando a distancia del televisor puede controlar la barra de sonido y el televisor simultáneamente:

- 1 Encender / apagar
- 2 Ajustar el volumen

5 CONEXIÓN AL TELEVISOR VÍA ÓPTICA / AUX

ÓPTICA

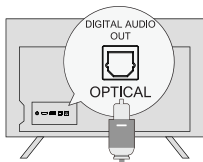

OPCIÓN 1: ÓPTICA

- 1 Asegúrese de que el cable está conectado al puerto OPTICAL OUT del televisor y el otro extremo al puerto OPTICAL de la barra de sonido.
- 2 Asegúrese de que el conector óptico está insertado correctamente como se muestra en la imagen. No inserte el enchufe al revés y rompa el conector óptico.

Nota: Si se reproduce audio por los altavoces internos del televisor, silencio o minimice el volumen del televisor.

AUX

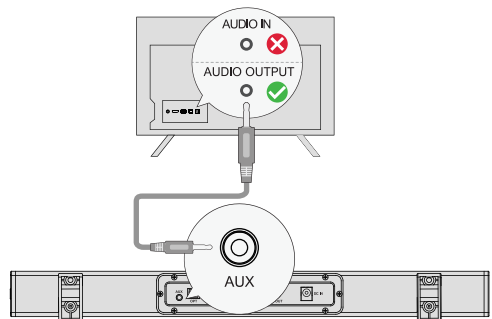

OPCIÓN 2: AUX

- 1 Conecte el cable de audio de 3,5 mm a 3,5 mm al puerto RCA AUDIO OUT de su televisor.
- 2 No es compatible con el puerto AUDIO IN del televisor.

Nota: Recuerde desconectar el cable AUX de la TV y de la barra de sonido cuando desee utilizar otro modo.

En modo óptico: Si no hay sonido, pruebe a ajustar la salida de audio del televisor a PCM:

Ajustes TV > Inicio > Ajustes > Sonido > Salida de audio digital > PCM

6 CONECTAR CON BLUETOOTH

- 1 Pulse el botón "BT" de la barra de sonido o del mando a distancia para acceder al modo de emparejamiento Bluetooth.
- 2 Abra la configuración Bluetooth de su teléfono, busque y seleccione "Nova S50" para conectar la barra de sonido.

Nota: Si ya está en modo Bluetooth y conectado, mantenga pulsado el botón "BT" durante 3 segundos para desconectar el dispositivo actual y conectarse a un nuevo dispositivo manualmente en su teléfono móvil / PC / TV.

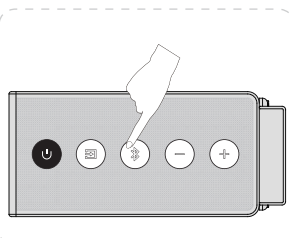

Pilas no incluidas

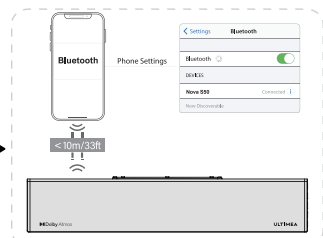
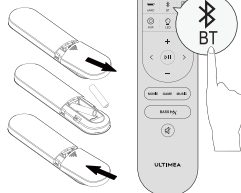

7 OPCIONES DE COLOCACIÓN



ES

8 INSTALACIÓN MURAL

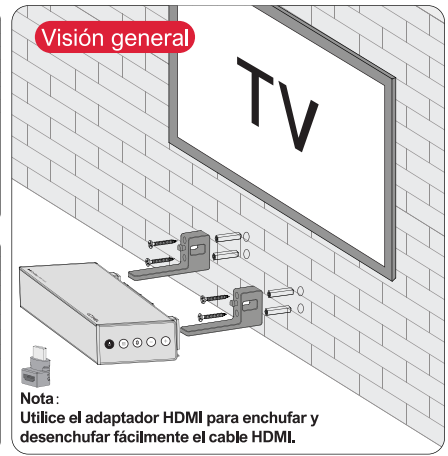
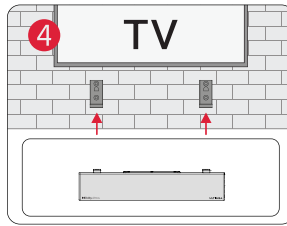
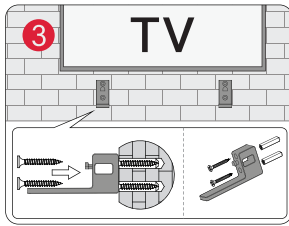
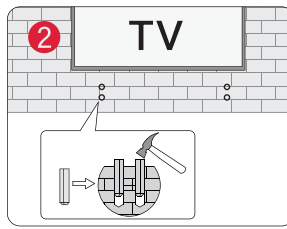
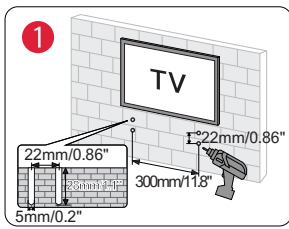

9 ESPECIFICACIONES

Número de modelo	U2120
Fuente de alimentación	AC 110-240V, ~50/60Hz
Controladores de la barra de sonido	(1.2" x 3.8") x 2 (Soundbar) + 5.25" (Subwoofer)
Respuesta en frecuencia	45Hz - 18kHz
Energía de reserva	<0.5W
Temperatura de funcionamiento	0°C - 45°C / 32°F - 113°F
Visión Bluetooth	5.3

Dimensiones y peso	
Soundbar	400(W) x 38(H) x 76(D)mm 15.7" x 1.5" x 3.0"
Subwoofer	270(W) x 115(H) x 270(D)mm 10.5" x 4.5" x 10.6"
Embalaje	332(W) x 432(H) x 190(D)mm 13.1" x 17" x 7.5"
Peso neto	3.2kg / 7.05lbs
Peso bruto	4.68kg / 10.32lbs

SAFETY INSTRUCTIONS

Please read this user manual carefully and save it for future reference.

Do not make unauthorized alterations to the product, doing so may compromise safety, regulatory compliance, system performance, and may void the warranty.

- Avoid dropping.
- Do not disassemble.
- Do not submerge in water
- Avoid extreme temperatures.
- Do not use the device outdoors during thunderstorms.
- Use original or certified cables.
- Do not place dangerous items on top of this device (e.g. liquid filled objects, lit candles).
- Clean with a dry, soft lint-free cloth. Do not use any corrosive cleaner or oil.
- To avoid hearing damage, do not listen for extended periods at high volume.
- Do not expose the batteries to extreme heat sources such as direct sunlight or open flames.
- The ideal operating temperature for this product and its accessories is between 41°F/5°C and 95°F/35°C.
- The adapter should be installed near the device and should be easily accessible.
- Do not use this product in environments of extreme heat or cold. Never expose this device to strong sunshine or wet environments.

PROPER DISPOSAL INSTRUCTIONS



This mark shown on the product or its packaging, indicates that this product should not be disposed of with other household waste at the end of its working life.

To prevent possible harm to the environment or human health from uncontrolled waste disposal, please separate this from other types of wastes and recycle it responsibly to promote the sustainable reuse of material resources.

Waste Electrical & Electronic Equipment

Household user should contact either the retailer where they purchased this product, or their local government office, for details of where and how they can take this item for environmentally safe recycling. Business users should contact their suppliers and check the terms and conditions of the purchase contract. This product should not be mixed with other commercial wastes for disposal.

FCC REGULATORY COMPLIANCE

NOTE: This equipment has been tested and found to comply with the limits for a Class B digital device, pursuant to part 15 of the FCC Rules. These limits are designed to provide reasonable protection against harmful interference in a residential installation. This equipment generates uses and can radiate radio frequency energy and, if not installed and used in accordance with the instructions, may cause harmful interference to radio communications.

However, there is no guarantee that interference will not occur in a particular installation. If this equipment does cause harmful interference to radio or television reception, which can be determined by turning the equipment off and on, the user is encouraged to try to correct the interference by one or more of the following measures:

- Reorient or relocate the receiving antenna. - Increase the separation between the equipment and the receiver.
- Connect the equipment to an outlet on a circuit different from that to which the receiver is connected.
- Consult the dealer or an experienced radio / TV technician for help.

Any changes or modifications not expressly approved by the party responsible for compliance could void the user's authority to operate the equipment.

This device complies with Part 15 of the FCC Rules.

Operation is subject to the following two conditions:

- (1) this device may not cause harmful interference.
- (2) this device must accept any interference received, including interference that may cause undesired operation.

This equipment complies with FCC radiation exposure limits set forth for an uncontrolled environment. This equipment should be installed and operated with a minimum distance of 20cm between the radiator & your body. This transmitter must not be co-located or operating in conjunction with any other antenna or transmitter.

ISED WARNINGS

This device contains licence-exempt transmitter (s) / receiver (s) that comply with Innovation, Science and Economic Development Canada's licence-exempt RSS (s). Operation is subject to the following two conditions:

- (1) This device may not cause interference.
- (2) This device must accept any interference, including interference that may cause undesired operation of the device.

L'émetteur/récepteur exempt de licence contenu dans le présent appareil est conforme aux CNR d'Innovation, Sciences et Développement économique Canada applicables aux appareils radio exempts de licence. L'exploitation est autorisée aux deux conditions suivantes:

- (1) L'appareil ne doit pas produire de brouillage;
- (2) L'appareil doit accepter tout brouillage radioélectrique subi, même si le brouillage est susceptible d'en compromettre le fonctionnement.

This equipment complies with IC exposure limits set forth for an uncontrolled environment. This equipment shall be installed and operated with a minimum distance of 20cm between the radiator & body.

Cet équipement est conforme aux limites d'exposition IC définies pour un environnement non contrôlé. Cet équipement doit être installé et utilisé avec une distance minimale de 20cm entre le radiateur et la carrosserie.

Declaration of Conformity

We (Manufacturer is responsible for this declaration)
Dyanic (Shenzhen) Technology Limited
(Company name)

20th Floor, Building 4, Tianan Cloud Park, Bantian St.,
Longgang District Shenzhen, China 518000
(Company address)

Declare under our sole responsibility that the product
Trade Mark: ULTIMEA
Product Name: Nova S50 2.1 Channel Virtual Atmos Soundbar
Model No.: U2120
To which this declaration relates is in conformity with
the essential
requirement set out in the Council Directive on the
Approximation of the laws of the Member States
relating to RED Directive (2014/53/EU) & RoHS (2011/
65/ EU) product is responsible to affix CE marking, the
following standards were applied:

EN 55032:2015/A11:2020
EN 55035:2017/A11:2020
ENIEC 61000-3-2:2019
EN 61000-3-3:2013/A1:2019
ETSIEN 301 489-1 V2.2.3(2019-11)
ETSIEN 301 489-17 V3.2.4(2020-09)
EN 300 328 V2.2.2(2019-07)
EN 50663:2017
ENIEC 62368-1:2020+A11:2020
IEC62321-3-1:2013
IEC 62321-4:2013+A1:2017
IEC 62321-5:2013
IEC 62321-6:2015
IEC 62321-7-1:2015
IEC 62321-7-2:2017
IEC 62321-8:2017

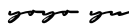
Full Name: Yoyo.Yu
Position: Approbation Manager
Signature: 
Place/Date: Shenzhen, China/Dec. 25-2022

Trade Marks:



Dolby, Dolby Audio, Dolby Vision, Dolby Atmos, and the double-D symbol are trademarks of Dolby Laboratories Licensing Corporation. Manufactured under license from Dolby Laboratories. Confidential unpublished works. Copyright© 1992-2020 Dolby Laboratories. All rights reserved.



The Bluetooth® word mark and logos are registered trademarks owned by Bluetooth SIG, Inc. and any use of such marks by Soundlab Technology Co.,Ltd. is under license. Other trademarks and trade names are those of their respective owners.



The Adopted Trademarks HDMI, HDMI High-Definition Multimedia Interface, HDMI trade dress and the HDMI Logos are trademarks or registered trademarks of HDMI Licensing Administrator, Inc. in the United States and other.

ULTIMEA



Nova S50 2.1 Channel Virtual Atmos Soundbar
Model No.: U2120

 Dyanic GmbH
Buchening 57, 22359 Hamburg, Germany

 UK Crossborder limited
7 Bell Yard London WC2A 2JR, UK United Kingdom
Made in China

Manufacturer: Dyanic (Shenzhen) Technology Limited
Address: 20th Floor, Building 4, Tianan Cloud Park, Bantian St.,
Longgang District, Shenzhen, China 518000

If you need our support, kindly reach out to our
service team. We are always glad to help.

 +1 888-598-8875 (US)
Mon-Fri 9am-5pm (PST)
+49 89-628-25828 (EU)
Mon-Fri 9am-5pm (CET)
 support@ultimea.com
support@ultimea.de
 support.ultimea.com
support.ultimea.de



@ultimea_Official