

ULTIMEA QUICK START GUIDE

Tapio VII



Model No.: U3100

WE ARE READY TO HELP



Support@ultimea.com

Prefer video tutorial?

Setup guidance video, or USER MANUAL on ULTIMEA website.



www.ultimea.com

1 CHECKING THE COMPONENTS

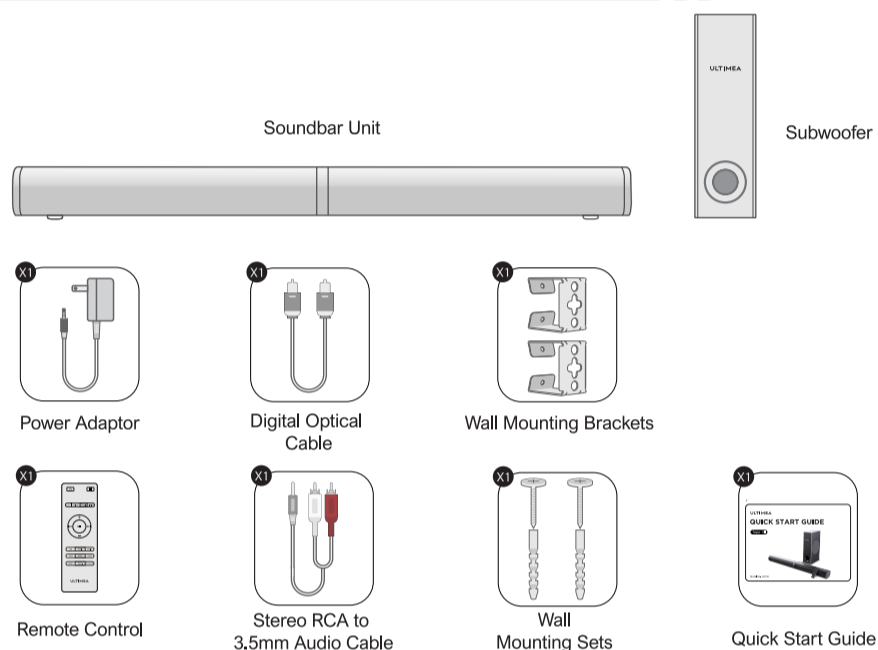

2 BLUETOOTH CONNECTION

Bluetooth Connection

- Press "BT" on the remote control or "BT" button on soundbar to enter bluetooth mode.
- Turn on Bluetooth setting of your phone and choose name of "ULTIMEA Tapio VII" to connect soundbar.

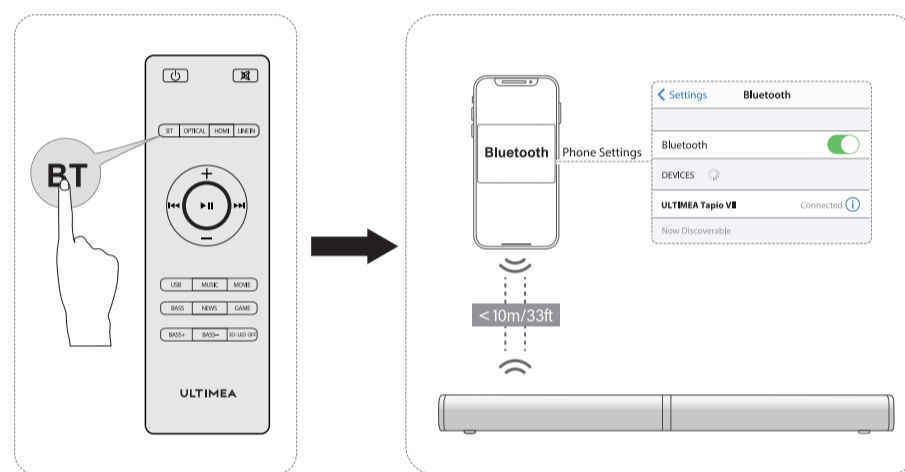

3 CONNECT TO TV

Are there any HDMI IN jacks labeled "ARC" on your TV?

YES

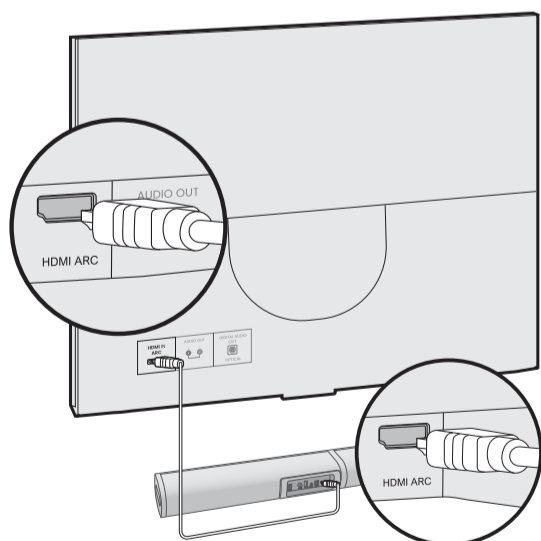

OPTION 1(Preferred): HDMI ARC

NOTE:

1. HDMI Connection is unavailable if your TV does not support HDMI ARC.
2. Connecting via HDMI(ARC) enable the following functions using the TV's remote control:
Turn the TV and soundbar on/off and adjust the volume simultaneously. (Support CEC function)

NO

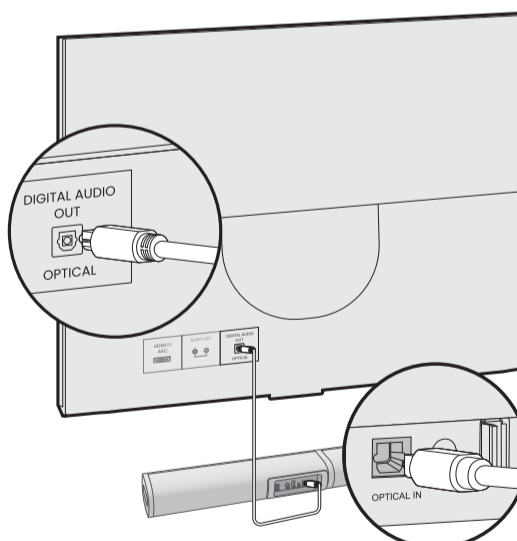

OPTION 2 : OPTICAL

NOTE:

1. Make sure the TV's port is Optical OUT.
2. If the sound is coming from TV's internal speaker, mute the TV speaker or volume is minimized.

NO

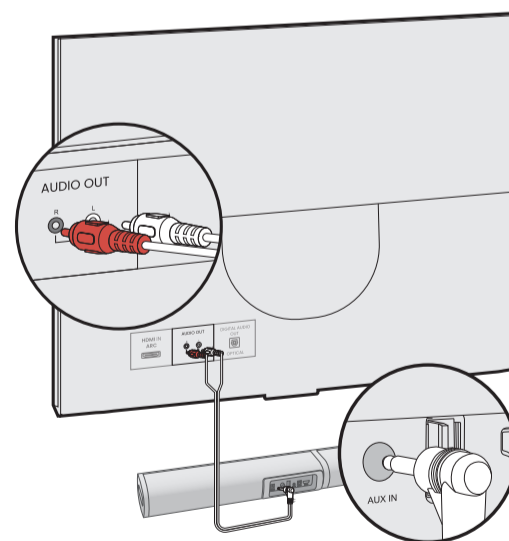

OPTION 3 : AUX

NOTE:

1. Use the 3.5mm to RCA audio cable to connect to your TV's RCA AUDIO OUT port.
2. Make sure that the cable ends match the color of TV ports.

4 CONTROL THE SOUNDBAR

Control Panel

- 1 Press to switch on.
Hold for 3s to switch off.
- 2 Volume down.
- 3 Volume up.
- 4 Press to switch to "BT" mode.
Hold for 3s to disconnect.

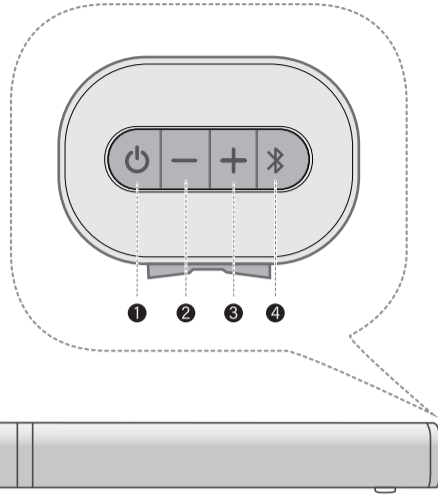

Remote Control

- 1 Power: Turn on the soundbar or set it to standby.
- 2 Mute: Mute the sound.
- 3 Input Channel: Bluetooth, Optical, HDMI ARC, AUX.
- 4 Adjustable Panel: Volume Up, Volume Down, Previous Track, Next Track, Play/Pause
- 5 EQ Modes: MUSIC, MOVIE, BASS, NEWS, GAME
- 6 Bass Volume Adjustment
- 7 Bonus Function:
3D: Press to switch on/off 3D effect.
LED OFF: Hold for 3S to switch on/off the LED display.

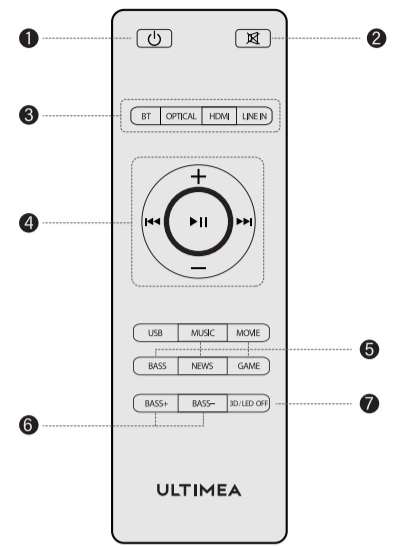

5 WALL MOUNTING INSTALLATION STEPS

Wall Mounting:

1. Remove 4 screws as shown ①.
2. Secure the hardware wall bracket ② in the accessory box with the screws you just removed and lock it in the position as shown ①.
3. Follow steps ③-⑥ in the following illustration and hang the soundbar on the wall.

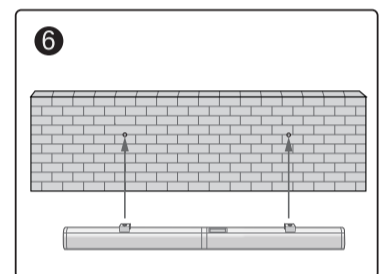
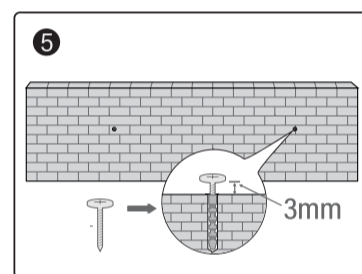
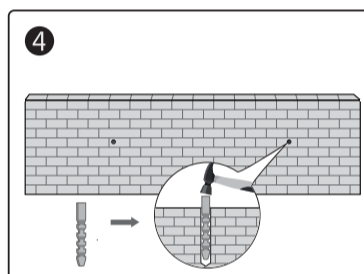
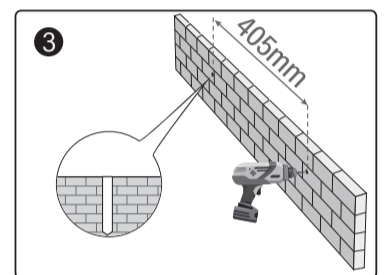
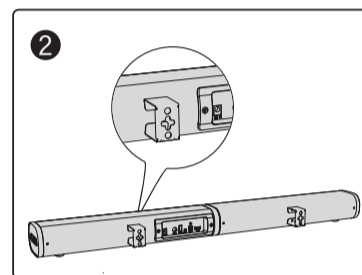
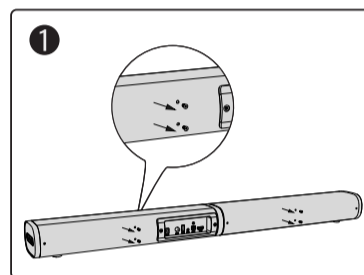
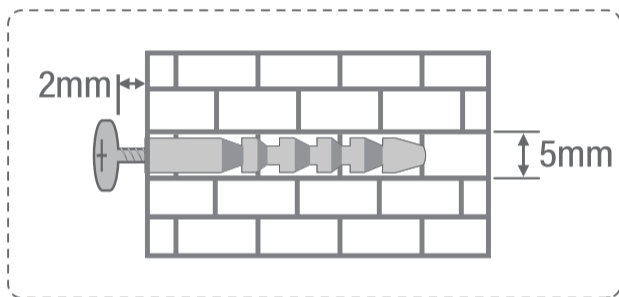

6 NOTES FOR TV AUDIO SETTINGS OF VARIOUS BRAND

! Very Important!!!

How to Set up the Soundbar and TV? Normally as below:
Settings → Audio → Digital Audio Format → PCM



More examples for various TV brands:

Samsung TV

- Settings > Sound > Sound output > select Receiver (HDMI)
- Settings > Sound > Expert Settings > Digital Output Audio Format > PCM
- Settings General > External Device Manager > AnyNet+ (HDM - CEC) > ON

Vizio TV

- Settings > Audio > TV Speakers > Off
- Settings > Audio > Digital Audio Out > PCM
- Settings > System > CEC > Enabled

Sony TV

- Settings > Display & Sounds > Audio Output > Speakers > Audio System
- Settings > Display & Sounds > Audio Output > Digital Audio Out > PCM
- Settings > Display & Sounds > Audio Output > Pass Through Mode > OFF
- Settings Channels & Inputs > External inputs > BRAVIA Sync > BRAVIA Sync control > ON

LG TV

- All Settings > General - Devices > HDMI Settings > SIMPLINK (HDMI - CEC) > ON
- All Settings > Sound > Advances Settings > Digital Sound Output > PCM
- All Settings > Sound > Sound Out > Use Wired Speaker > HDMI (ARC) Device

TCL ROKU TV

- Settings > Audio > Audio output > Auto
- Settings > Audio > Digital audio format > Select Stereo

Hisense ROKU TV

- Settings > Audio > TV Speakers > Select Disabled
- Settings > Audio > Digital Audio out > Select Stereo

ONN ROKU TV

- Settings > Audio > TV Speakers > Select Disabled
- Settings > Audio > Digital Audio Format > Select Stereo

Insignia Fire TV

- Settings Display & Sounds > Audio Output > TV Speakers > select OFF
- Settings Display & Sounds > Audio Output > Digital Audio Format > select PCM
- Settings Display & Sounds > HDMI CEC Device Control > ON

Toshiba Fire TV

- Settings > Display & Sounds > Audio Output > TV Speakers > select OFF
- Settings > Display & Sounds > Audio Output > Digital Audio Format > select PCM
- Settings > Display & Sounds > HDMI CEC Device Control > ON

Panasonic TV

- Menu Audio Settings > Advanced Audio > TV Speakers > select OFF
- Menu > Audio Settings > Advanced Audio > HDMI > select DIGITAL
- Menu > Audio Settings > Advanced Audio > Digital Audio Out > select PCM

Sharp TV (Powered by Android)

- settings > devices preferences > sound > Digital Output > select PCM
- settings > devices preferences > sound > Speakers > External audio system

Roku TV Stick

- Settings > Audio > Digital Output Format > Stereo
- Settings > Audio > Audio Mode > Select Stereo

Fire TV stick

- Settings > Display & Sounds > Audio > Surround Sound > PCM
- Settings > Display & Sounds > HDMI CEC Device Control > ON

Hisense ROKU TV

- Settings > Audio > TV Speakers > Select Disabled
- Settings > Audio > Digital Audio out > Select Stereo

ONN ROKU TV

- Settings > Audio > TV Speakers > Select Disabled
- Settings > Audio > Digital Audio Format > Select Stereo

TCL TV (Powered by Android)

- TV Settings > Audio > Advanced Settings > Digital Audio Out > Select PCM

TV Settings > System > T - Link > Select ON

Hisense TV (Powered by Android)

- Settings > Sound > Speakers > select ARC
- Settings > Sound > Advanced Settings > Digital Audio Out > select PCM

Sharp TV

- Settings > sound > Advanced audio settings > TV Speaker & ARC > select ARC
- Settings > sound > Advanced audio settings > Digital Audio Out > select PCM

If you don't find your TV Brand or streaming devices here, please contact us at: Support@ultimea.com