

ULTIMEA

 Bluetooth®

 AURACAST™  
A BLUETOOTH® TECHNOLOGY



# User Manual

SUB 10

Model No.: UW220

10-inch Active Subwoofer with Wireless Connectivity

## 1 IMPORTANT SAFETY INSTRUCTIONS

- Please read and keep these instructions. Follow all warnings and operate according to the instructions.
- Do not use the device near water, in damp environments, or in the rain. Avoid spilling liquids on the device or placing objects containing liquids (such as vases) on top of it.
- Clean only with a dry cloth. Do not use liquid cleaners.
- Do not block ventilation openings or install the device in a confined space. Ensure proper ventilation and install the device according to the manufacturer's instructions.
- Do not install the device near heat sources such as radiators, stoves, amplifiers, or other devices that produce heat. Do not cover the ventilation openings with items like newspapers or curtains.
- Only use attachments, stands, or accessories specified by the manufacturer. When using equipment with wheels, exercise caution when moving to prevent tipping.
- Protect the power cord from being walked on, pinched, or bent, especially at plugs, convenience receptacles, and the point where they exit from the device.
- Do not modify the plug's polarization or grounding features. If the plug does not fit into the outlet, consult an electrician to replace the outlet.
- Unplug the power cord during lightning storms or when not in use for long periods. To completely disconnect the device from the power supply, unplug it from the wall outlet and ensure the plug is easily accessible.
- Do not place any open flame sources, such as lit candles, on the device.
- Do not attempt to open the device. High voltage inside may cause electric shock or death. There are no user-serviceable parts inside. All servicing must be performed by qualified personnel.
- The installation height of the device must not exceed 2 meters.

## 2 ACCESSORIES LIST

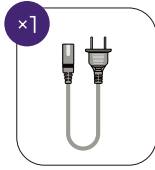
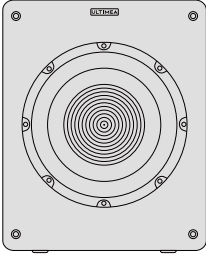

Power Cable

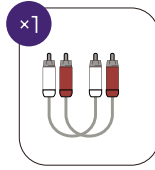

RCA Cable

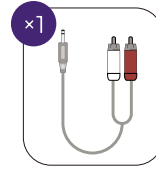

3.5mm to  
RCA Cable

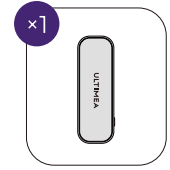

Wireless Dongle

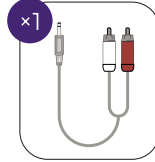

Dongle 3.5mm to  
RCA Cable (20cm)

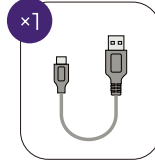

Dongle USB  
Power Cable (1m)



User Manual

## 3 BACK PANEL FEATURES

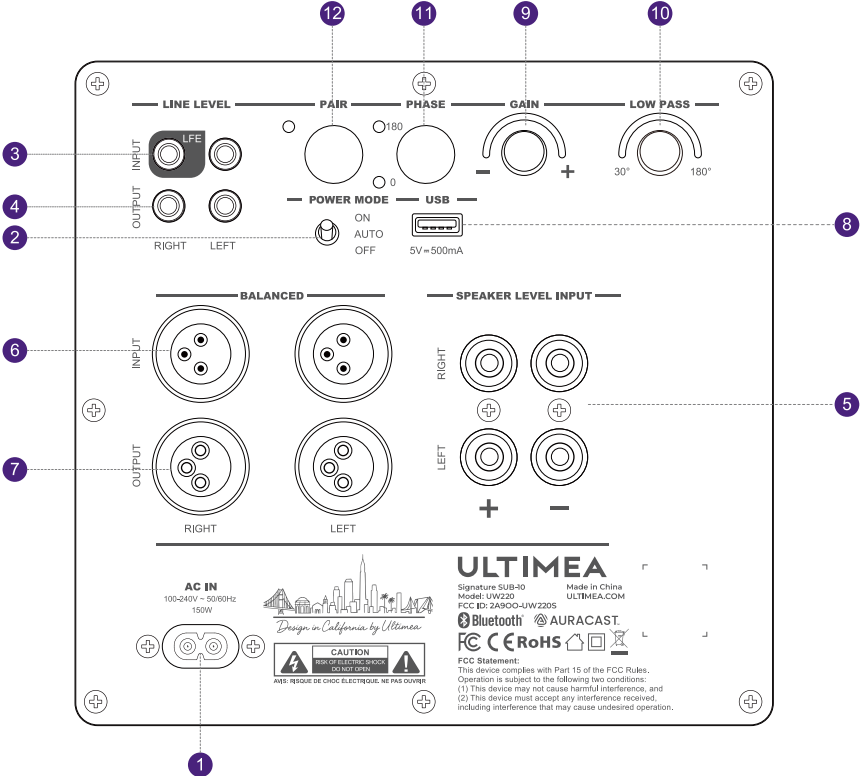

**1 AC Power Cord Receptacle**

**2 Power Mode Switch - Turns Subwoofer On/Auto/Off**

**3 Unbalanced (RCA) Line Level Inputs**

**4 Unbalanced (RCA) Line Level Outputs**

**5 High Level (Speaker Level) Inputs**

This connection method is for 2-channel stereo applications where the integrated amp or preamp/ amplifier only has speaker-level outputs.

**6 Balanced Inputs**

**7 Balanced Outputs**

**8 USB Type A Port**

Used for Firmware updates and powering a USB device.

**9 GAIN**

Rotate this button to adjust the volume.

**10 LOW PASS**

Rotate this button to adjust the low-pass filter frequency to ensure a smooth transition.

**11 PHASE**

Rotate this button to adjust the phase.

Connecting to the app allows for more precise adjustments.

**12 PAIR**

Press and hold this button for 3 seconds to enter Dongle pairing mode; press twice to connect to enter AuraCast receiver mode.

## 4 AC Power Connection

Connect the subwoofer power cord to the subwoofer amplifier and directly into an AC outlet. Convenience outlets located on the rear panel of some AV receivers or pre/pros are NOT recommended for your Signature SUB 10 as these outlets are not meant for high power devices.

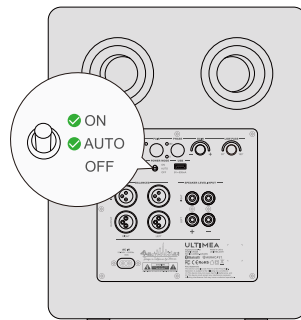
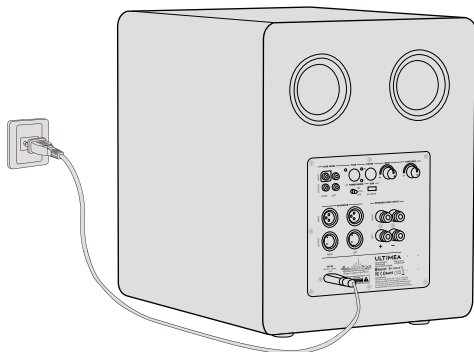

## 5 Line-Level Connection

### Single LFE Channel

The most common method to connect your Signature SUB 10 is by using a single RCA interconnect from the LFE or SUB1 output of your AV receiver or preamplifier to the LFE input on the Signature SUB 10.

This configuration allows the AVR or processor to handle all bass management upstream and deliver a pre-filtered mono LFE signal directly to the subwoofer.

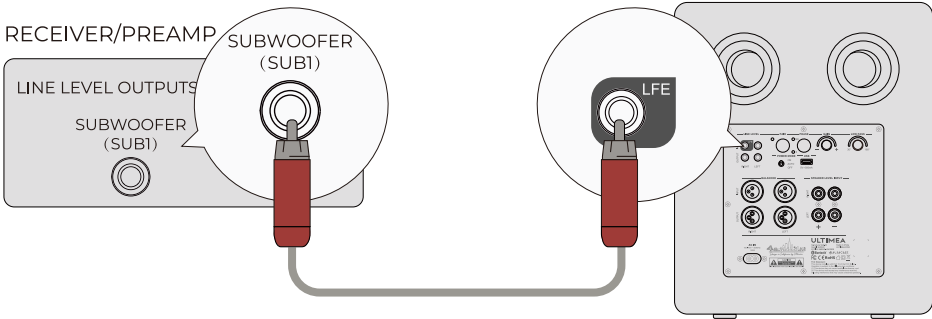

## 6 Stereo Receiver or Preamplifier Left/Right Channels

### Stereo Receiver or Preamplifier Left/Right Channels

Connect the Left and Right line-level outputs of your stereo preamplifier to the Left and Right inputs on the Signature SUB 10 using RCA cables for a two-channel stereo connection.

RECEIVER/PREAMP

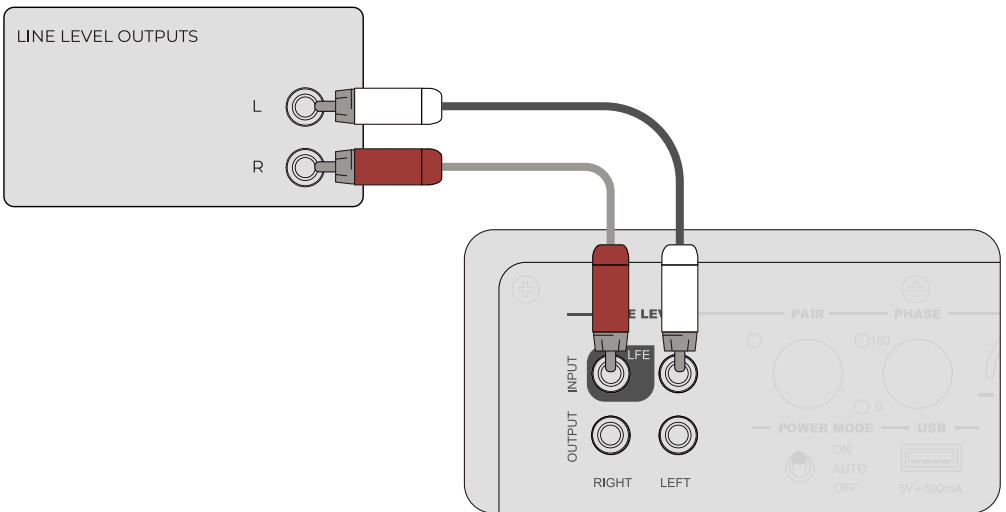

## 7 High Level (Speaker Level) Connection - Multi-Channel/Stereo Applications

Use this method when your amplifier only has high-level (speaker-level) outputs. Connect the L/R speaker outputs of the amplifier to both your main speakers and the subwoofer's L/R speaker-level inputs using two sets of speaker wires.

Set the low-pass filter to match your speakers' natural roll-off, adjust the gain to blend levels, and fine-tune the phase for the most coherent soundstage and smooth integration with your speakers.

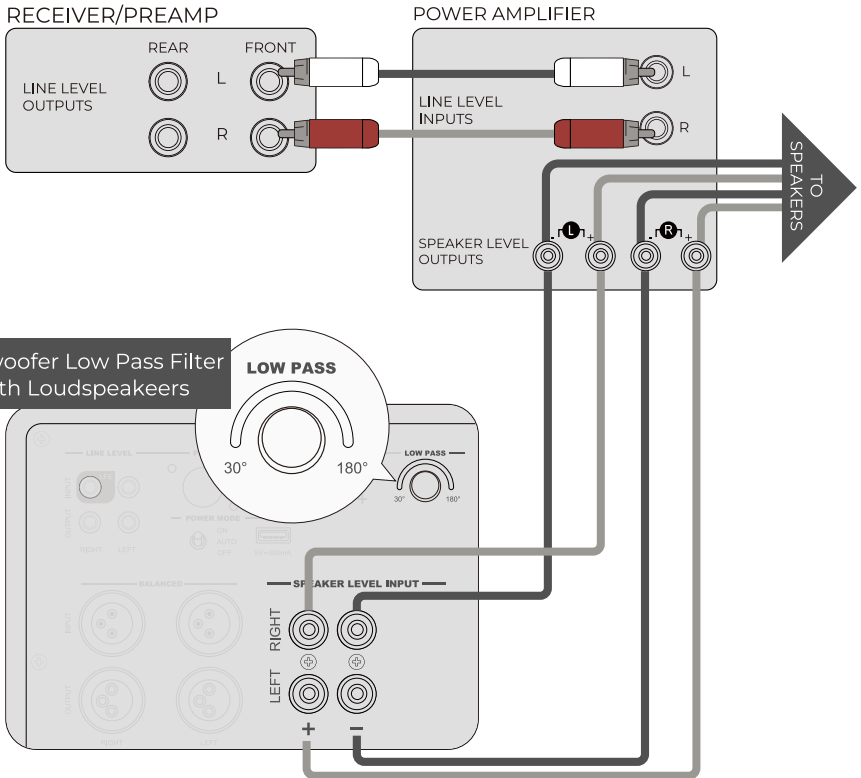

## 8 XRL Connection

### XLR INPUT

Accepts a balanced line-level signal from a preamplifier, processor, mixer, or any device with XLR outputs.

### XLR OUTPUT

Passes the incoming balanced signal through to another device, such as an active speaker, power amplifier, or an additional subwoofer.

## PREAMP/AV PROCESSOR

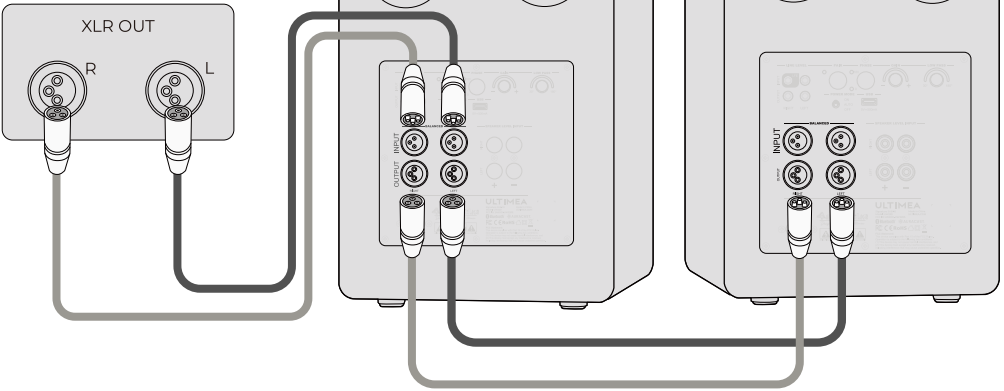

## 9 Wireless Connection

The Dongle and subwoofer are pre-paired at the factory.

If they disconnect, press and hold the Dongle's "PAIR" button for 8 seconds until the blue light flashes quickly. Then press and hold the subwoofer's "PAIR" button for 5 seconds to enter pairing mode.

One Dongle can connect to two subwoofers. To pair a second subwoofer, press and hold the Dongle's "PAIR" button for 5 seconds until the blue light flashes quickly, then press and hold the "PAIR" button on the second subwoofer for 5 seconds.

## RECEIVER/PREAMP

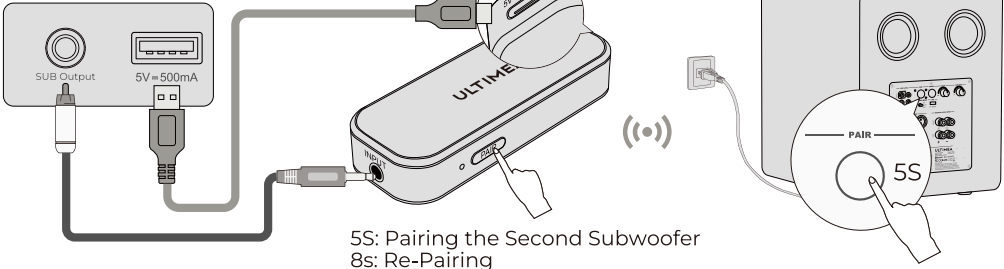

## 10 Receive AuraCast Broadcast

Press "PAIR" twice consecutively to enter AuraCast RX pairing mode.  
The indicator will flash purple rapidly.

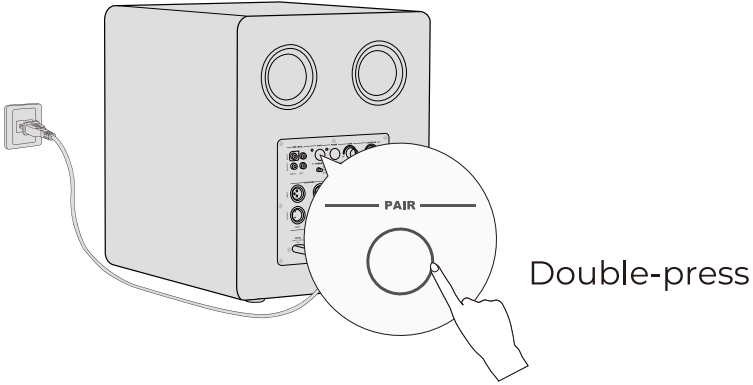

## 11 Restore factory settings

Press and hold the "PHASE" button for 8 seconds to restore factory settings.

## PROPER DISPOSAL INSTRUCTIONS



This mark shown on the product or its packaging, indicates that this product should not be disposed of with other household waste at the end of its working life. To prevent possible harm to the environment or human health from uncontrolled waste disposal, please separate this from other types of wastes and recycle it responsibly to promote the sustainable reuse of material resources.

## Waste Electrical & Electronic Equipment

Household user should contact either the retailer where they purchased this product, or their local government office, for details of where and how they can take this item for environmentally safe recycling. Business users should contact their suppliers and check the terms and conditions of the purchase contract. This product should not be mixed with other commercial wastes for disposal.

## WIRELESS FREQUENCY RANGE AND WIRELESS OUTPUT POWER:

Frequency: 2.402GHz-2.48GHz,5.8GHz

## FCC REGULATORY COMPLIANCE

Any changes or modifications not expressly approved by the party responsible for compliance could void the user's authority to operate the equipment.

This device complies with Part 15 of the FCC Rules.

Operation is subject to the following two conditions:

- (1) This device may not cause harmful interference.
- (2) This device must accept any interference received, including interference that may cause undesired operation.

NOTE: This equipment has been tested and found to comply with the limits for a Class B digital device, pursuant to part 15 of the FCC Rules. These limits are designed to provide reasonable protection against harmful interference in a residential installation. This equipment generates, uses, and can radiate radio frequency energy, and if not installed and used in accordance with the instructions, may cause harmful interference to

radio communications.

However, there is no guarantee that interference will not occur in a particular installation. If this equipment does cause harmful interference to radio or television reception, which can be determined by turning the equipment off and on, the user is encouraged to try to correct the interference by one or more of the following measures:

- Reorient or relocate the receiving antenna.
- Increase the separation between the equipment and the receiver.
- Connect the equipment to an outlet on a circuit different from that to which the receiver is connected.
- Consult the dealer or an experienced radio / TV technician for help.

This equipment complies with FCC radiation exposure limits set forth for an uncontrolled environment. This equipment should be installed and operated with a minimum distance of 20cm between the radiator & your body. This transmitter must not be co-located or operating in conjunction with any other antenna or transmitter.

## ISED WARNINGS

This device contains licence-exempt transmitter(s)/receiver(s) that comply with Innovation, Science and Economic Development Canada's licence-exempt RSS(s). Operation is subject to the following two conditions:

- (1) This device may not cause interference.
- (2) This device must accept any interference, including interference that may cause undesired operation of the device.  
L'émetteur/récepteur exempt de licence contenu dans le présent appareil est conforme aux CNR d'Innovation, Sciences et Développement économique Canada applicables aux appareils radio exempts de licence. L'exploitation est autorisée aux deux conditions suivantes:
  - 1) L'appareil ne doit pas produire de brouillage;
  - 2) L'appareil doit accepter tout brouillage radioélectrique subi, même si le brouillage est susceptible d'en compromettre le fonctionnement.
- (3) The device meets the exemption from the routine evaluation limits in issue 6 of RSS 102 and compliance with RSS-102 RF exposure, users can obtain Canadian information on RF exposure and compliance.  
Le dispositif rencontre l'exemption des limites courantes d'évaluation dans le numéro 6 de

RSS 102 et la conformité à l'exposition de RSS-102 rf, utilisateurs peut obtenir l'information canadienne sur l'exposition et la conformité de rf.

This transmitter must not be co-located or operating in conjunction with any other antenna or transmitter. This equipment should be installed and operated with a minimum distance of 20 centimeters between the radiator and your body.

Cet émetteur ne doit pas être Co-placé ou ne fonctionnant en même temps qu'aucune autre antenne ou émetteur. Cet équipement devrait être installé et actionné avec une distance minimum de 20 centimètres entre l'émetteur et votre corps.

## CE WARNINGS

- 1) Do not install this equipment in a confined or building-in space such as a book case or similar unit, and remain a well ventilation conditions. The ventilation should not be impeded by covering the ventilation openings with items such as newspaper, table-cloths, curtains etc.
- 2) WARNING: To reduce the risk of fire or electric shock, do not expose this apparatus to rain or moisture. The apparatus shall not be exposed to dripping or splashing and that objects filled with liquids, such as vases, shall not be placed on apparatus.
- 3) WARNING: The adapter plug is used as disconnect device, the disconnect device shall remain readily operable.
- 4) Frequency: 2.402GHz-2.48GHz,5.8GHz
- 5) The Max. transmit power: 13.03 dBm

## Wireless Capability Description:

The subwoofer and two surround speakers connect wirelessly but function solely as signal receivers without relaying or forwarding data. The remote control uses infrared (IR) technology for device operation and does not support other wireless transmission or reception. An IR transmitter on the rear of the Soundbar is used exclusively to relay remote control signals and does not support any other wireless communication.

**⚠ WARNING:** This product can expose you to chemicals including lead, which is known to the State of California to cause cancer and birth defects or other reproductive harm. For more information, go to [www.P65Warnings.ca.gov](http://www.P65Warnings.ca.gov).

## Safety Instructions

- (1) Read this manual carefully.
- (2) Keep this manual for future reference.
- (3) Pay attention to and follow all warnings.
- (4) Follow all operating instructions.
- (5) Do not use this device near water.
- (6) Clean only with a dry, soft cloth.
- (7) Install the device only as instructed by the manufacturer.
- (8) Do not install the device near any heat sources such as radiators, heaters, stoves, or other equipment that produces heat (including amplifiers).
- (9) Do not defeat the safety purpose of polarized or grounding-type plugs. If the plug does not fit into the outlet, consult an electrician to replace the outlet.
- (10) Protect the power cord from being walked on or pinched, especially at plugs, sockets, and the point where the cord exits the device.
- (11) Use only attachments or accessories specified by the manufacturer.
- (12) Unplug the device during lightning storms or when unused for long periods of time.
- (13) All servicing must be performed by qualified service personnel. Servicing is required if the power cord or plug is damaged, liquid or objects have entered the device, the device has been exposed to moisture or water, does not operate normally, or has been dropped.
- (14) Do not expose the device to dripping or splashing liquids. Do not place objects filled with liquids, such as vases, on the device.
- (15) To completely disconnect the device from the AC power, unplug the power cord from the wall outlet.
- (16) The power plug must remain readily accessible.
- (17) Do not overload wall outlets or extension cords, as this may result in electric shock or fire.



More safety info via QR code  
Weitere Sicherheitshinweise per QR-Code  
QRコードで安全情報を見る

Trade Marks:



The Bluetooth® word mark and logos are registered trademarks owned by Bluetooth SIG, Inc. The Auracast™ word mark and logos are trademarks owned by Bluetooth SIG, Inc. Any use of such marks by Ultimea Technology (Shenzhen) Limited, is under license. Other trademarks and trade names are those of their respective owners.

## EU Declaration of Conformity

We (Manufacturer is responsible for this declaration) Ultimea Technology (Shenzhen) Limited  
20th Floor, Building 4, Tianan Cloud Park, Bantian St., Longgang District Shenzhen, China 518000  
Declare under our sole responsibility that the product

Trade Mark: ULTIMEA

Product Name: Active Subwoofer

Model No.: UW220

The product to which this declaration relates is in conformity with the essential requirements set out in the Council Directive on the Approximation of the laws of the Member States relating to the Radio Equipment Directive (2014/53/EU), the Restriction of Hazardous Substances Directive (2011/65/EU), the Electromagnetic Compatibility Directive (2014/30/EU), and the Low Voltage Directive (2014/35/EU). The product is responsible for affixing the CE marking, and the following standards were applied:

EN 55032:2015/A1:2020

EN 55035:2017/A11:2020

EN IEC 61000-3-2:2019/A2:2024

EN 61000-3-3:2013/A2:2021

ETSI EN 301 489-1 V2.2.3 (2019-11)

ETSI EN 301 489-17 V3.2.4 (2020-09)

ETSI EN 300 328 V2.2.2 (2019-07)

EN IEC 62311:2020

EN IEC 62368-1:2020+A11:2020

IEC 62321-3-1:2013

IEC 62321-4:2013+A1:2017

IEC 62321-5:2013

IEC 62321-6:2015

IEC 62321-7-1:2015

IEC 62321-7-2:2017

IEC 62321-8:2017

ETSI EN 301 489-3 V2.3.2(2023-01)

ETSI EN 300 440 V2.2.1(2018-07)

Full Name: Yoyo.Yu

Position: Approbation Manager

Signature: 

Place/Date: Shenzhen,  
China / January 2026

EC	REP	Ultimea GmbH Buchenring 57, 22359 Hamburg, Germany
----	-----	---

UK	REP	EVATOST CONSULTING LTD Office 101 32 Threadneedle Street, London, United Kingdom, EC2R 8AY
----	-----	--

@Ultimea Inc. All rights reserved, registered in the United States and other countries.  
801 S. Dupont Ave., Ste G, Ontario, CA, 91761, USA

Made in China

Manufacturer: Ultimea Technology (Shenzhen) Limited

Address: 20th Floor, Building 4, Tianan Cloud Park, Bantian St., Longgang District, Shenzhen, China 518000

Manufacturer Contact Information:

+1 888-598-8875 (US)

Mon-Fri 9am-5pm (PST)

✉ support@ultimea.com



+49 89-628-25828 (EU)

Mon-Fri 9am-5pm (CET)

🌐 support.ultimea.com

If you need our support, kindly reach out to our service team.

We are always glad to help.



## Warranty Extension Plan

Regardless of where you purchased your Ultimea product, you can easily opt for this extended warranty.

Scan to check out our extended warranty options.



Download Ultimea App



Search for "ULTIMEA" on social media.

